

Dec 16, 2016 - 9:56am - AC\_936\_AB.dwg  
H:\Bozeman High School\Building Plan Book\

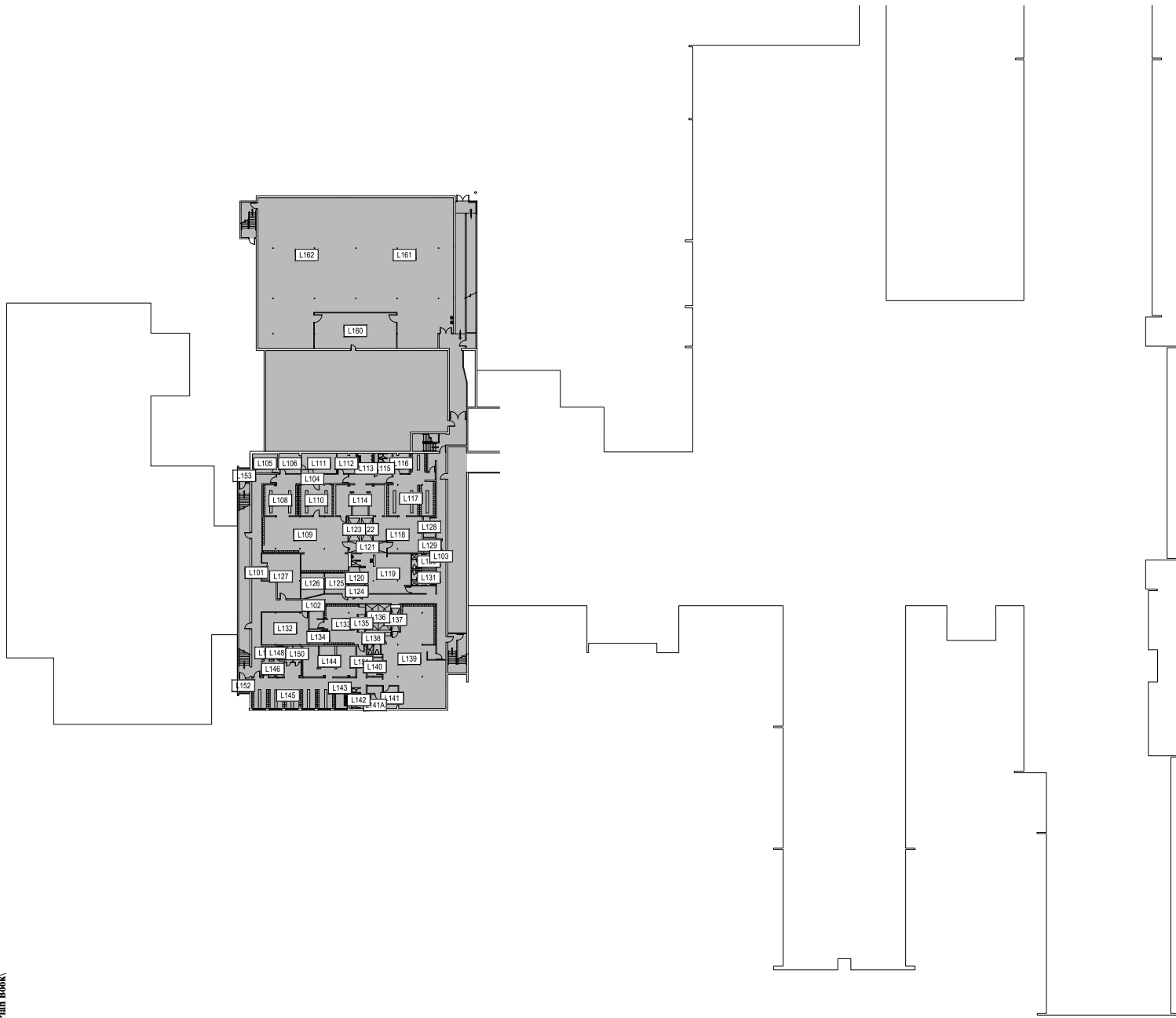

LEASED PROPERTY  
GALLATIN COLLEGE

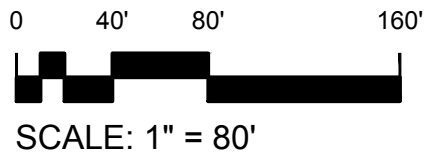

1

BASEMENT LEVEL - S  
BOZEMAN HIGH SCHOOL



**M** MONTANA  
STATE UNIVERSITY  
CAMPUS PLANNING,  
DESIGN & CONSTRUCTION  
BOZEMAN, MONTANA  
PHONE: 406.994.5413 FAX: 406.994.5665

INDEX #	144
BUILDING #	936

Dec 16, 2016 - 9:56am - AC\_936\_AB.dwg  
H:\Bozeman High School\Building Plan Book\

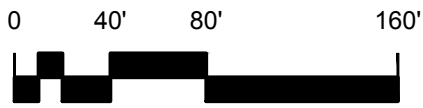
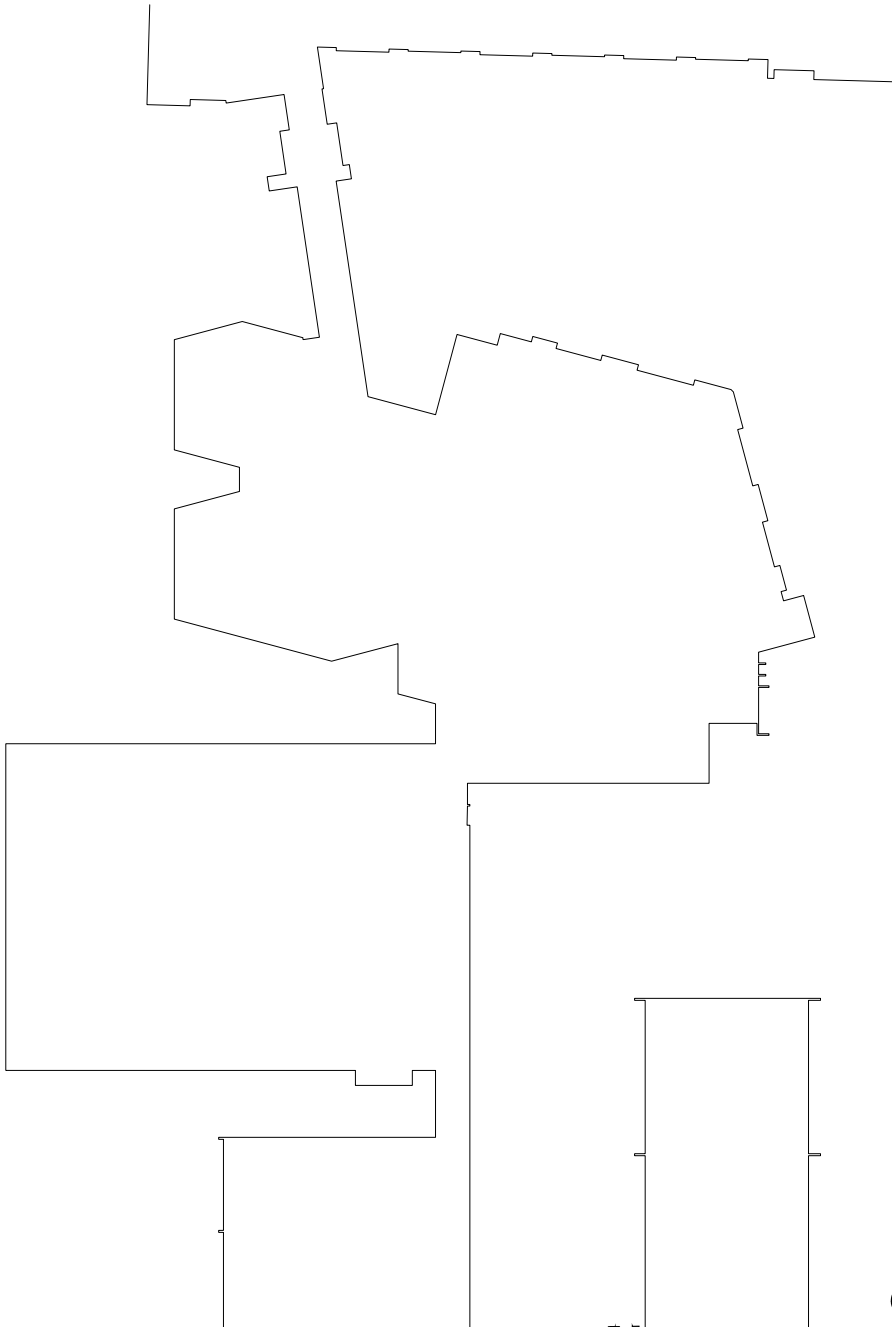

SCALE: 1" = 80'

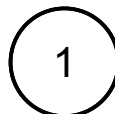

**BASEMENT LEVEL - C**

BOZEMAN HIGH SCHOOL



LEASED PROPERTY  
GALLATIN COLLEGE

**M** MONTANA  
STATE UNIVERSITY  
CAMPUS PLANNING,  
DESIGN & CONSTRUCTION  
BOZEMAN, MONTANA  
PHONE: 406.994.5413 FAX: 406.994.5665

INDEX #

**144**

BUILDING #

**936**

Dec 16, 2016 - 9:56am - AC\_936\_AB.dwg  
H:\Bozeman High School\Building Plan Book\

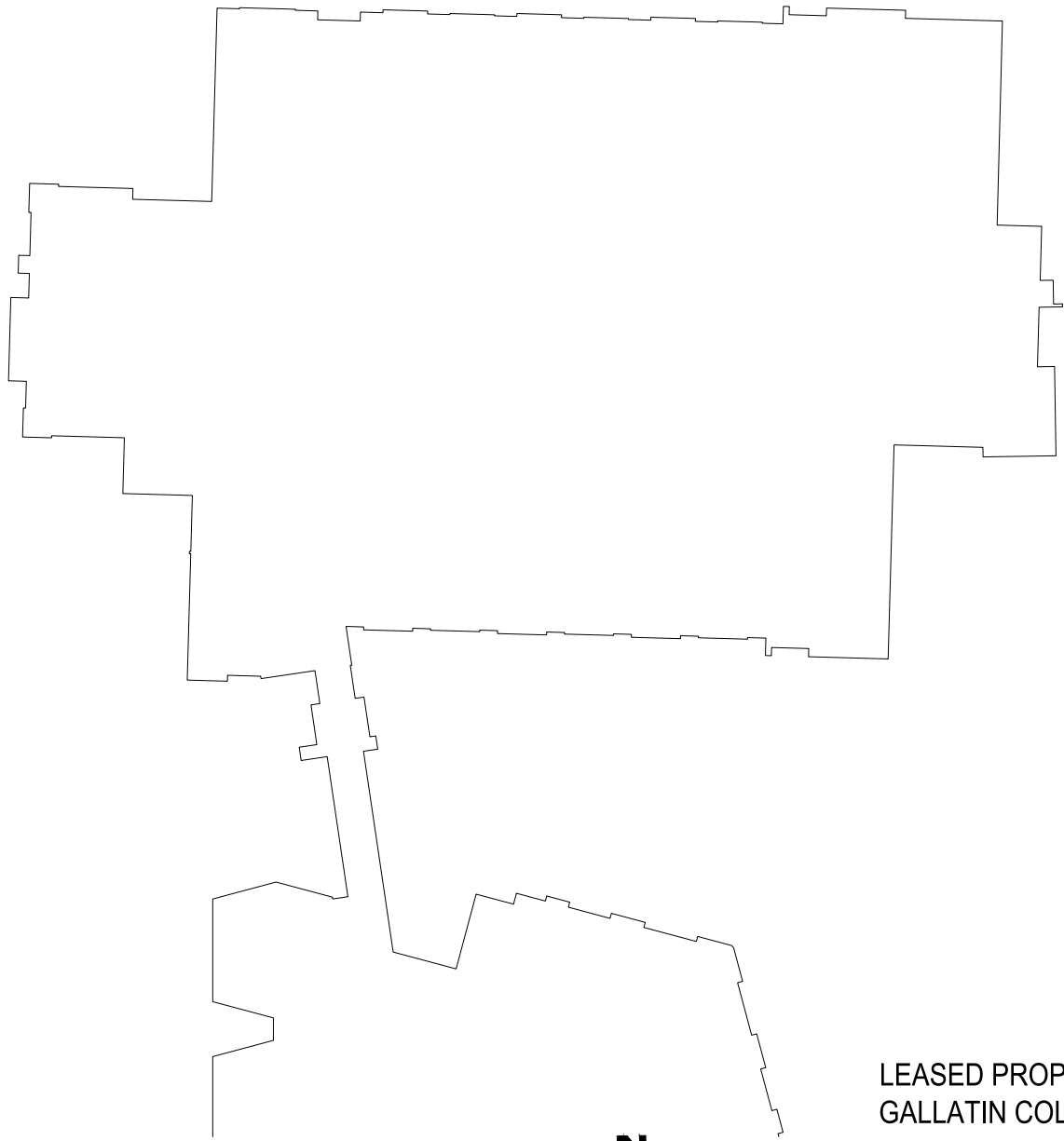

LEASED PROPERTY  
GALLATIN COLLEGE

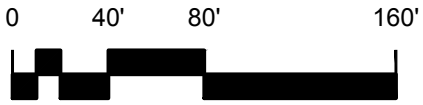

SCALE: 1" = 80'

1

BASEMENT LEVEL - N

BOZEMAN HIGH SCHOOL



**M** MONTANA  
STATE UNIVERSITY  
CAMPUS PLANNING,  
DESIGN & CONSTRUCTION  
BOZEMAN, MONTANA  
PHONE: 406.994.5413 FAX: 406.994.5665

INDEX #	<b>144</b>
BUILDING #	<b>936</b>

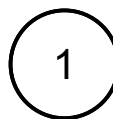
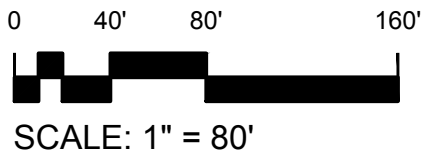
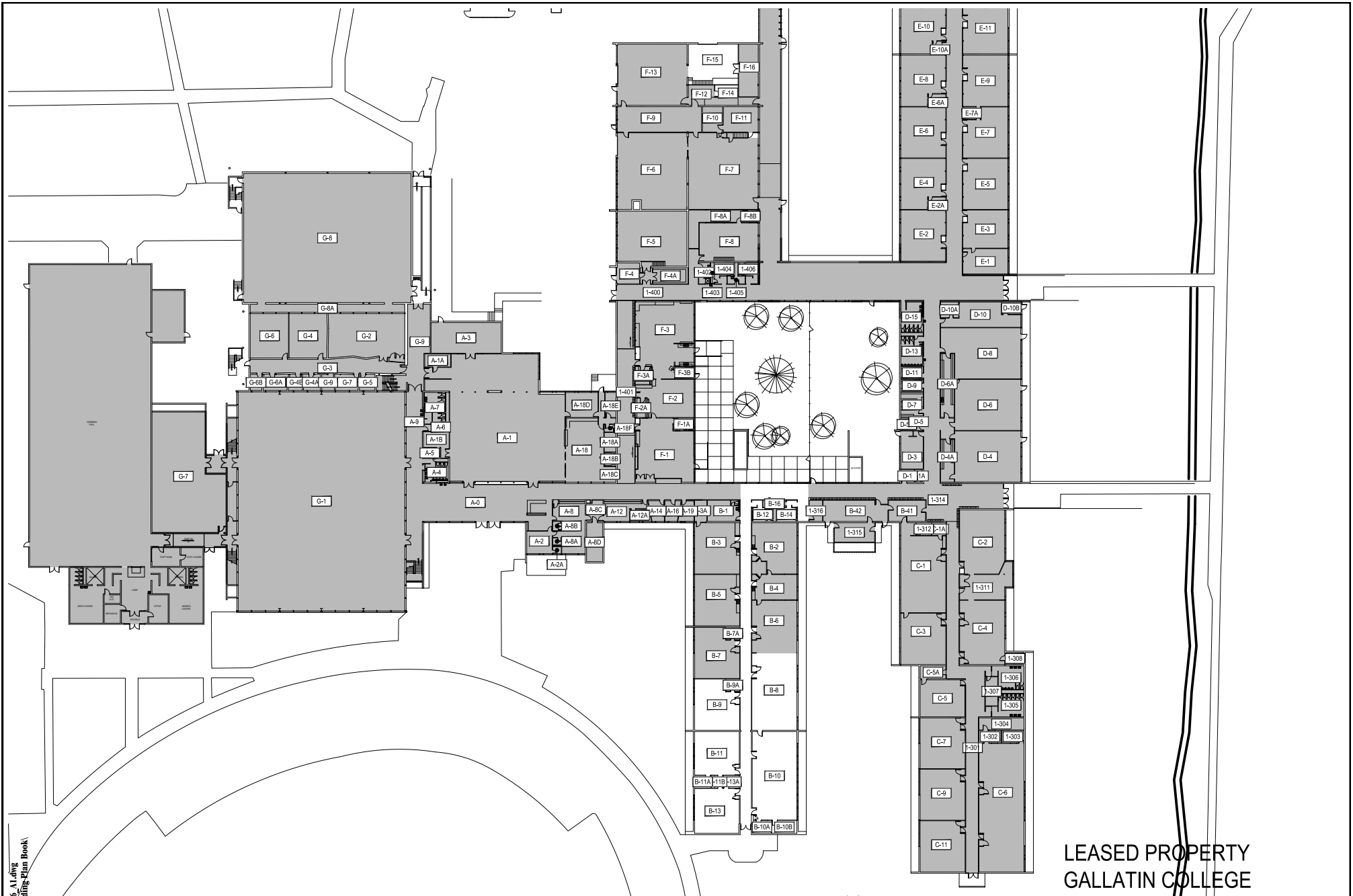

**FIRST LEVEL - S**  
BOZEMAN HIGH SCHOOL



LEASED PROPERTY  
GALLATIN COLLEGE

**M MONTANA STATE UNIVERSITY**  
CAMPUS PLANNING,  
DESIGN & CONSTRUCTION  
BOZEMAN, MONTANA  
PHONE: 406.994.5413 FAX: 406.994.5665

INDEX #	<b>144</b>
BUILDING #	<b>936</b>

Dec 16, 2016 - 9:56am - AC\_936\_A1.dwg  
H:\Bozeman High School\Building Plan Book

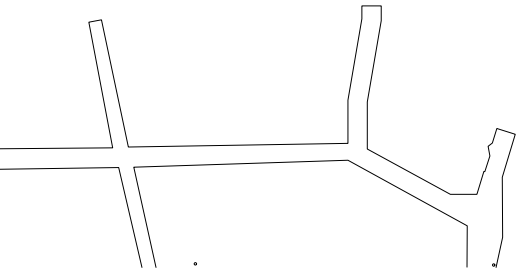
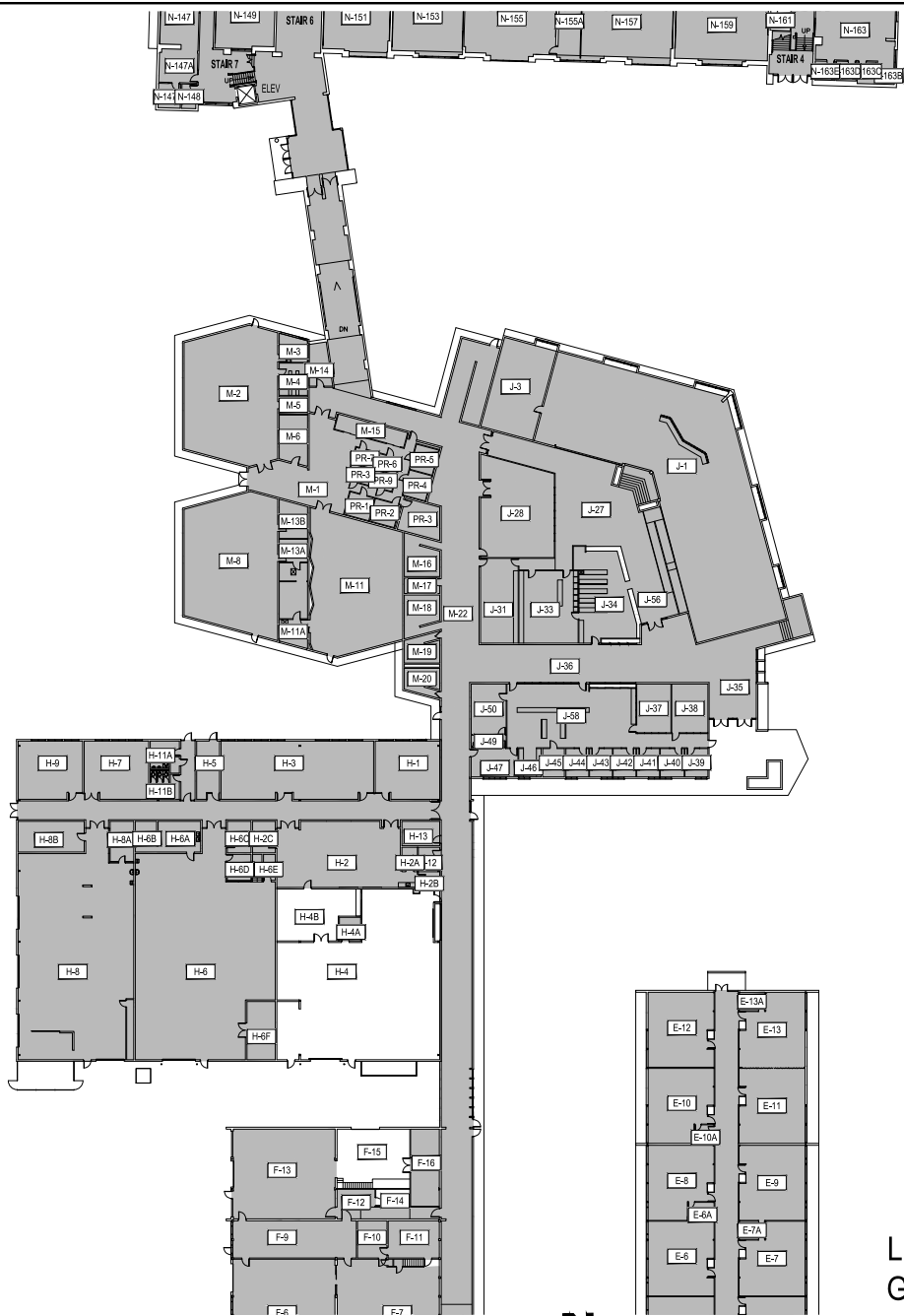

0 40' 80' 160'  
SCALE: 1" = 80'

1

**FIRST LEVEL - C**  
BOZEMAN HIGH SCHOOL



LEASED PROPERTY  
GALLATIN COLLEGE

**M** MONTANA STATE UNIVERSITY  
CAMPUS PLANNING,  
DESIGN & CONSTRUCTION  
BOZEMAN, MONTANA  
PHONE: 406.994.5413 FAX: 406.994.5665

INDEX #  
**144**  
BUILDING #  
**936**

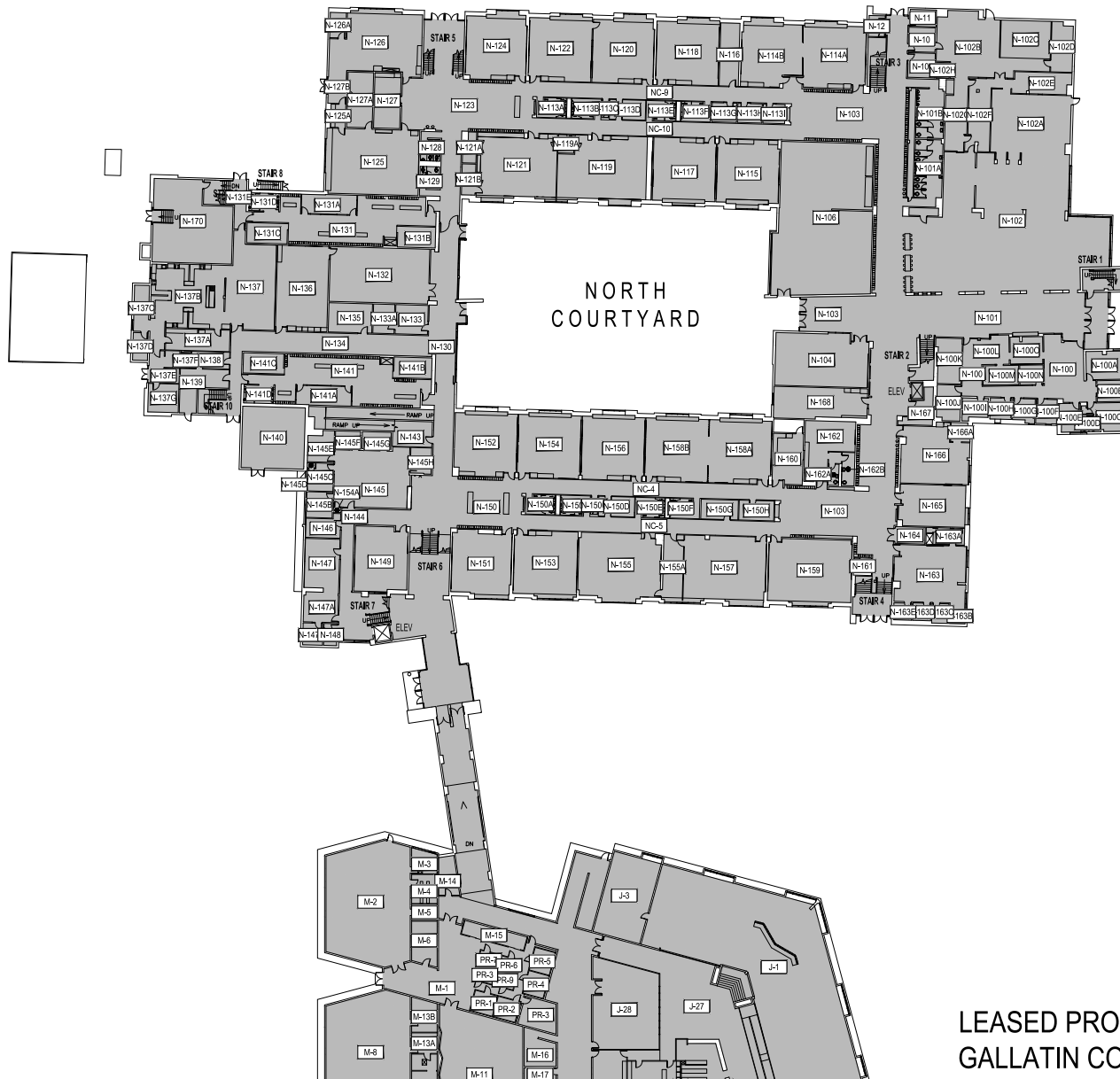

LEASED PROPERTY  
GALLATIN COLLEGE

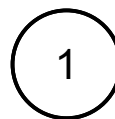
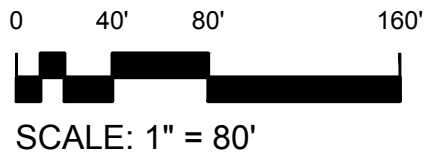

FIRST LEVEL - N  
BOZEMAN HIGH SCHOOL



**M** MONTANA STATE UNIVERSITY  
CAMPUS PLANNING,  
DESIGN & CONSTRUCTION  
BOZEMAN, MONTANA  
PHONE: 406.994.5413 FAX: 406.994.5665

INDEX #	144
BUILDING #	936

Dec 16, 2016 - 9:56am - AC\_936\_A2.dwg  
H:\Bozeman High School\Building Plan Book\

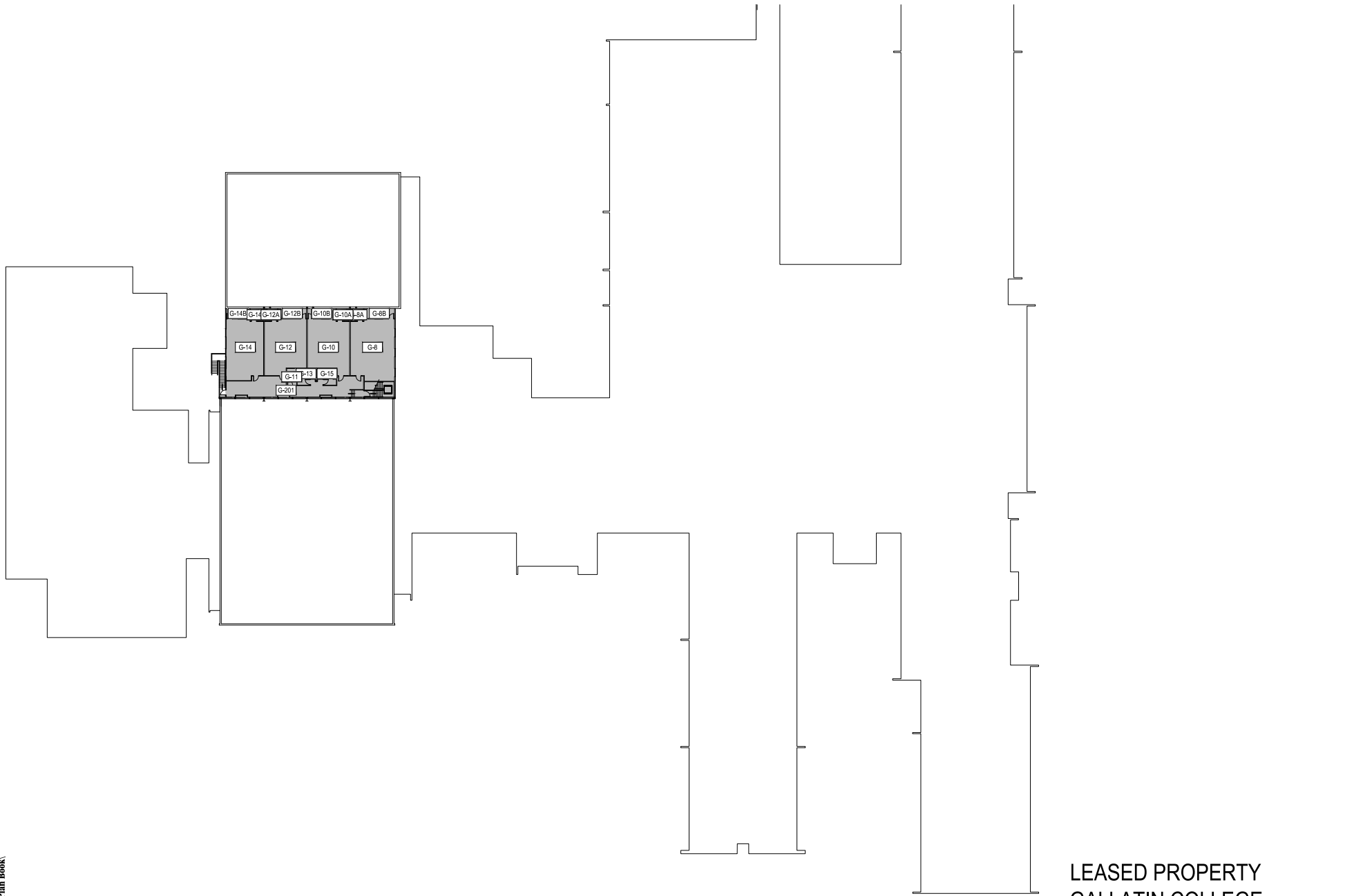

LEASED PROPERTY  
GALLATIN COLLEGE

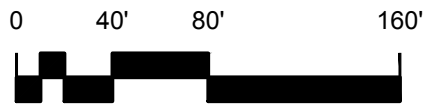

SCALE: 1" = 80'

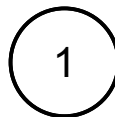

**SECOND LEVEL - S**  
BOZEMAN HIGH SCHOOL



**M** MONTANA  
STATE UNIVERSITY  
CAMPUS PLANNING,  
DESIGN & CONSTRUCTION  
BOZEMAN, MONTANA  
PHONE: 406.994.5413 FAX: 406.994.5665

INDEX #	<b>144</b>
BUILDING #	<b>936</b>



SCALE: 1" = 80'

1

SECOND LEVEL - C

BOZEMAN HIGH SCHOOL

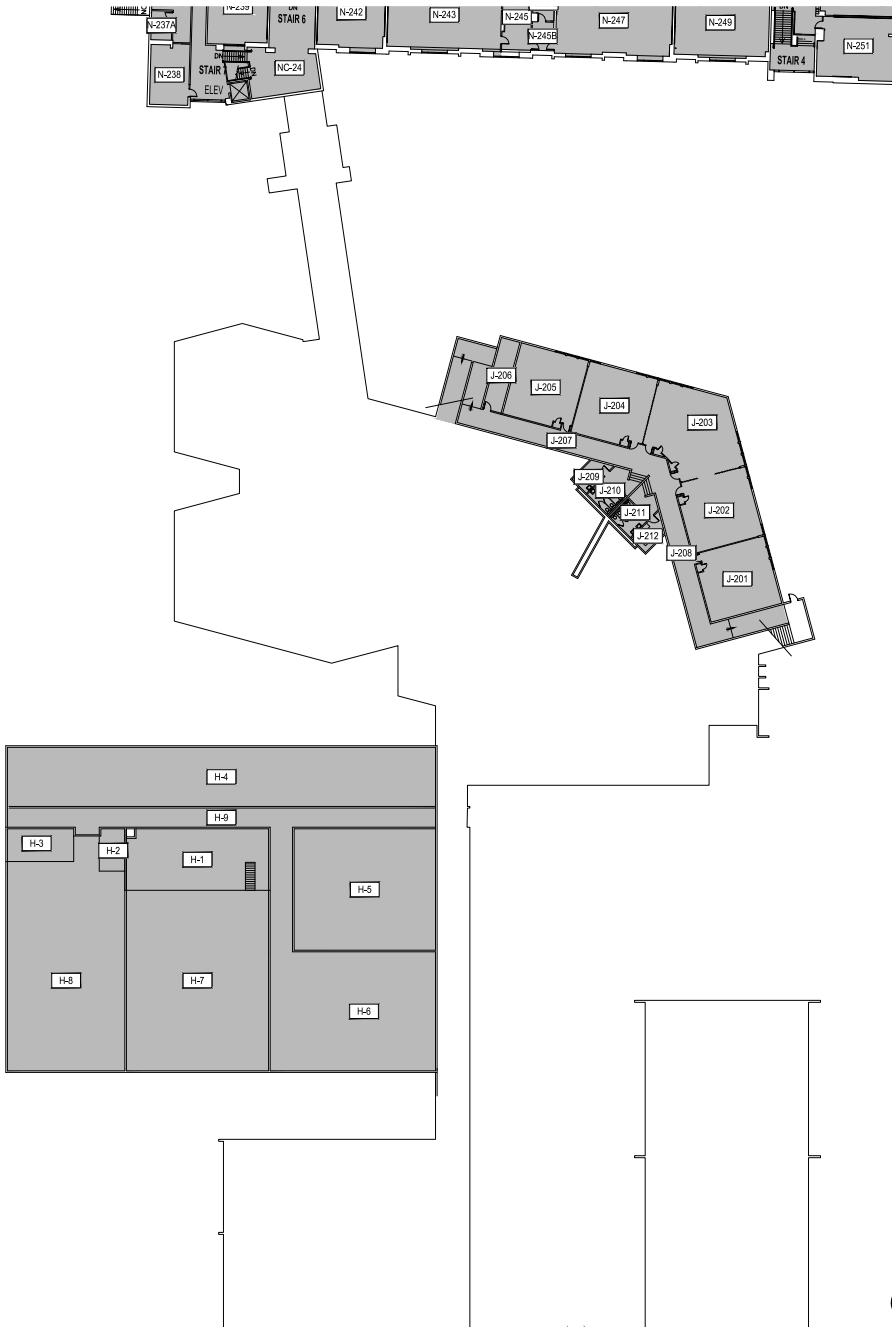

LEASED PROPERTY  
GALLATIN COLLEGE

**M** MONTANA STATE UNIVERSITY  
CAMPUS PLANNING,  
DESIGN & CONSTRUCTION  
BOZEMAN, MONTANA  
PHONE: 406.994.5413 FAX: 406.994.5665

INDEX #	144
BUILDING #	936



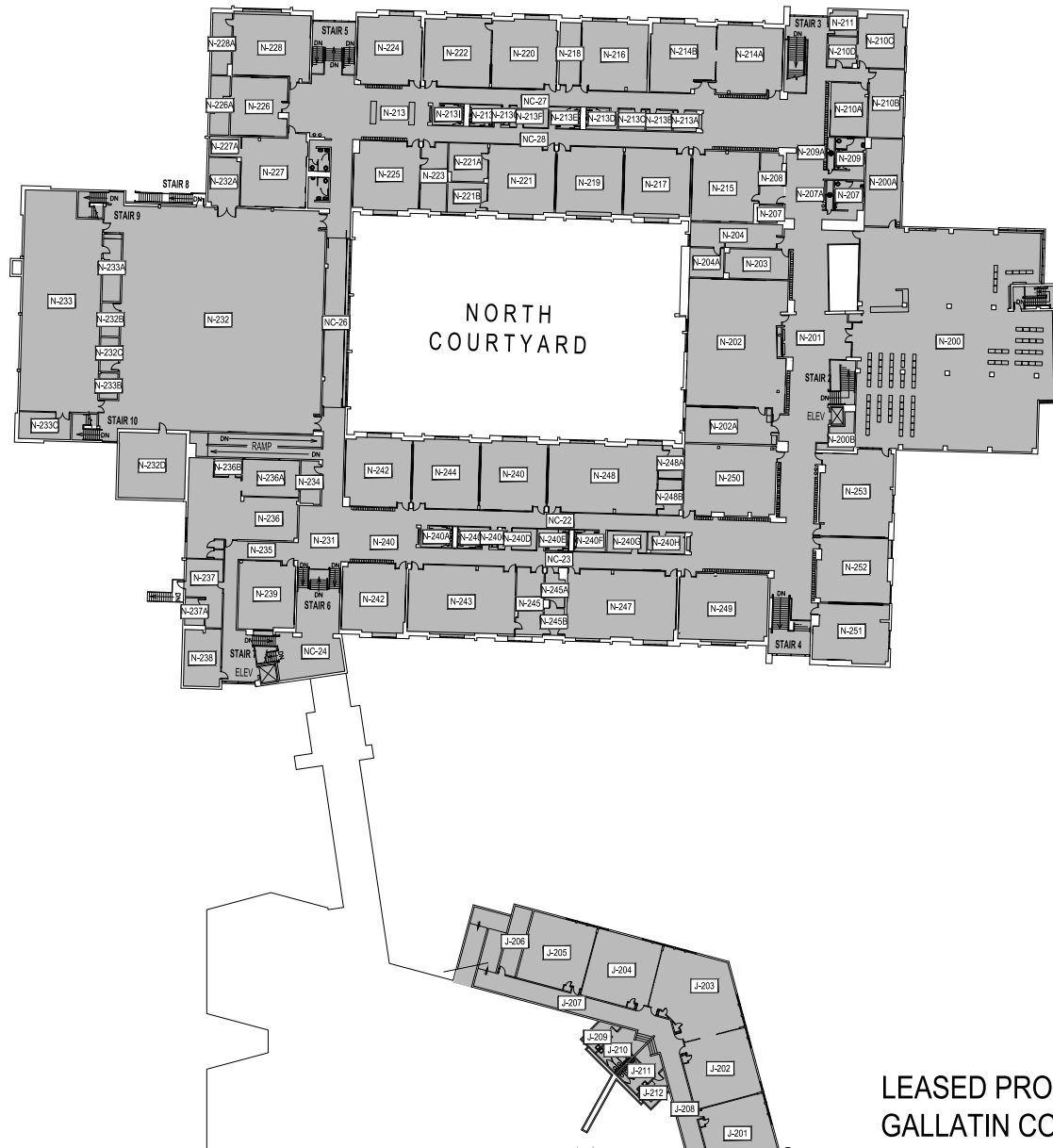

LEASED PROPERTY  
 GALLATIN COLLEGE

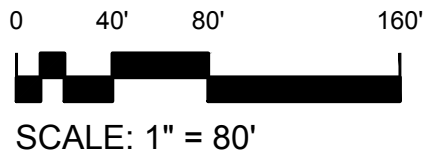

1
**SECOND LEVEL - N**  
 BOZEMAN HIGH SCHOOL



**MONTANA STATE UNIVERSITY**  
 CAMPUS PLANNING,  
 DESIGN & CONSTRUCTION  
 BOZEMAN, MONTANA  
 PHONE: 406.994.5413 FAX: 406.994.5665

INDEX #	<b>144</b>
BUILDING #	<b>936</b>