

Nov 14, 2013 - 3:04pm - 5671209_A1.dwg
H:\Family Housing\Gopher Street\Building Plan - Book Copy\

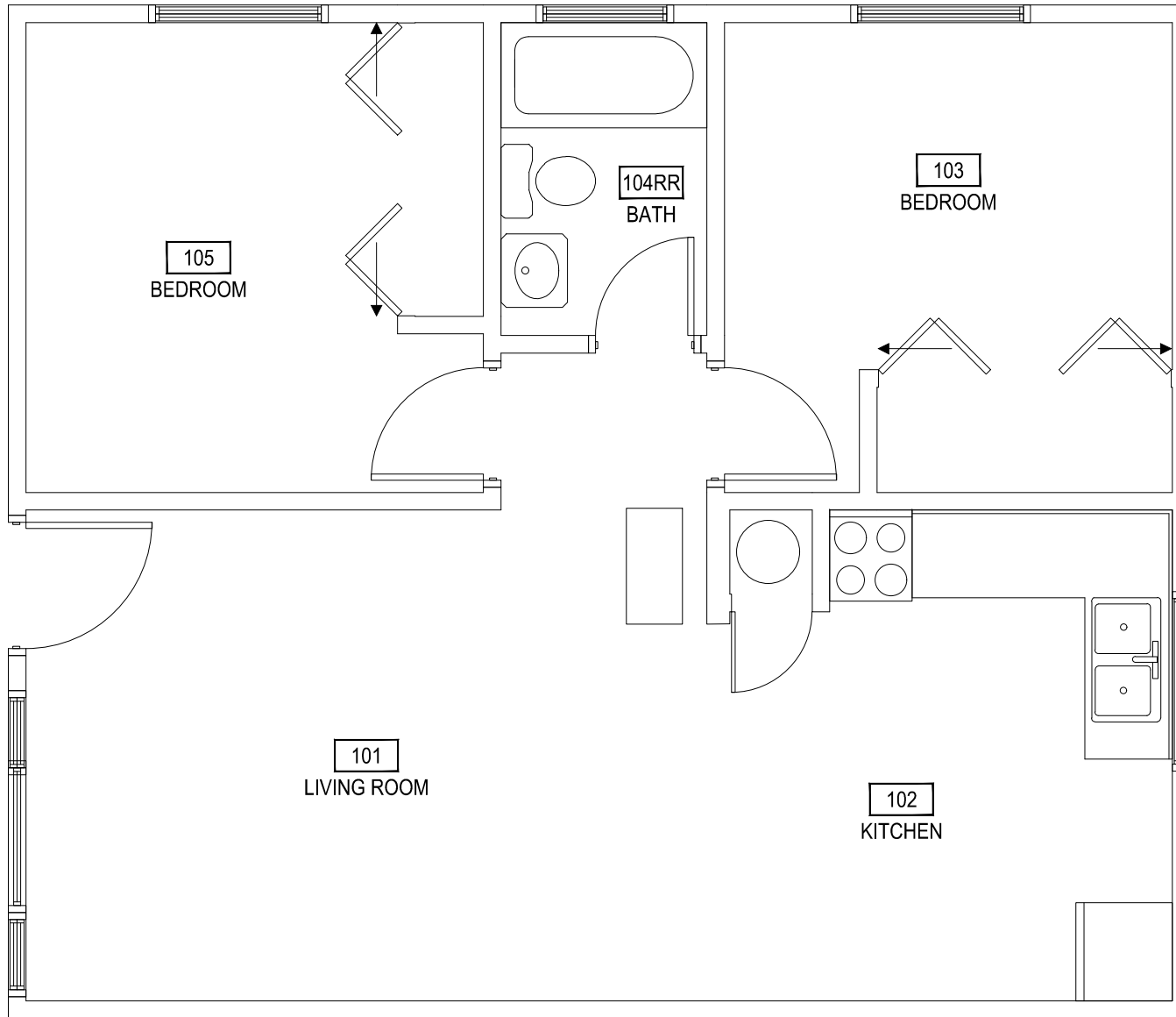

SCALE: 1/4" = 1'-0"

1 FIRST LEVEL
GOPHER STREET - 1209

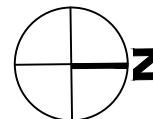

M MONTANA
STATE UNIVERSITY
FACILITIES PLANNING,
DESIGN & CONSTRUCTION
BOZEMAN, MONTANA
PHONE: 406.994.4131 FAX: 406.994.6572

INDEX #
39
BUILDING #
5671209

Nov 14, 2013 - 3:04pm - 5671209_AR.dwg
H:\Family Housing\Gopher Street\Building Plan - Book Copy\

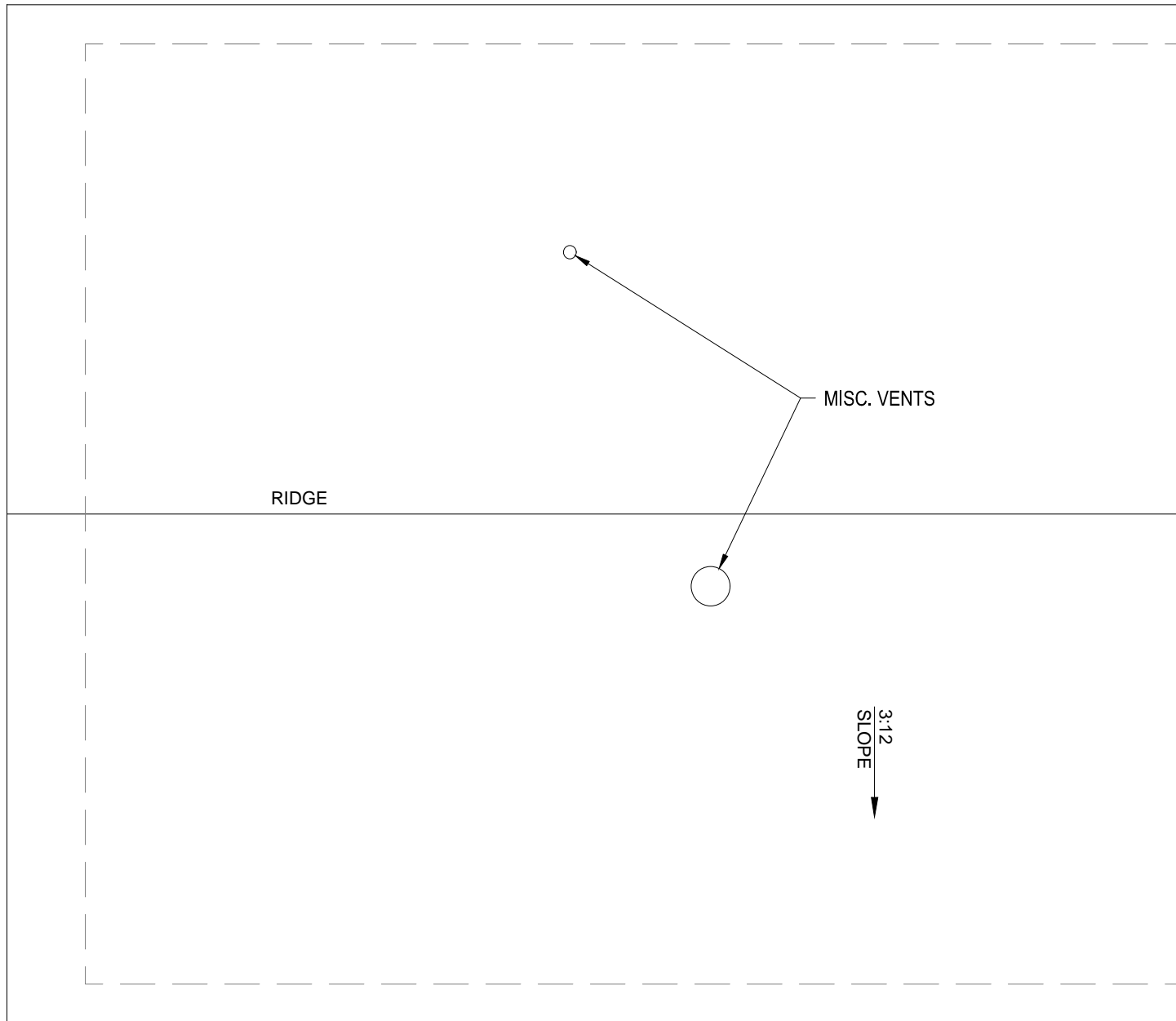

SCALE: 1/4" = 1'-0"

1 ROOF LEVEL
GOPHER STREET - 1209

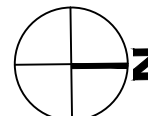

M MONTANA
STATE UNIVERSITY
FACILITIES PLANNING,
DESIGN & CONSTRUCTION
BOZEMAN, MONTANA
PHONE: 406.994.4131 FAX: 406.994.6572

INDEX #
39
BUILDING #
5671209