

Nov 14, 2013 - 3:25pm - 5661212_A1.dwg
H:\Family Housing\15th Avenue\Building Plan - Book Copy\A

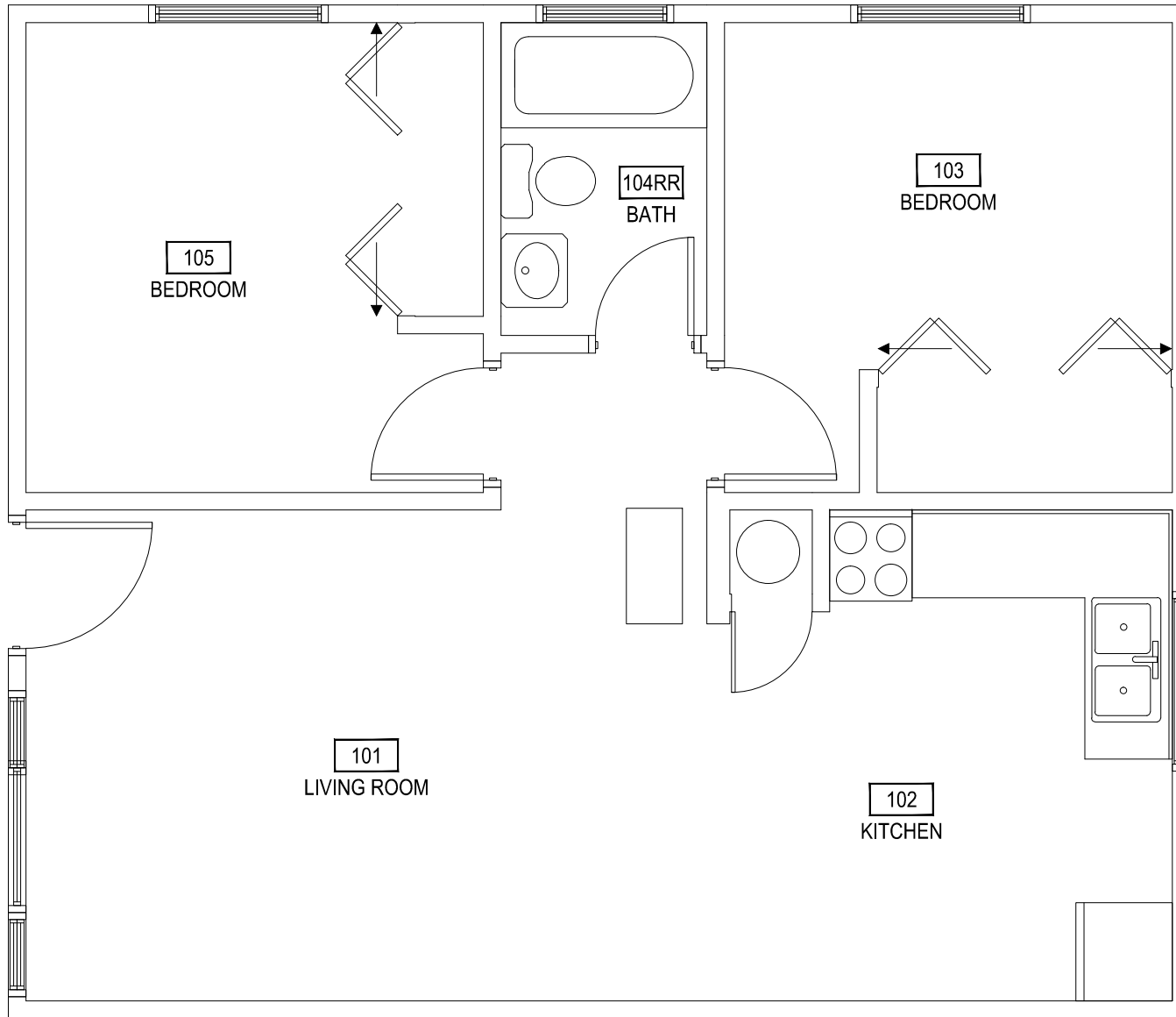

SCALE: 1/4" = 1'-0"

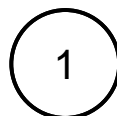

FIRST LEVEL

S 15TH AVENUE - 1212



M MONTANA STATE UNIVERSITY
FACILITIES PLANNING,
DESIGN & CONSTRUCTION
BOZEMAN, MONTANA
PHONE: 406.994.4131 FAX: 406.994.6572

INDEX #	39
BUILDING #	5661212

Nov 14, 2013 - 3:25pm - 5661212_AR.dwg
H:\Family Housing\15th Avenue\Building Plan - Book Copy\

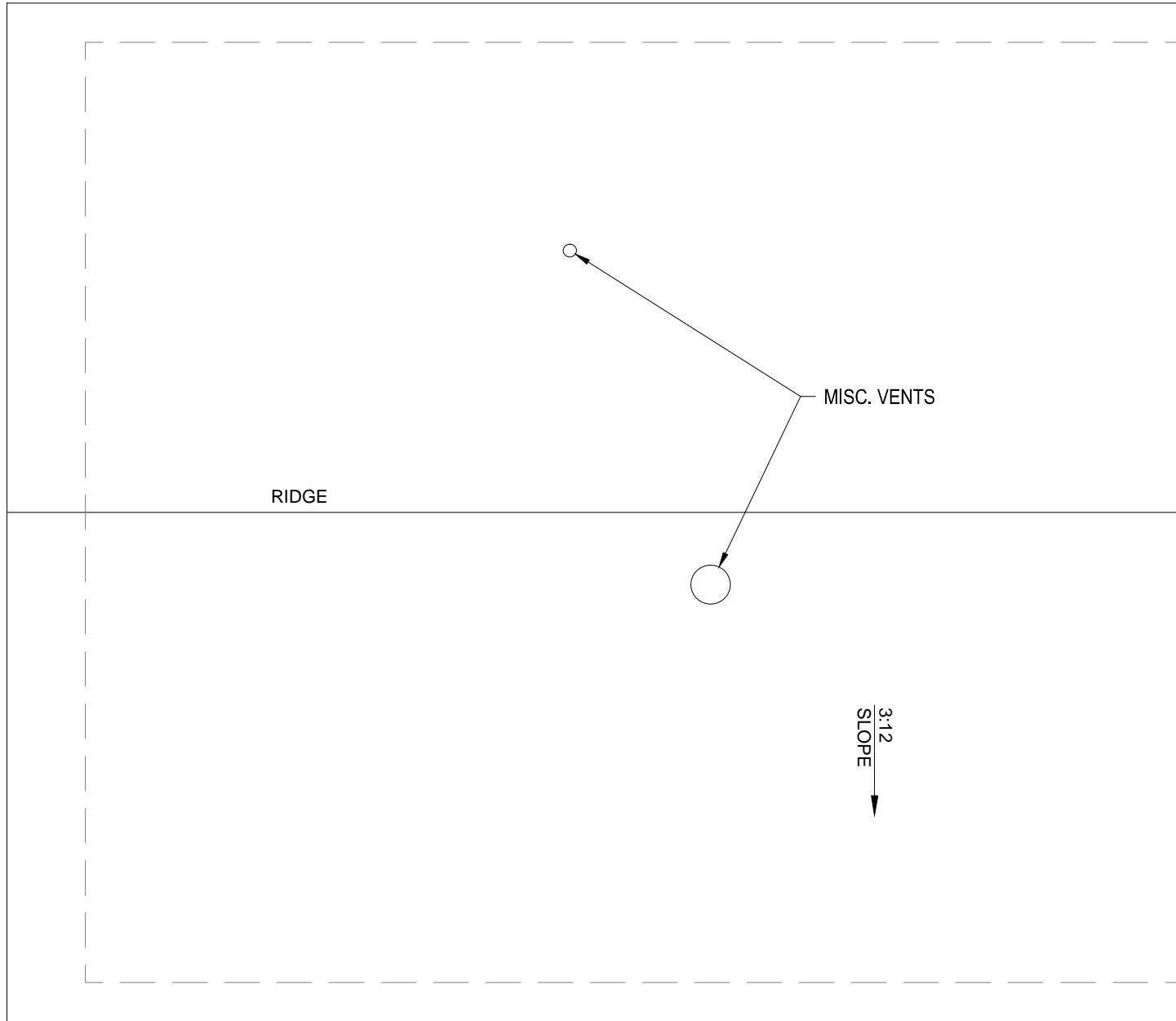

SCALE: 1/4" = 1'-0"

1 ROOF LEVEL
S 15TH AVENUE - 1212



M MONTANA
STATE UNIVERSITY
FACILITIES PLANNING,
DESIGN & CONSTRUCTION
BOZEMAN, MONTANA
PHONE: 406.994.4131 FAX: 406.994.6572

INDEX #
39
BUILDING #
5661212