

Nov 14, 2013 - 3:20pm - 5661002_A1.dwg
H:\Family Housing\15th Avenue\Building Plan - Book Copy\A

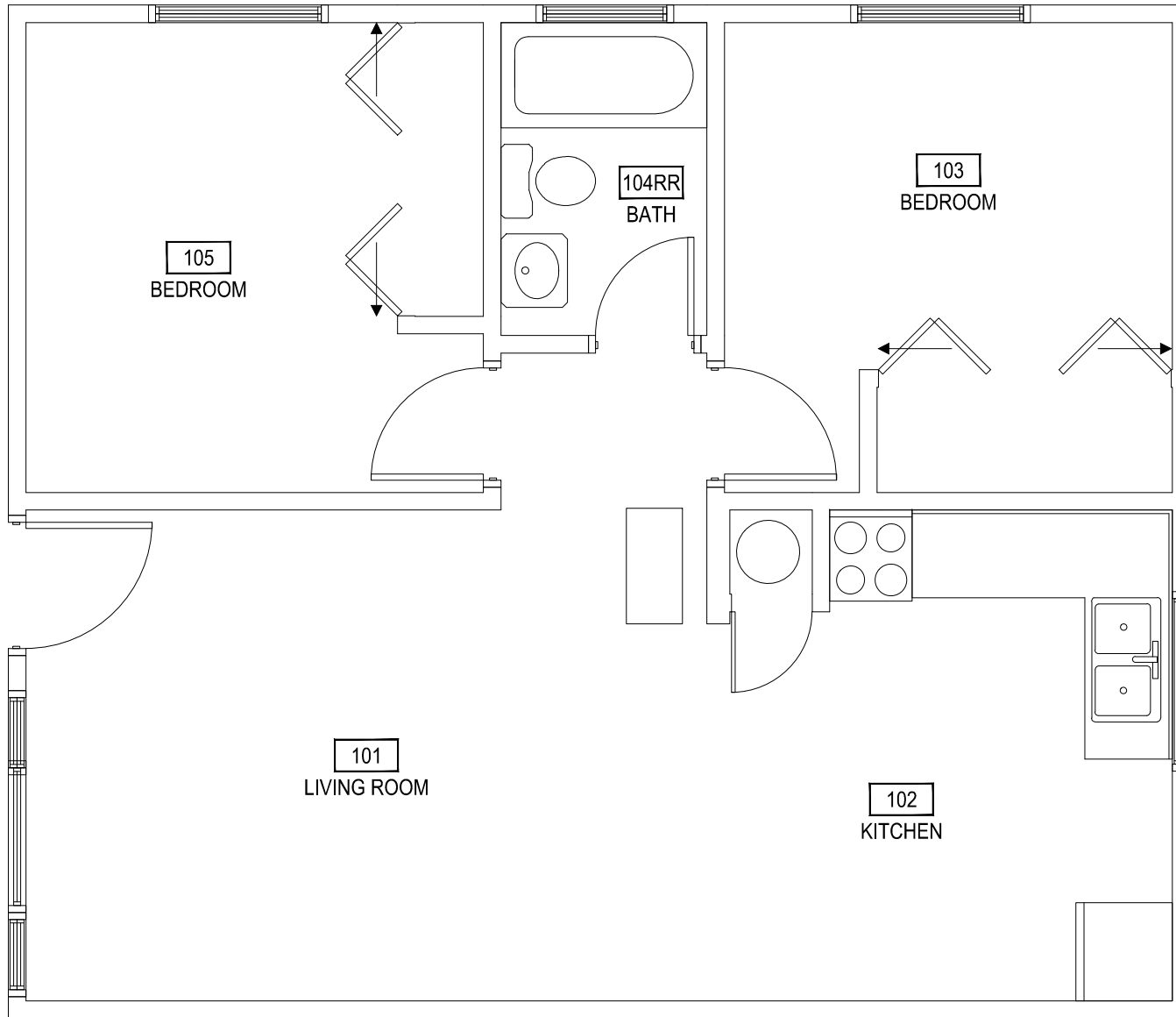

SCALE: 1/4" = 1'-0"

1 FIRST LEVEL
S 15TH AVENUE - 1002

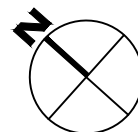

M MONTANA
STATE UNIVERSITY
FACILITIES PLANNING,
DESIGN & CONSTRUCTION
BOZEMAN, MONTANA
PHONE: 406.994.4131 FAX: 406.994.6572

INDEX #
39
BUILDING #
5661002

Nov 14, 2013 - 3:20pm - 5661002_AR.dwg
H:\Family Housing\15th Avenue\Building Plan - Book Copy\

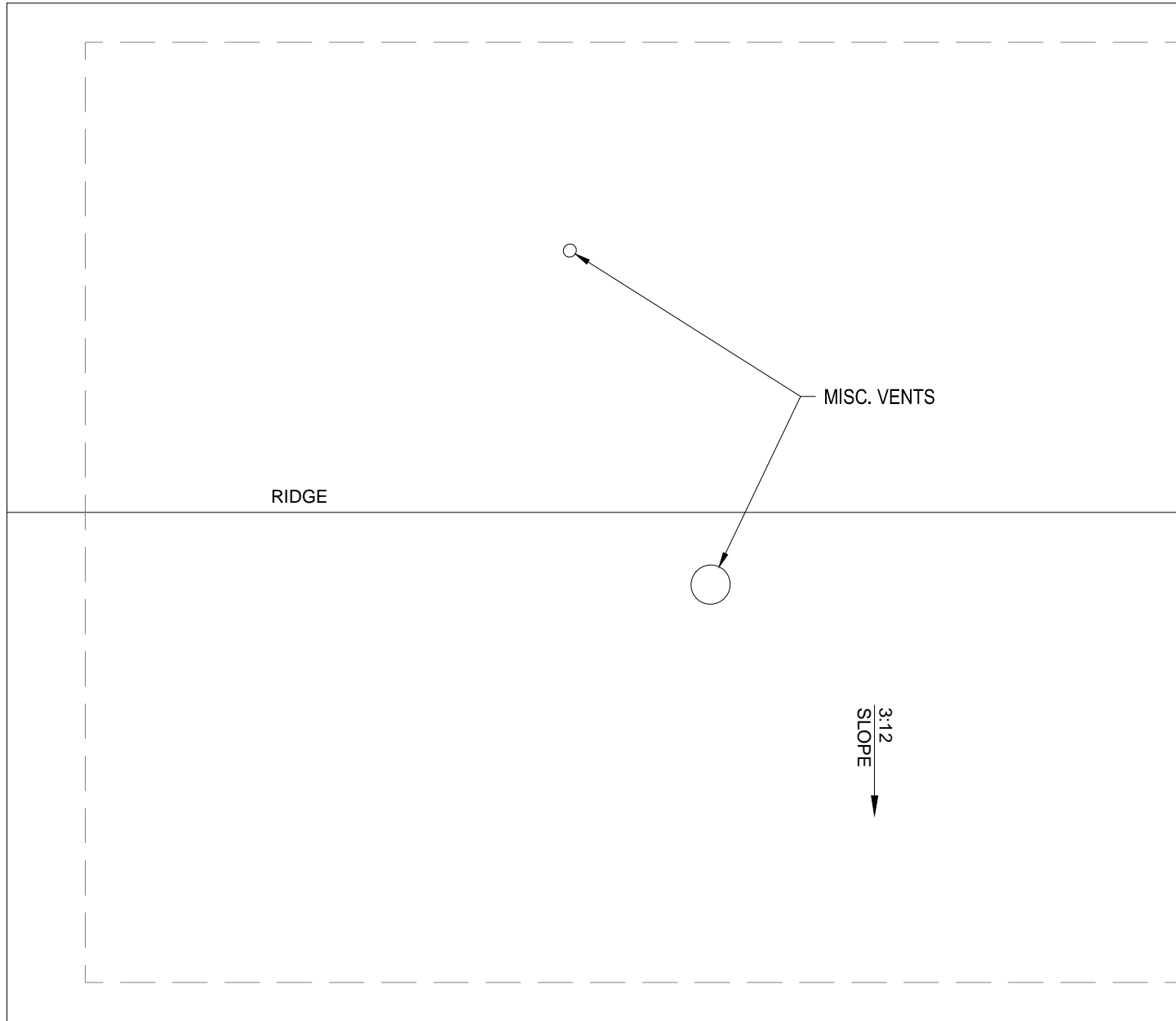

SCALE: 1/4" = 1'-0"

1 ROOF LEVEL
S 15TH AVENUE - 1002

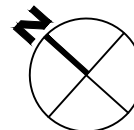

M MONTANA
STATE UNIVERSITY
FACILITIES PLANNING,
DESIGN & CONSTRUCTION
BOZEMAN, MONTANA
PHONE: 406.994.4131 FAX: 406.994.6572

INDEX #
39
BUILDING #
5661002