

Nov 14, 2013 - 11:49am - 5651403_A1.dwg
H:\Family Housing\Garfield Street\Building Plan - Book Copy\

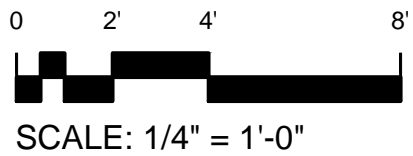

1 **FIRST LEVEL**
GARFIELD STREET - 1403

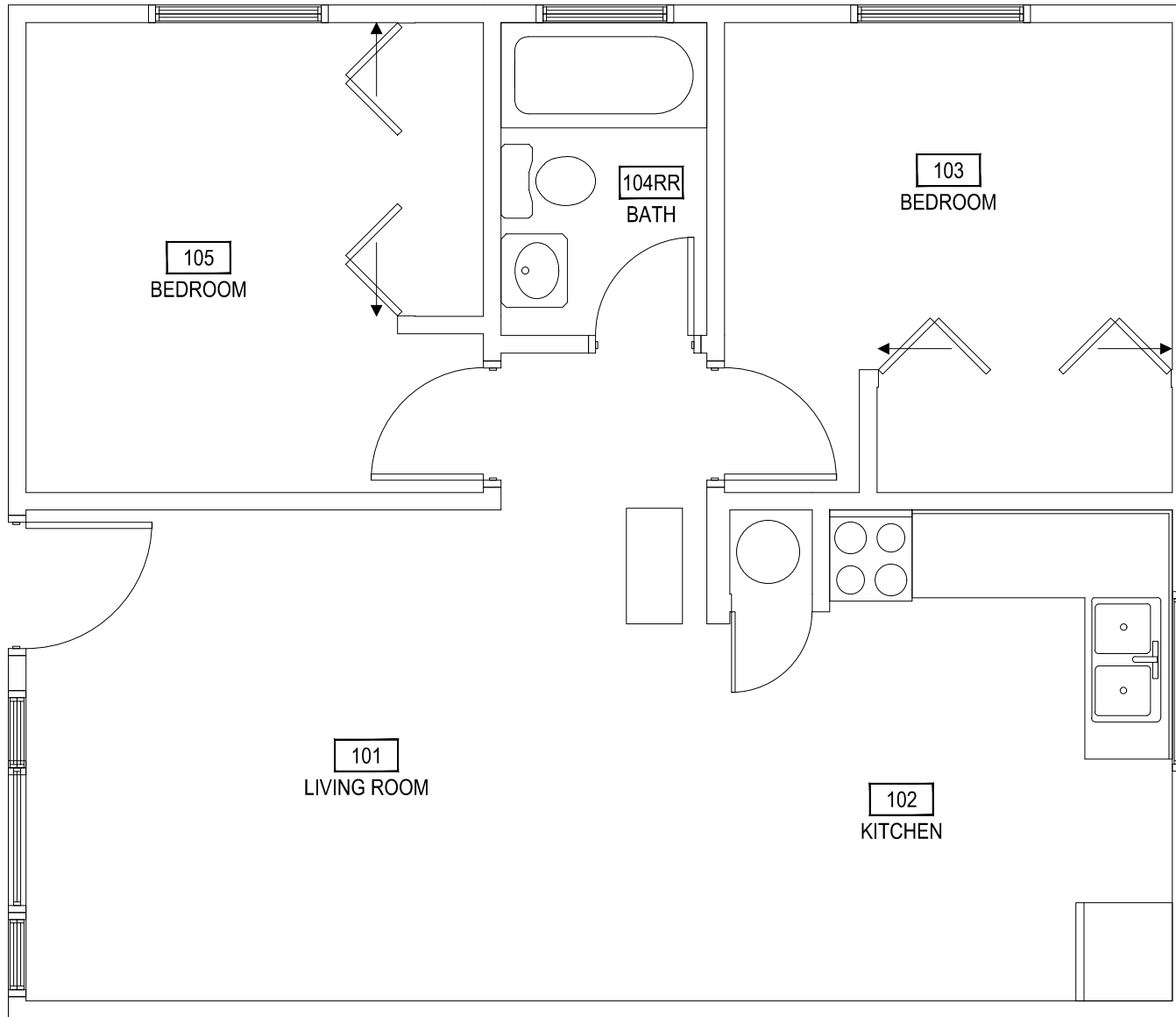
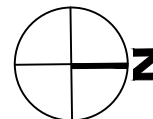

M MONTANA STATE UNIVERSITY
FACILITIES PLANNING,
DESIGN & CONSTRUCTION
BOZEMAN, MONTANA
PHONE: 406.994.4131 FAX: 406.994.6572

INDEX # **39**
BUILDING # **5651403**

Nov 14, 2013 - 11:49am - 5651403_AR.dwg
H:\Family Housing\Garfield Street\Building Plan - Book Copy\

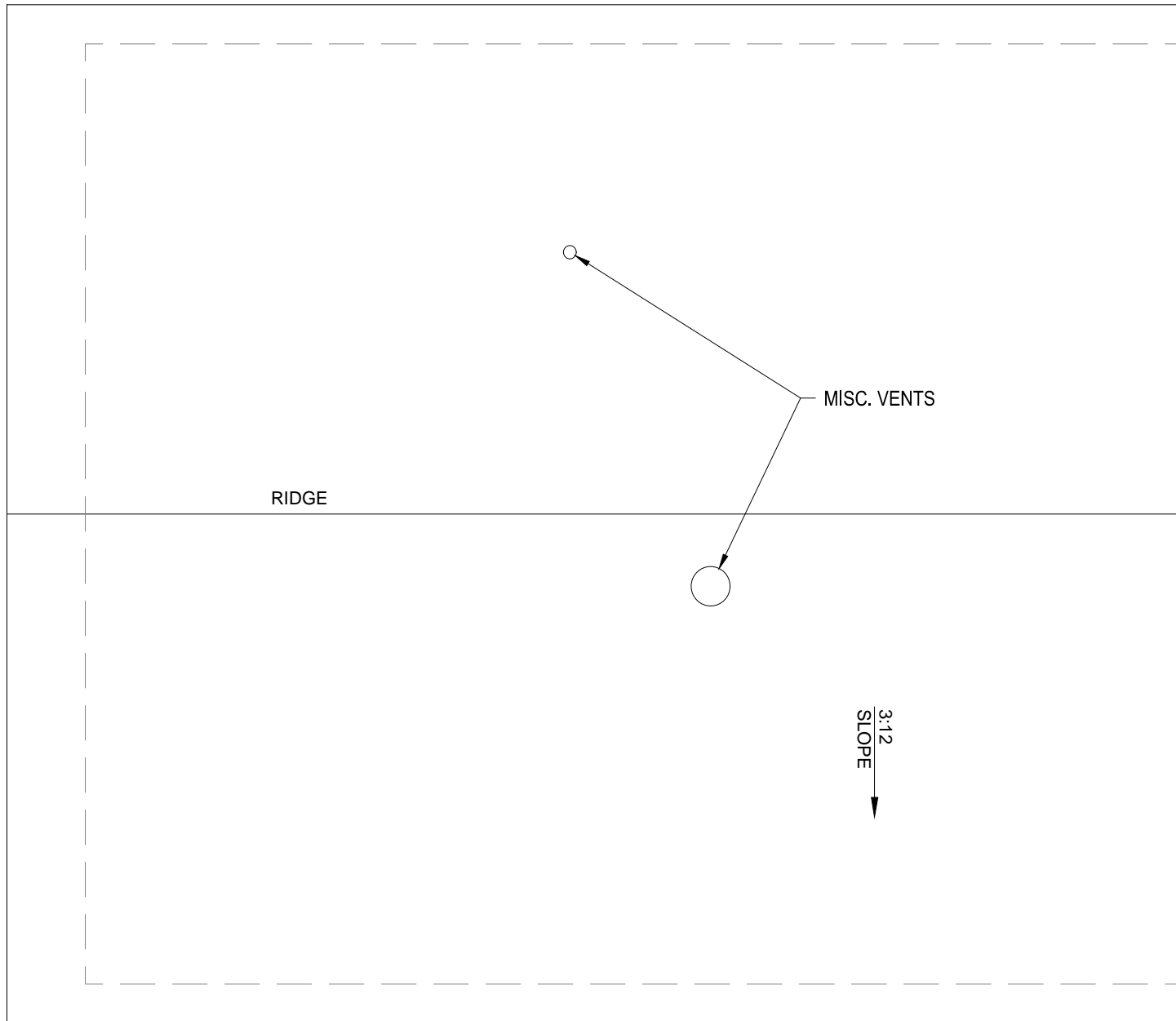

SCALE: 1/4" = 1'-0"

1 ROOF LEVEL
GARFIELD STREET - 1403

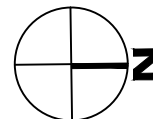

M MONTANA
STATE UNIVERSITY
FACILITIES PLANNING,
DESIGN & CONSTRUCTION
BOZEMAN, MONTANA
PHONE: 406.994.4131 FAX: 406.994.6572

INDEX #
39
BUILDING #
5651403