

PRELIMINARY DATA
AS-BUILT DRAWINGS NOT AVAILABLE

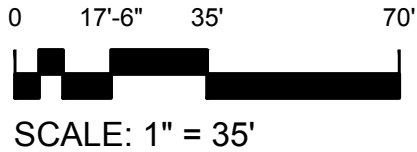

1 FIRST LEVEL
MILLER DINING HALL

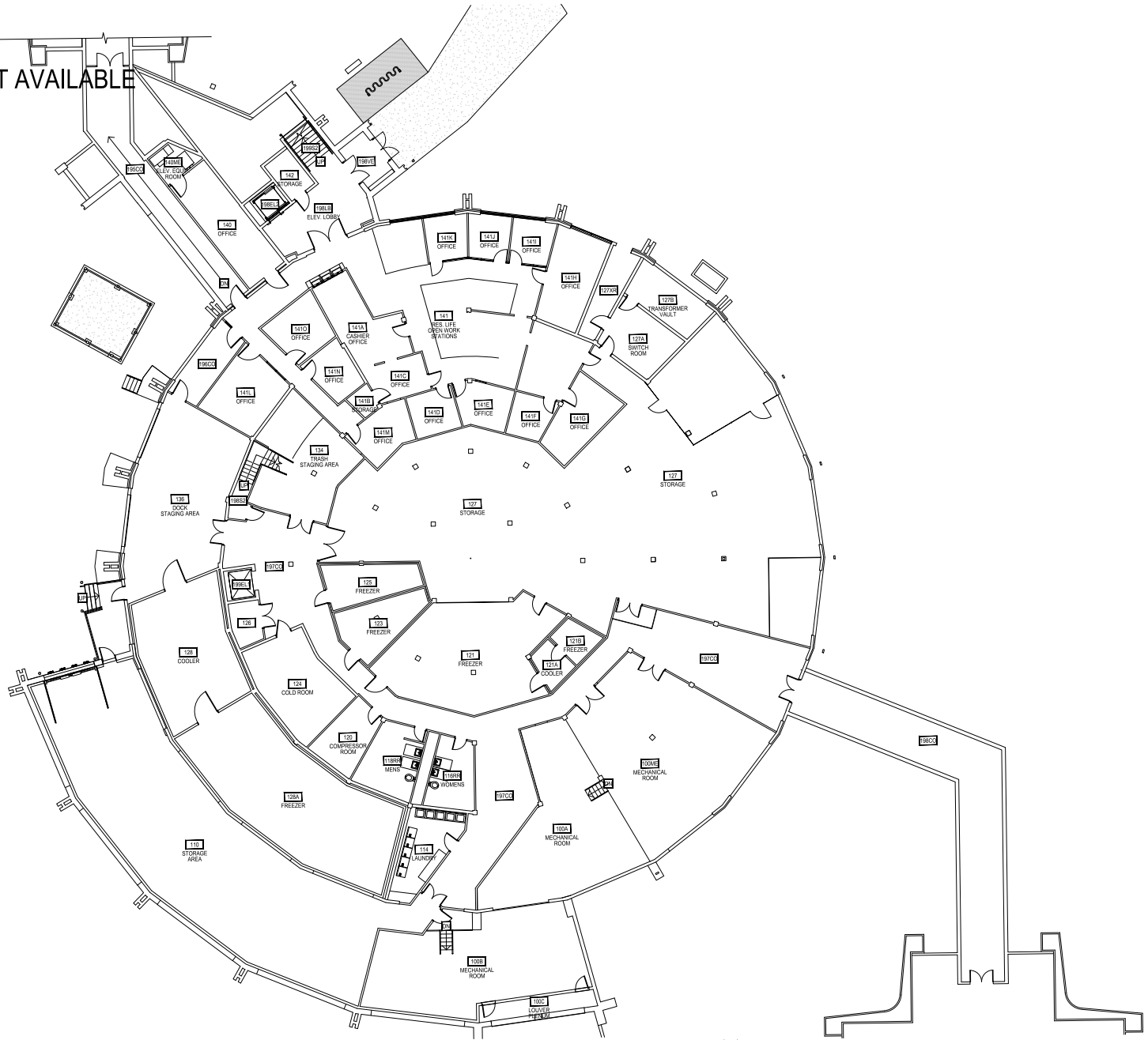

M MONTANA
STATE UNIVERSITY

CAMPUS PLANNING,
DESIGN & CONSTRUCTION
BOZEMAN, MONTANA
PHONE: 406.994.5413 FAX: 406.994.5665

INDEX #	43
BUILDING #	341

PRELIMINARY DATA
AS-BUILT DRAWINGS NOT AVAILABLE

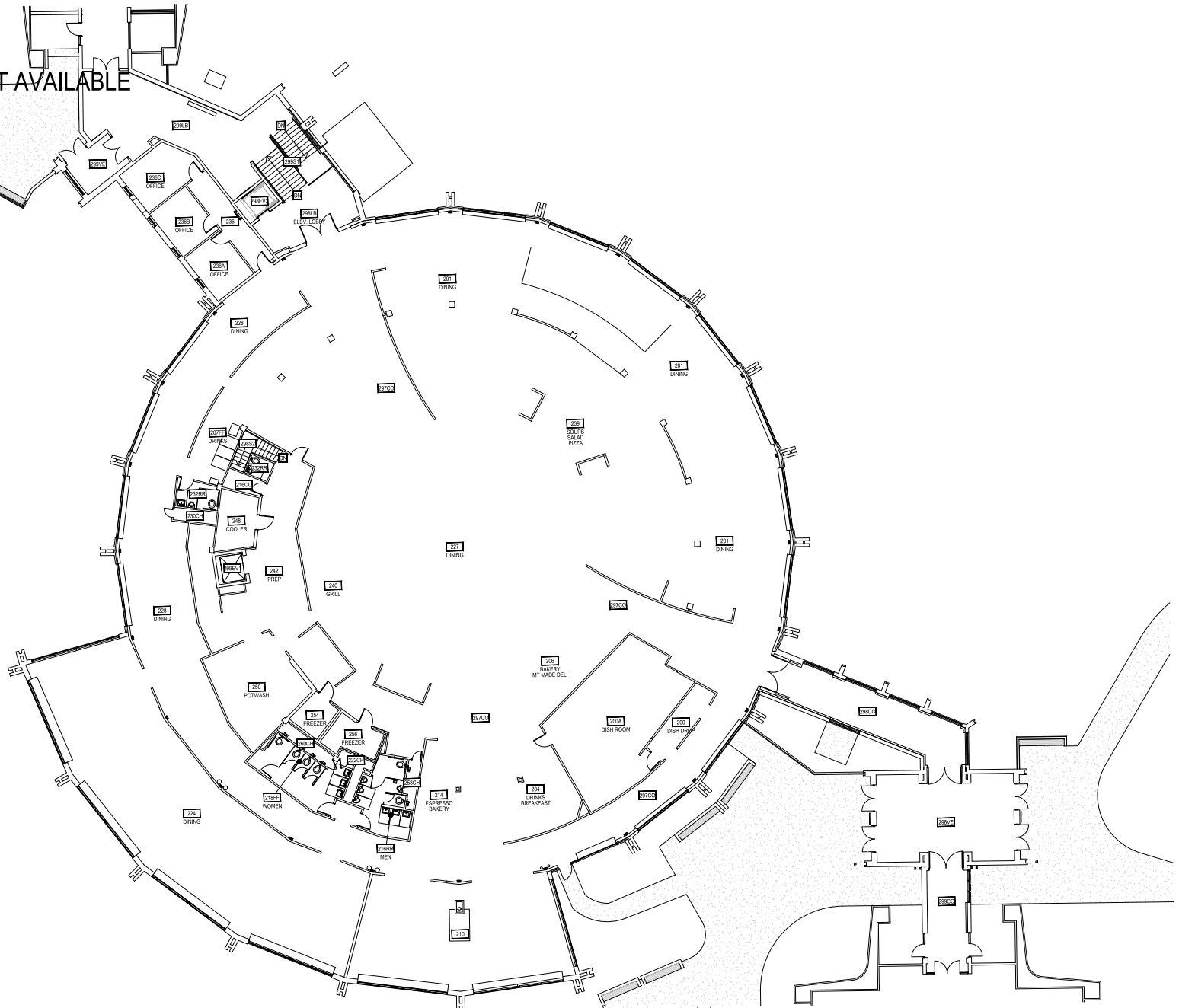

Oct 19, 2016 - 8:53 am - 341_A2.dwg
C:\Users\gary.gramer\appdata\local\temp\AcPublish_14840\

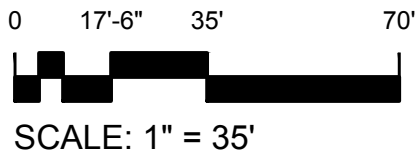

1 SECOND LEVEL
MILLER DINING HALL

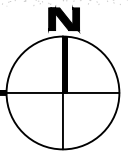

M MONTANA STATE UNIVERSITY
CAMPUS PLANNING,
DESIGN & CONSTRUCTION
BOZEMAN, MONTANA
PHONE: 406.994.5413 FAX: 406.994.5665

INDEX #	43
BUILDING #	341

PRELIMINARY DATA
AS-BUILT DRAWINGS NOT AVAILABLE

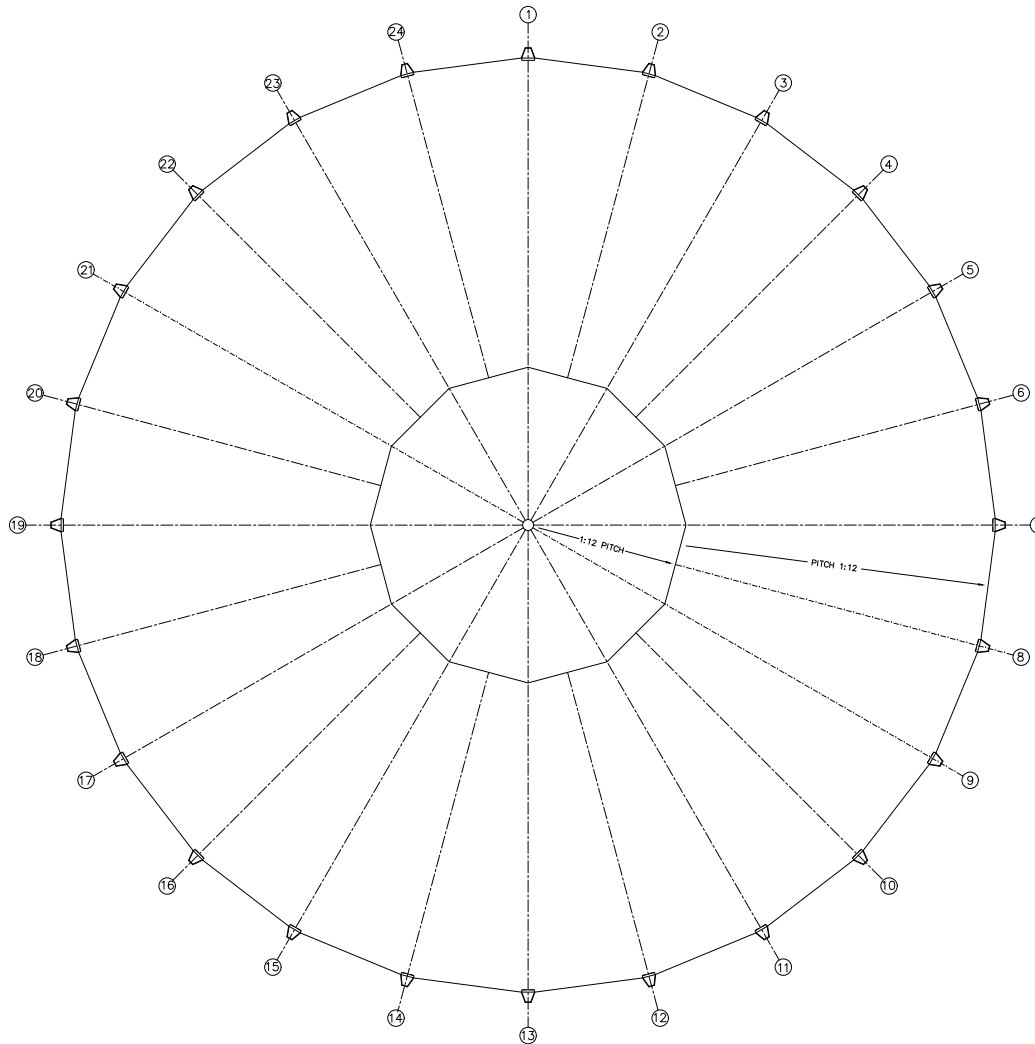

Oct 19, 2016 - 8:31 am - 341_AR.dwg
H:\Hedges Dorms\Miller Dining Hall\Building Plan - Book Copy\

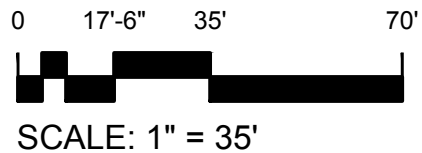

1 ROOF LEVEL
MILLER DINING HALL



M MONTANA
STATE UNIVERSITY
CAMPUS PLANNING,
DESIGN & CONSTRUCTION
BOZEMAN, MONTANA
PHONE: 406.994.5413 FAX: 406.994.5665

INDEX #	43
BUILDING #	341