

Dec 27, 2016 - 8:51 am - 175101_A1.dwg
 H:\Bobcat Stadium\Building Plan - Book Copy\

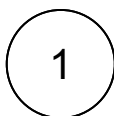

SCALE: 1" = 20'



FIRST LEVEL (SEATING)
 BOBCAT STADIUM TRACK GRANDSTAND

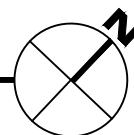

MONTANA
 STATE UNIVERSITY
 CAMPUS PLANNING,
 DESIGN & CONSTRUCTION
 BOZEMAN, MONTANA
 PHONE: 406.994.5413 FAX: 406.994.5665

INDEX #	66
BUILDING #	175101

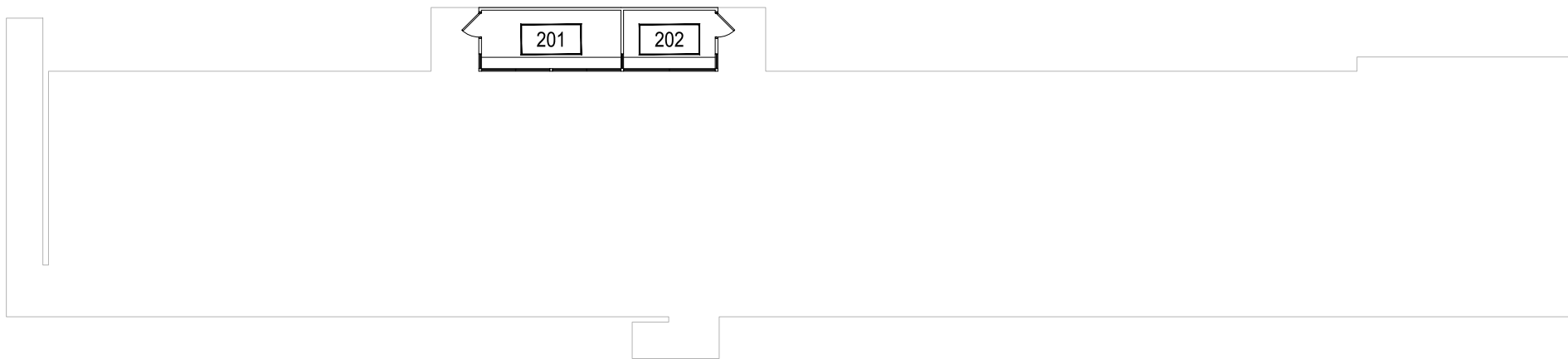

Dec 27, 2016 - 8:51 am - 175101_A2.dwg
 H:\Bobcat Stadium\Building Plan - Book Copy\



SCALE: 1" = 20'

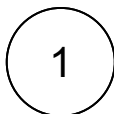

SECOND LEVEL (PRESS BOX)

BOBCAT STADIUM TRACK GRANDSTAND

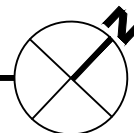

 MONTANA STATE UNIVERSITY CAMPUS PLANNING, DESIGN & CONSTRUCTION BOZEMAN, MONTANA PHONE: 406.994.5413 FAX: 406.994.5665	INDEX #
	66
BUILDING #	
175101	

INDEX #
66
BUILDING #
175101