

Jul 09, 2012 - 11:34am - 443-A1.dwg
C:\Users\gramer\AppData\Local\Temp\AcPublish_7068\

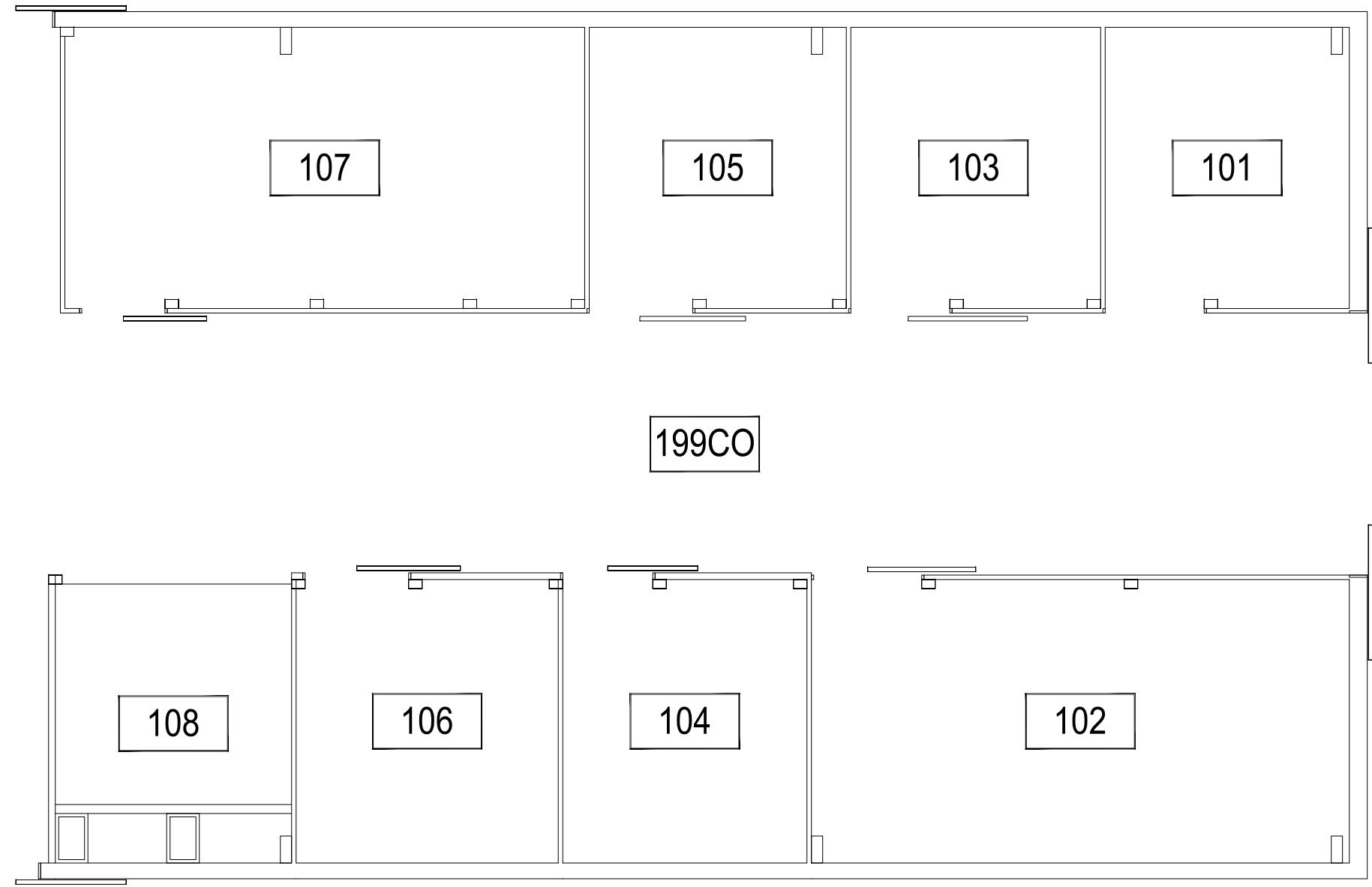

1 AGFIELD HORSE BARN - FIRST LEVEL
SCALE: 1/8" = 1'

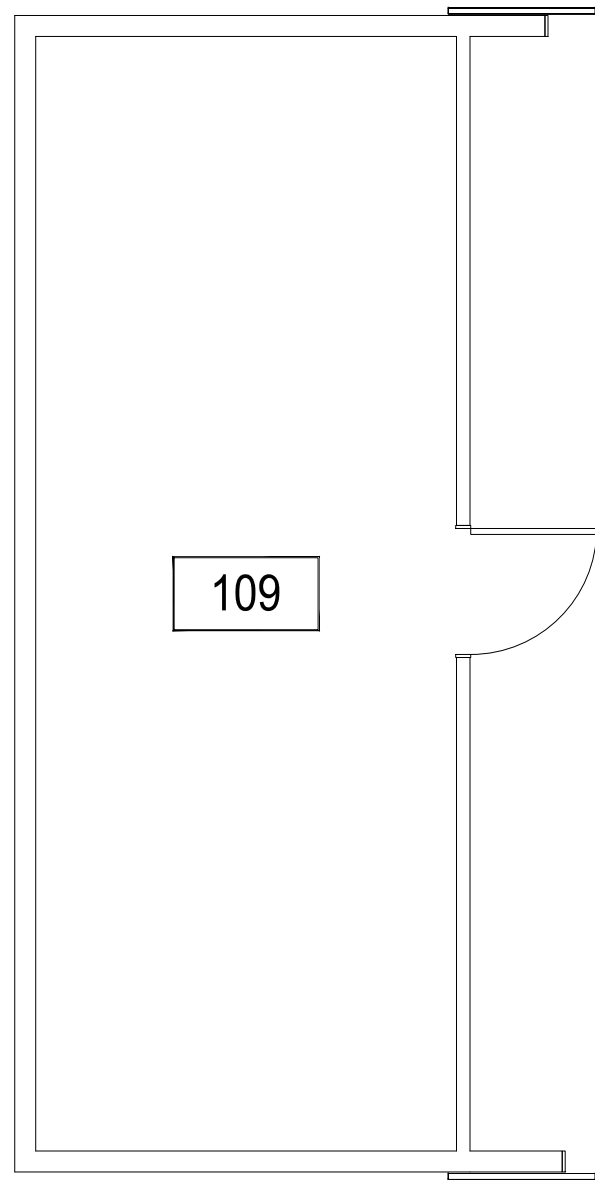
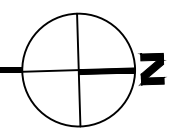

M MONTANA STATE UNIVERSITY
FACILITIES PLANNING,
DESIGN & CONSTRUCTION
BOZEMAN, MONTANA
PHONE: 406.994.4131 FAX: 406.994.6572

INDEX #
111
BUILDING #
443

Jul 09, 2012 - 11:54am - 443-AR.dwg
C:\Users\gruner\AppData\Local\Temp\AcPublish_7068\



1

AGFIELD HORSE BARN - ROOF LEVEL

SCALE: 1/8" = 1'

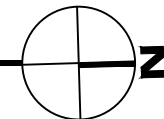

M MONTANA
STATE UNIVERSITY
FACILITIES PLANNING,
DESIGN & CONSTRUCTION
BOZEMAN, MONTANA
PHONE: 406.994.4131 FAX: 406.994.6572

INDEX #	111
BUILDING #	443