

Dec 21, 2016 - 7:51am - 344\_AB.dwg  
H:\Roskie Hall\Building Plan - Book Copy\

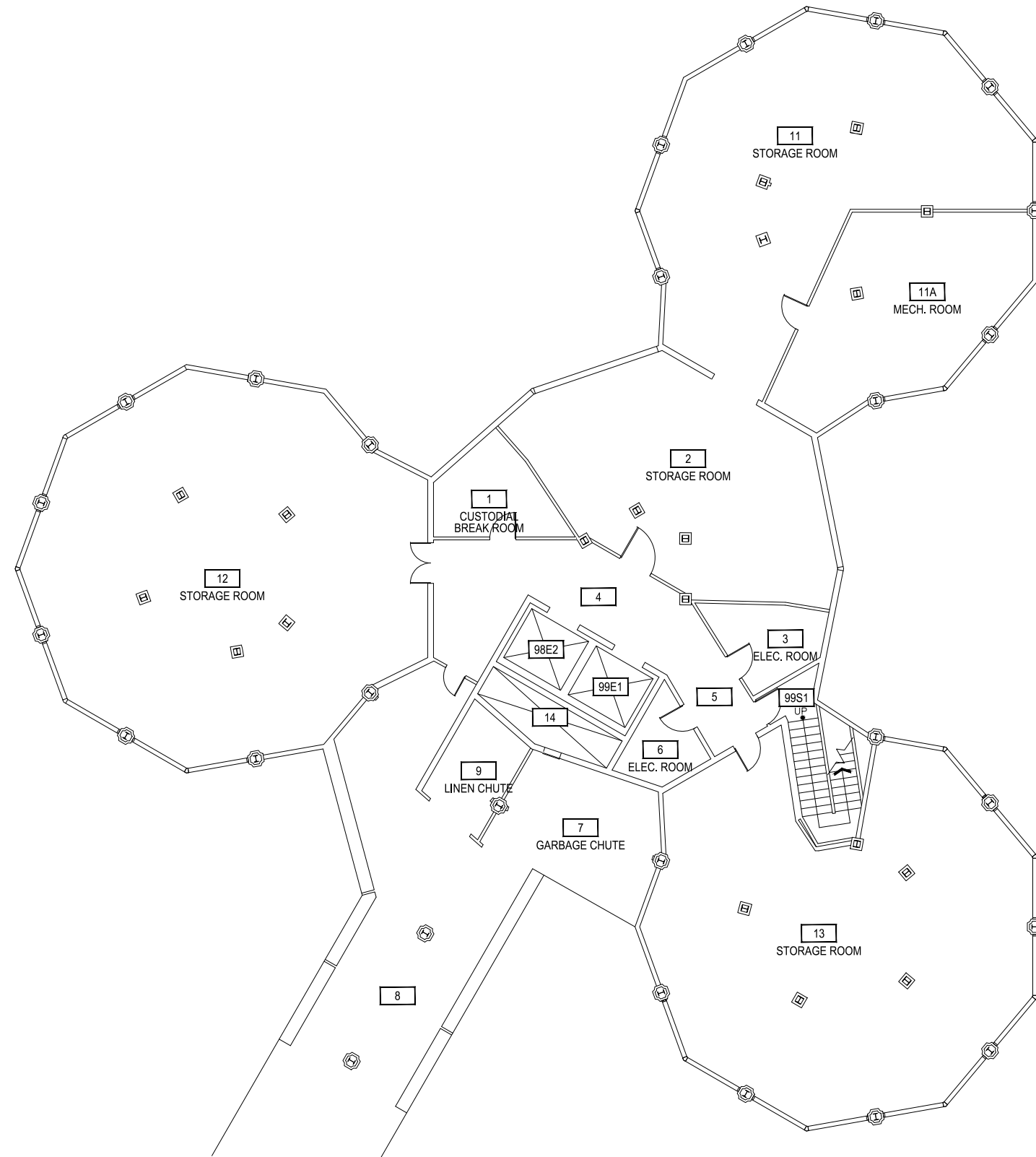

1

# ROSKIE HALL - BASEMENT LEVEL

SCALE: 1/16" = 1'



**M** MONTANA  
STATE UNIVERSITY  
CAMPUS PLANNING,  
DESIGN & CONSTRUCTION  
BOZEMAN, MONTANA  
PHONE: 406.994.5413 FAX: 406.994.5665

INDEX #

47

BUILDING #

344

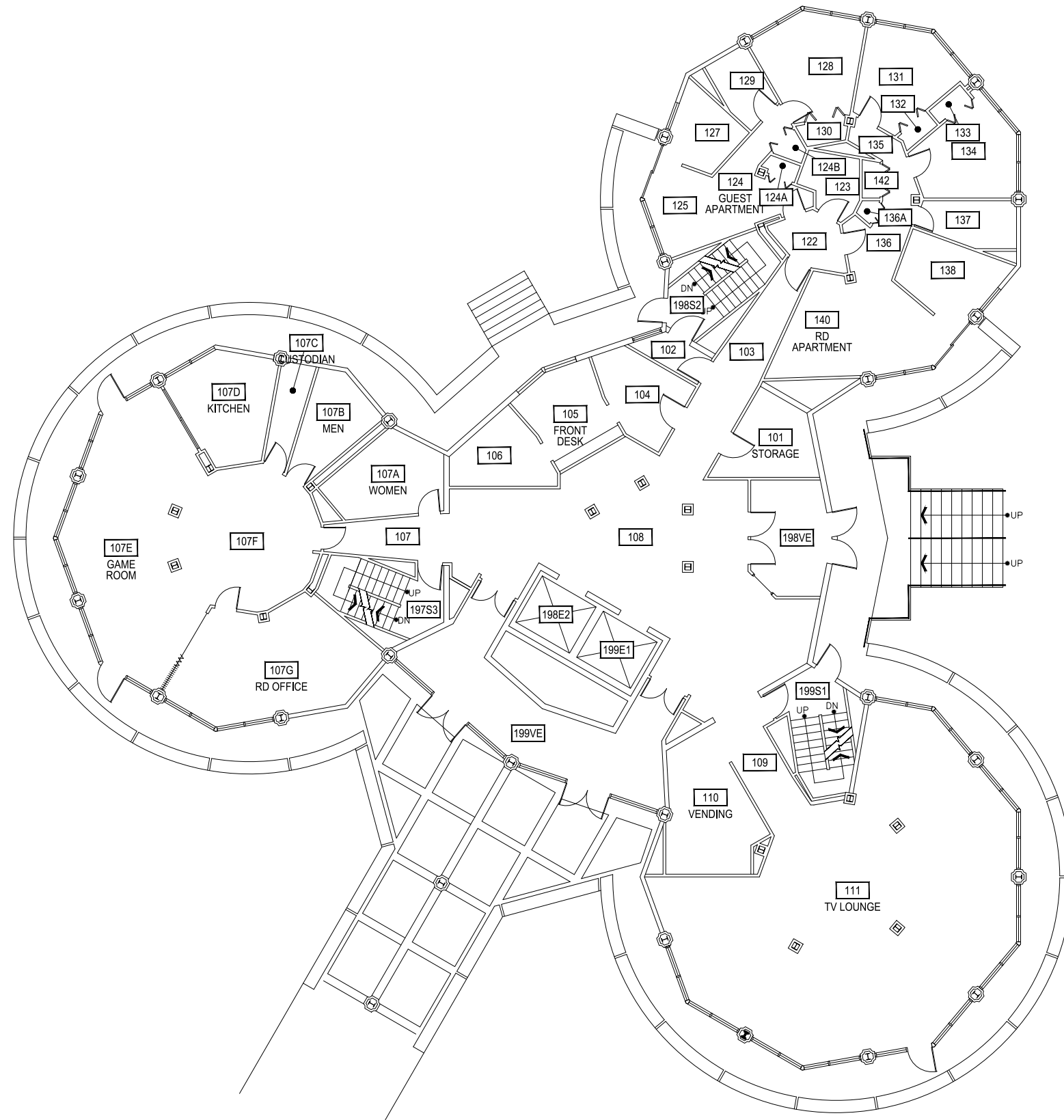

1

# ROSKIE HALL - FIRST LEVEL

SCALE: 1/16" = 1'



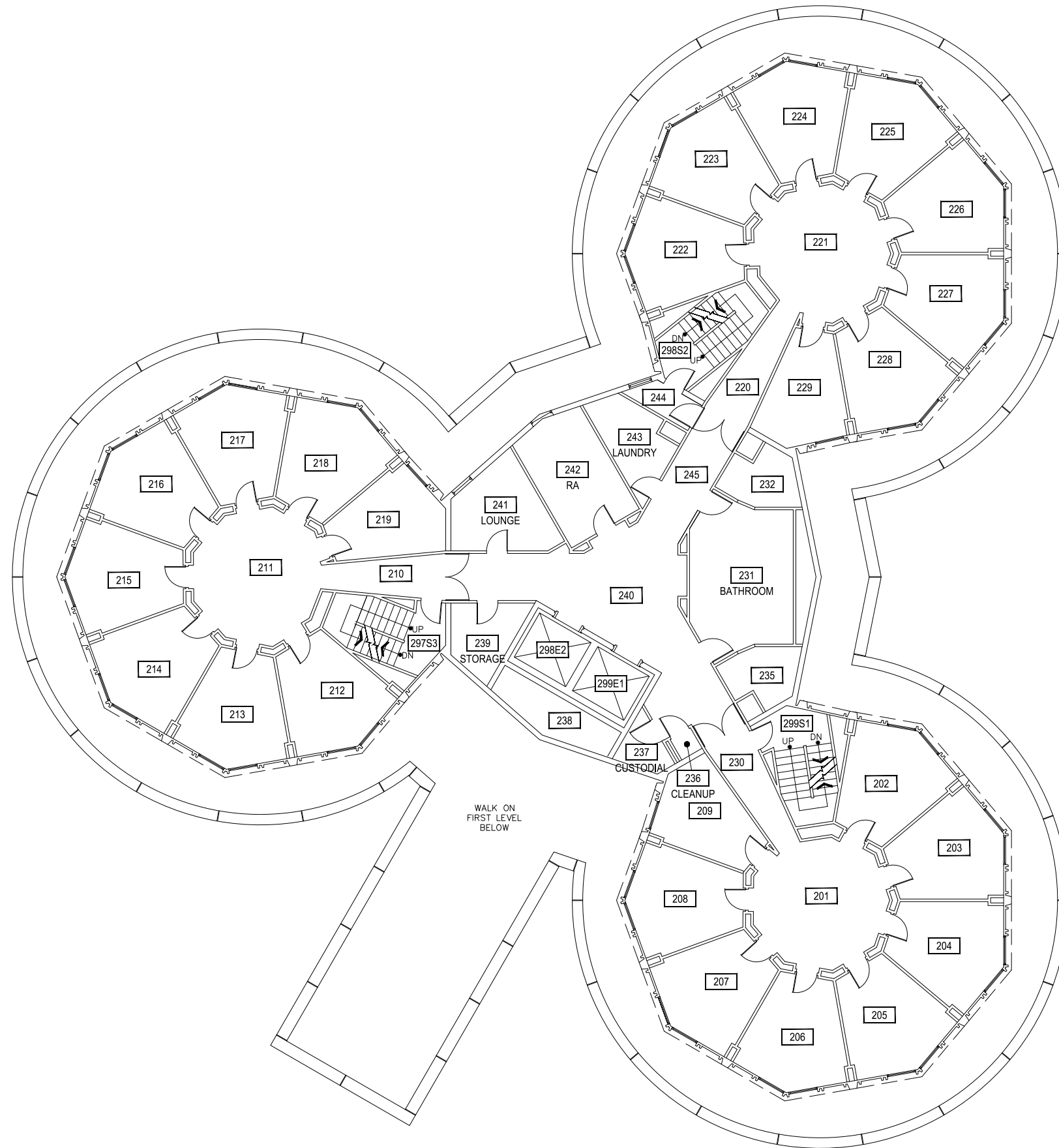

1

ROSKIE HALL - SECOND LEVEL

SCALE: 1/16" = 1'



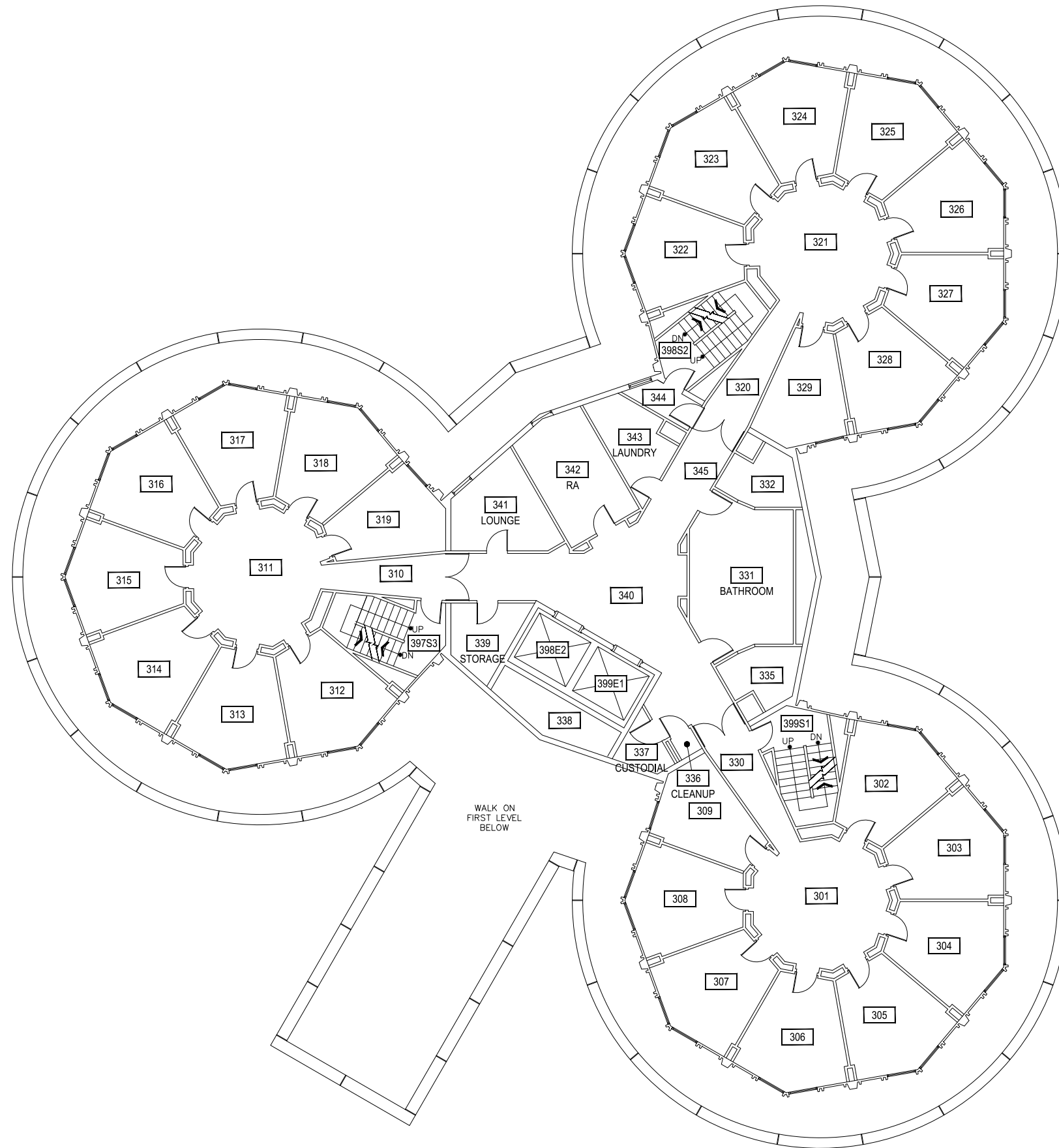

1

### ROSKIE HALL - THIRD LEVEL

SCALE: 1/16" = 1'



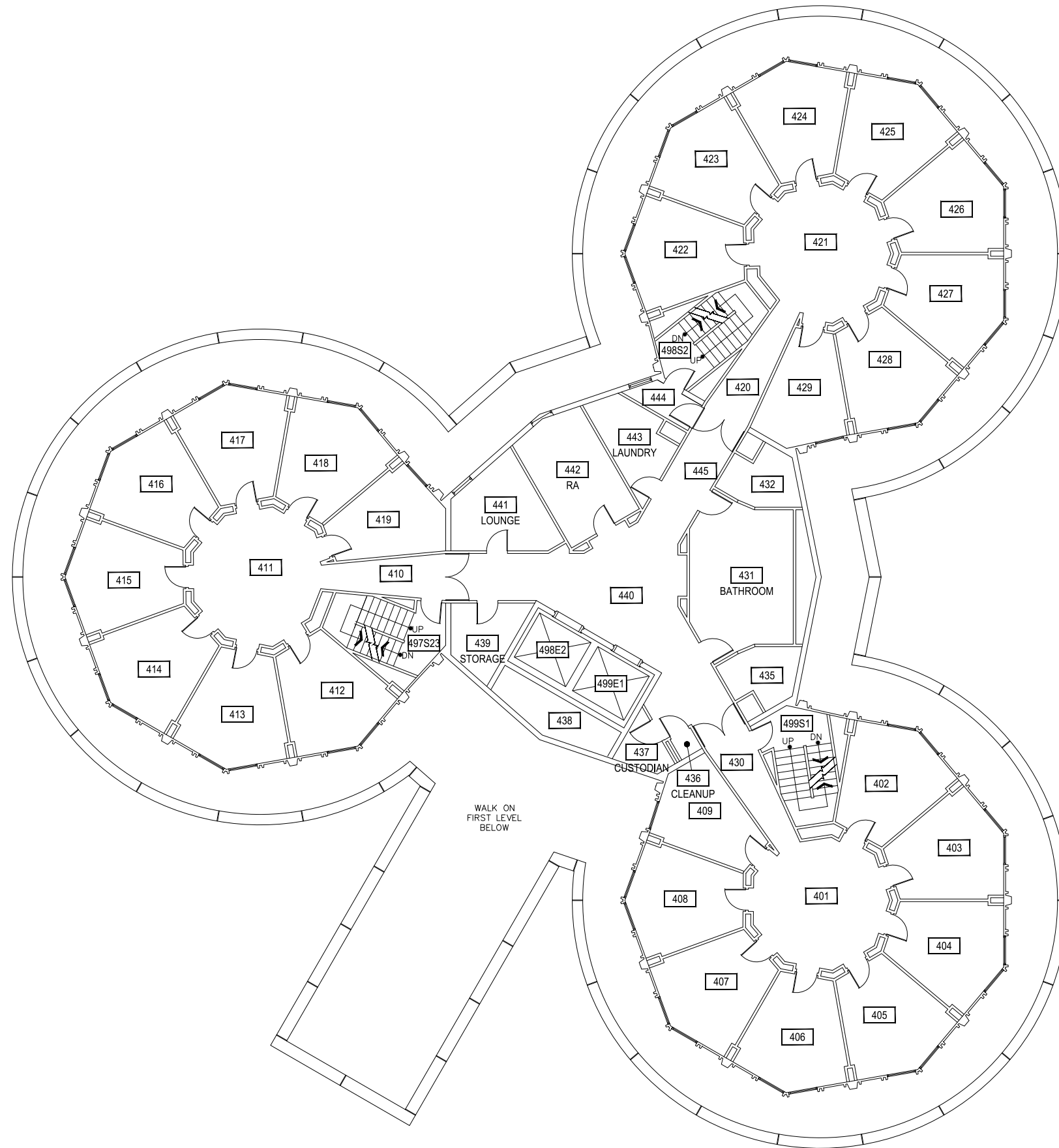

1

# ROSKIE HALL - FOURTH LEVEL

SCALE: 1/16" = 1'



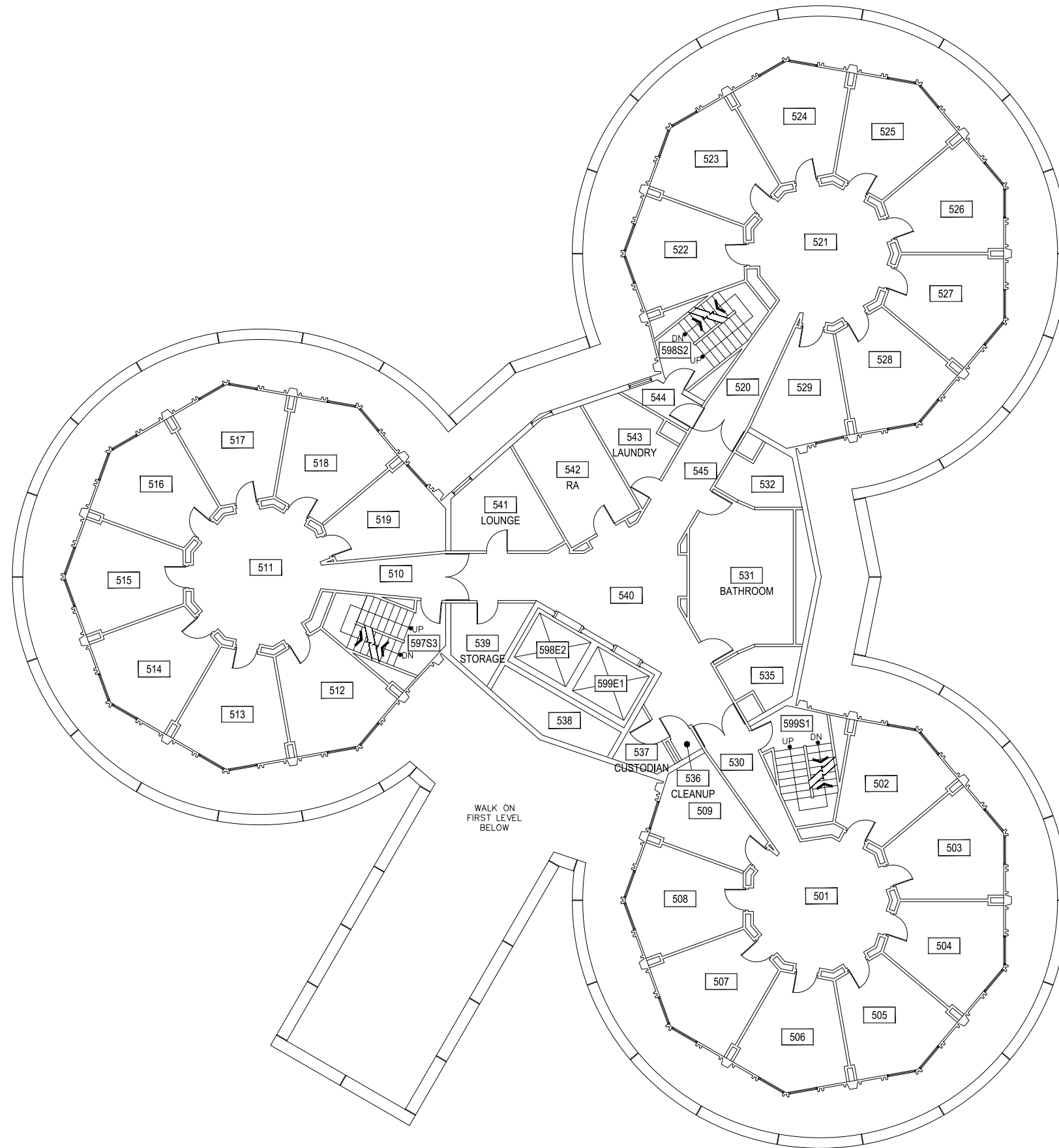

1

### ROSKIE HALL - FIFTH LEVEL

SCALE: 1/16" = 1'



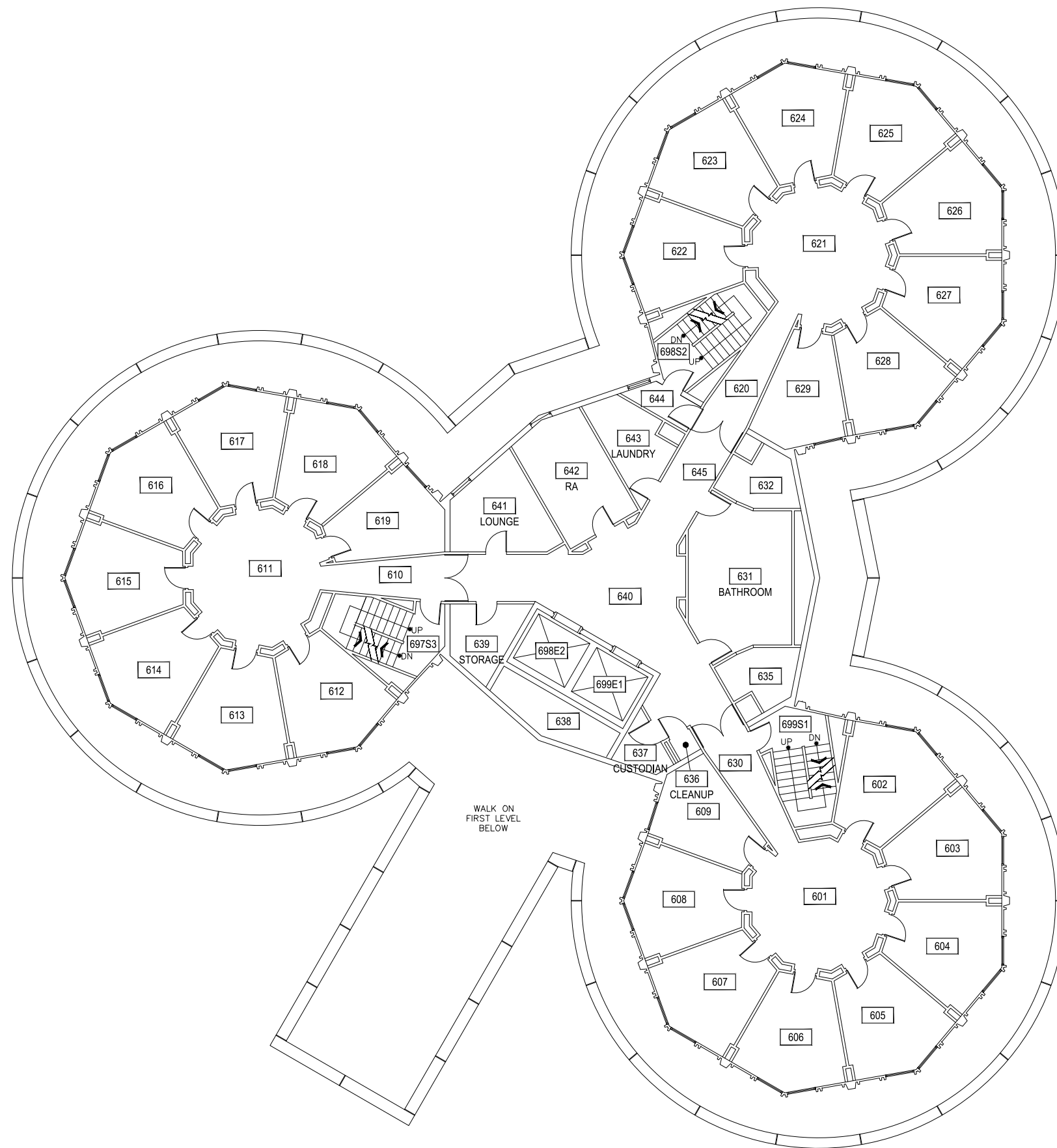

1

### ROSKIE HALL - SIXTH LEVEL

SCALE: 1/16" = 1'



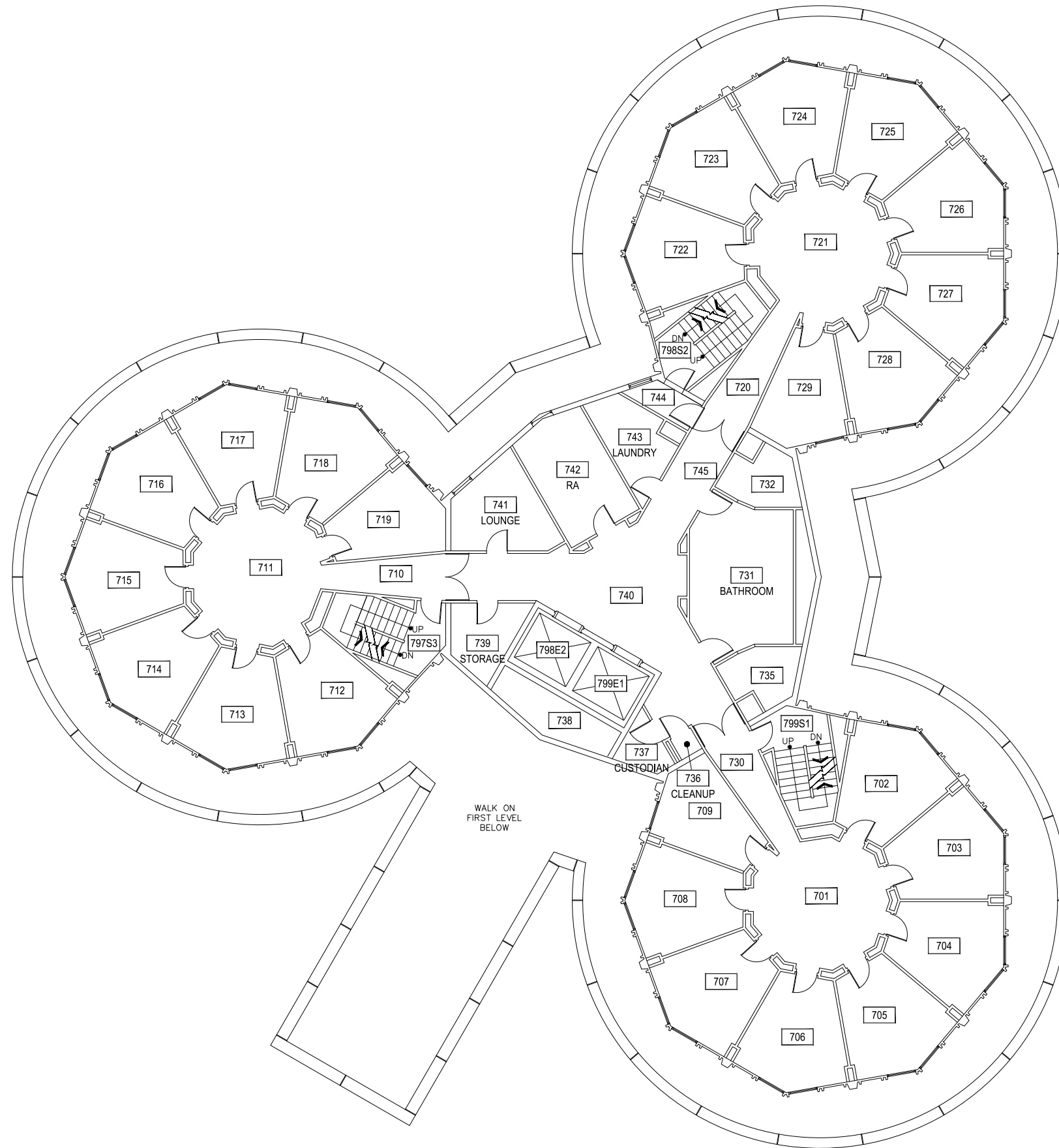

1

ROSKIE HALL - SEVENTH LEVEL

SCALE: 1/16" = 1'





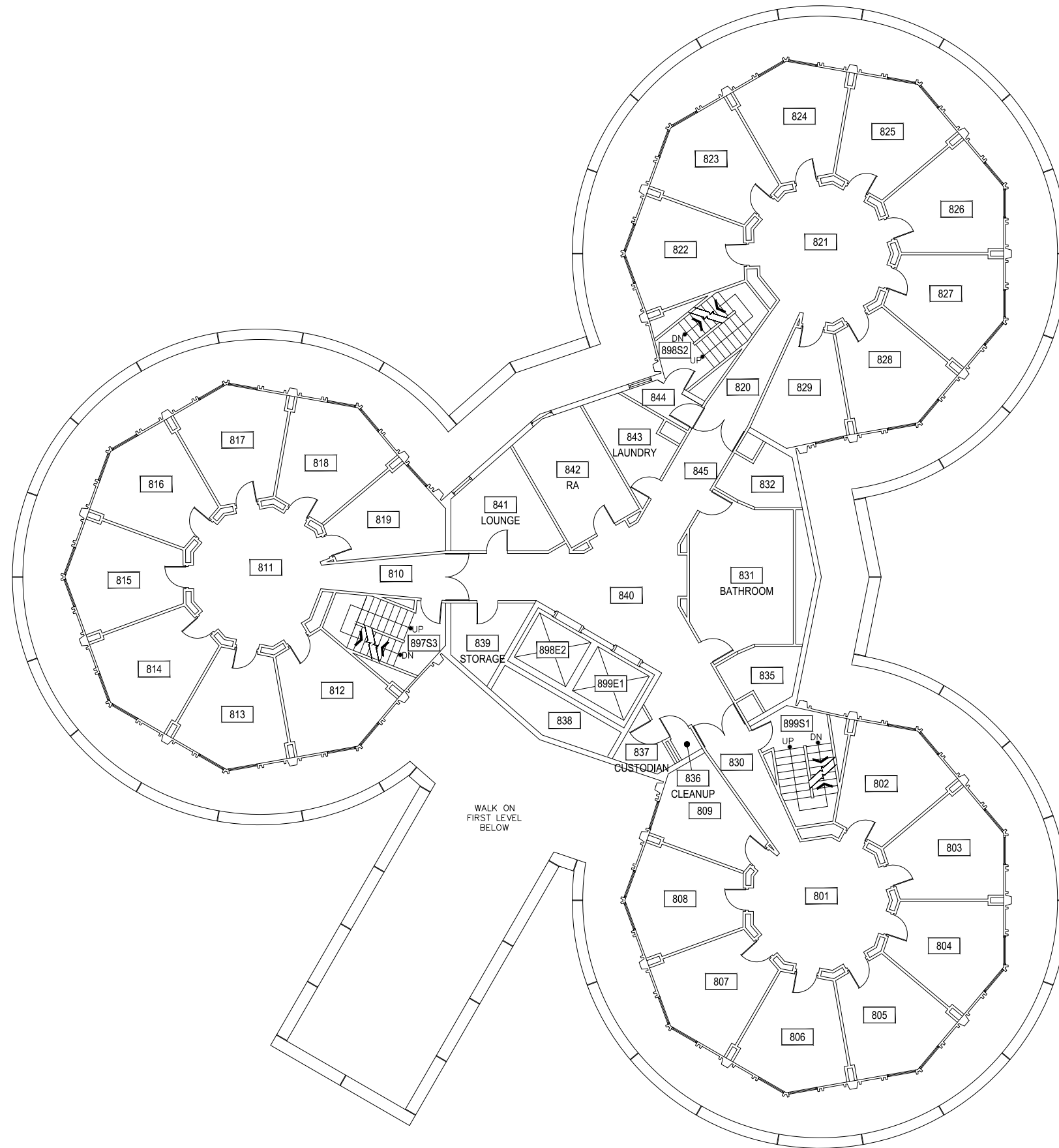

1

### ROSKIE HALL - EIGHTH LEVEL

SCALE: 1/16" = 1'



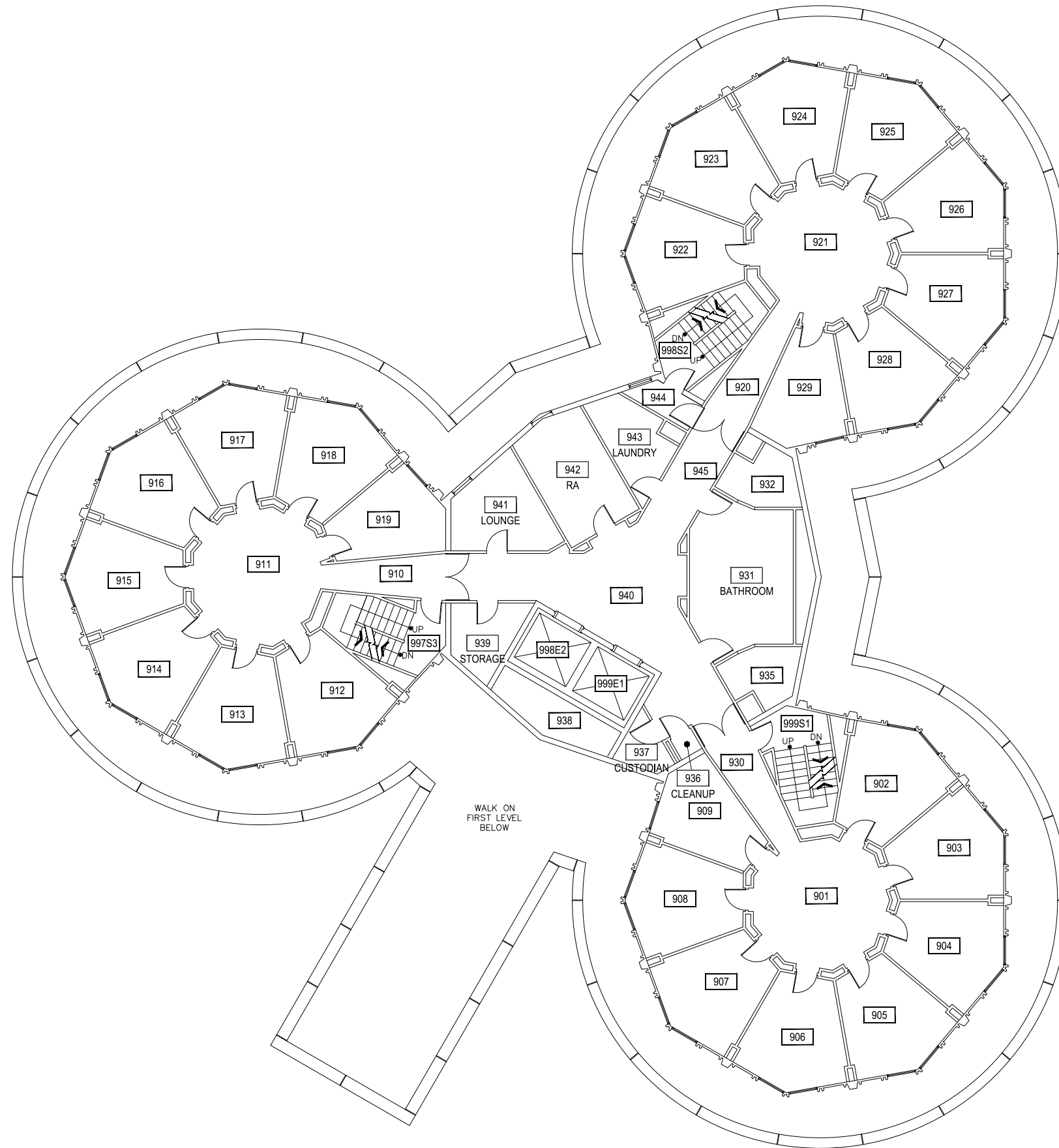

1

### ROSKIE HALL - NINTH LEVEL

SCALE: 1/16" = 1'



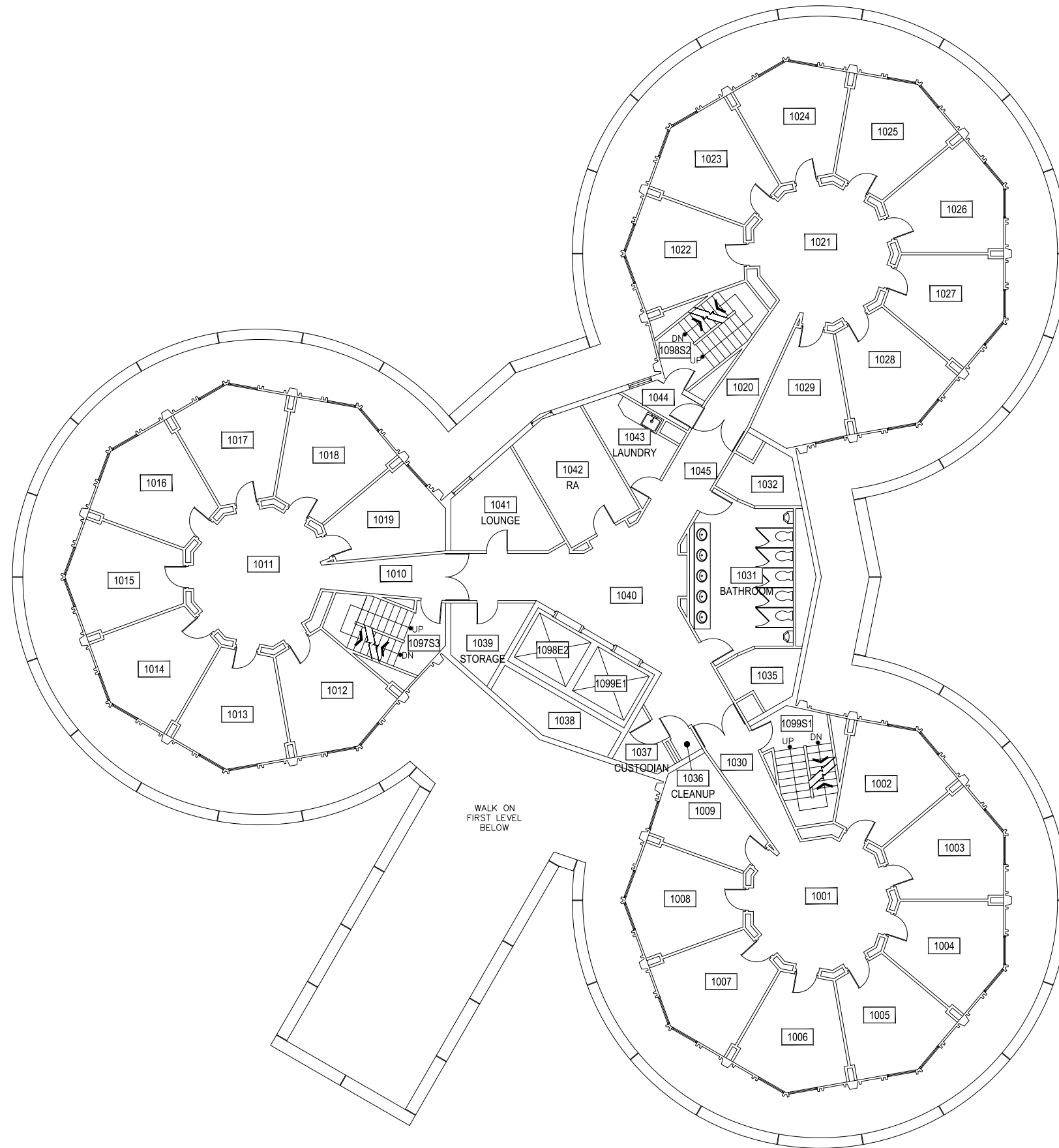

1

# ROSKIE HALL - TENTH LEVEL

SCALE: 1/16" = 1'



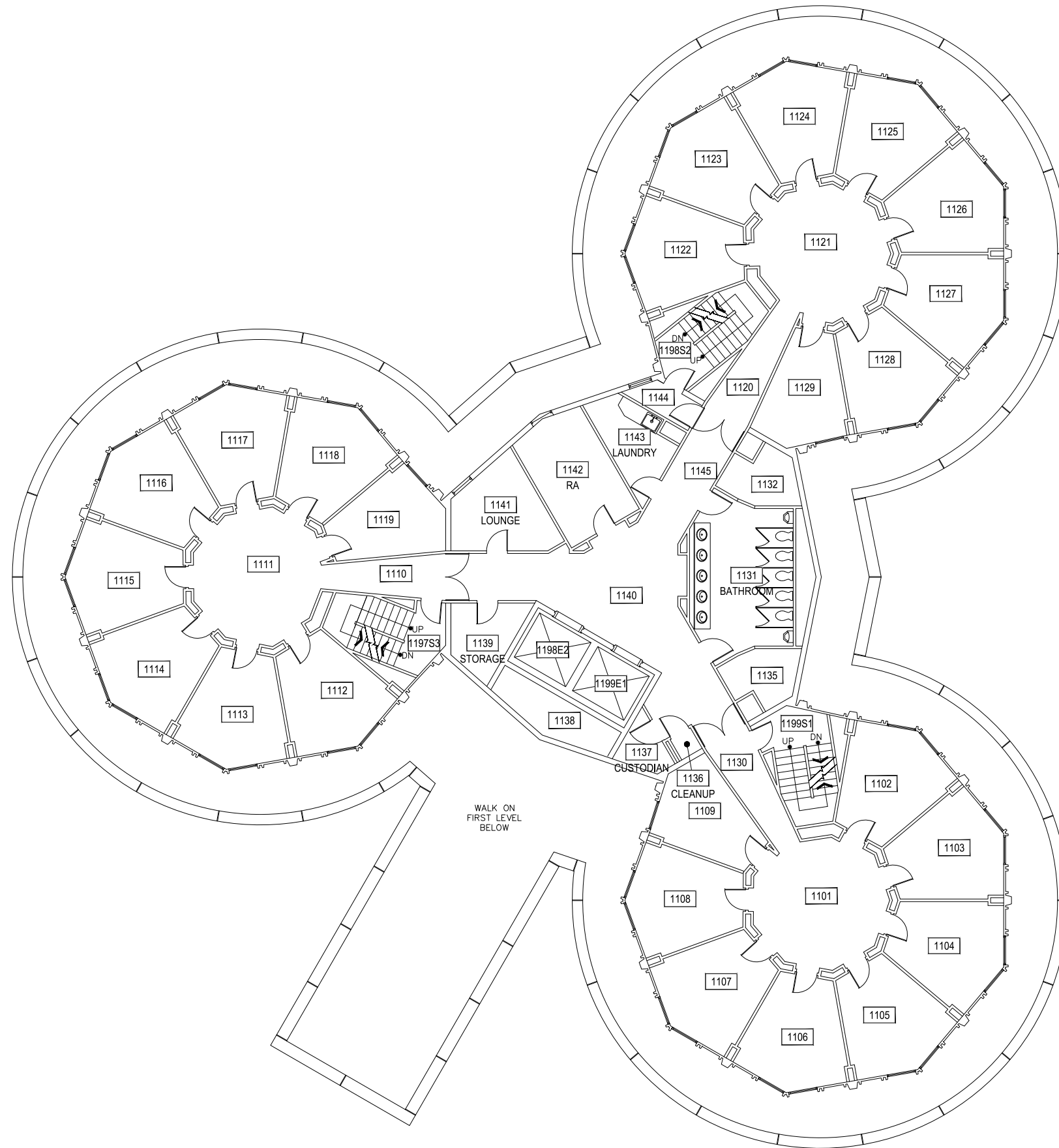

1

### ROSKIE HALL - ELEVENTH LEVEL

SCALE: 1/16" = 1'



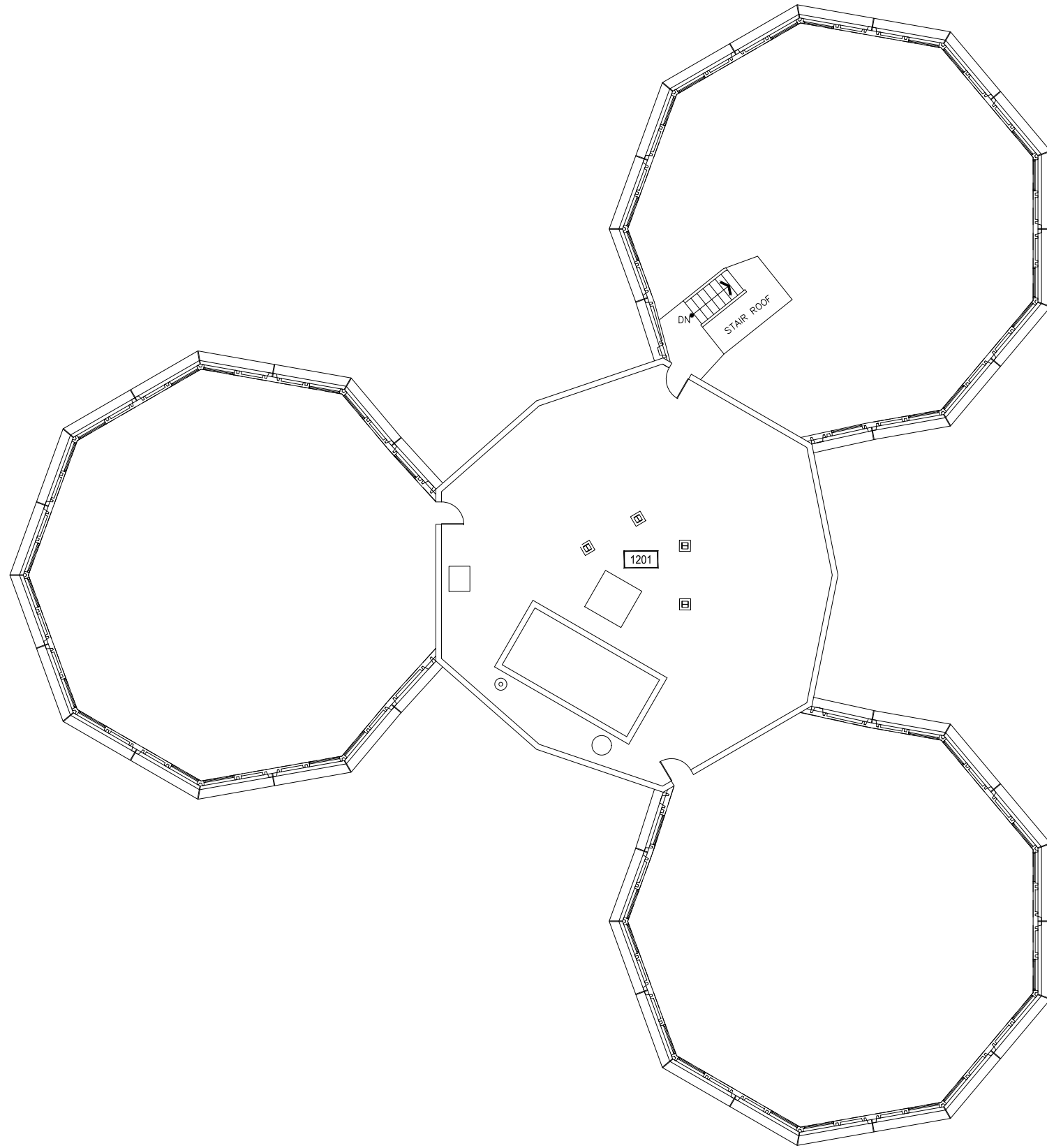

1 ROSKIE HALL - PENTHOUSE LEVEL  
SCALE: 1/16" = 1'



Dec 21, 2016 - 7:51am - 344\_AR.dwg  
H:\Roskie Hall\Building Plan - Book Copy\

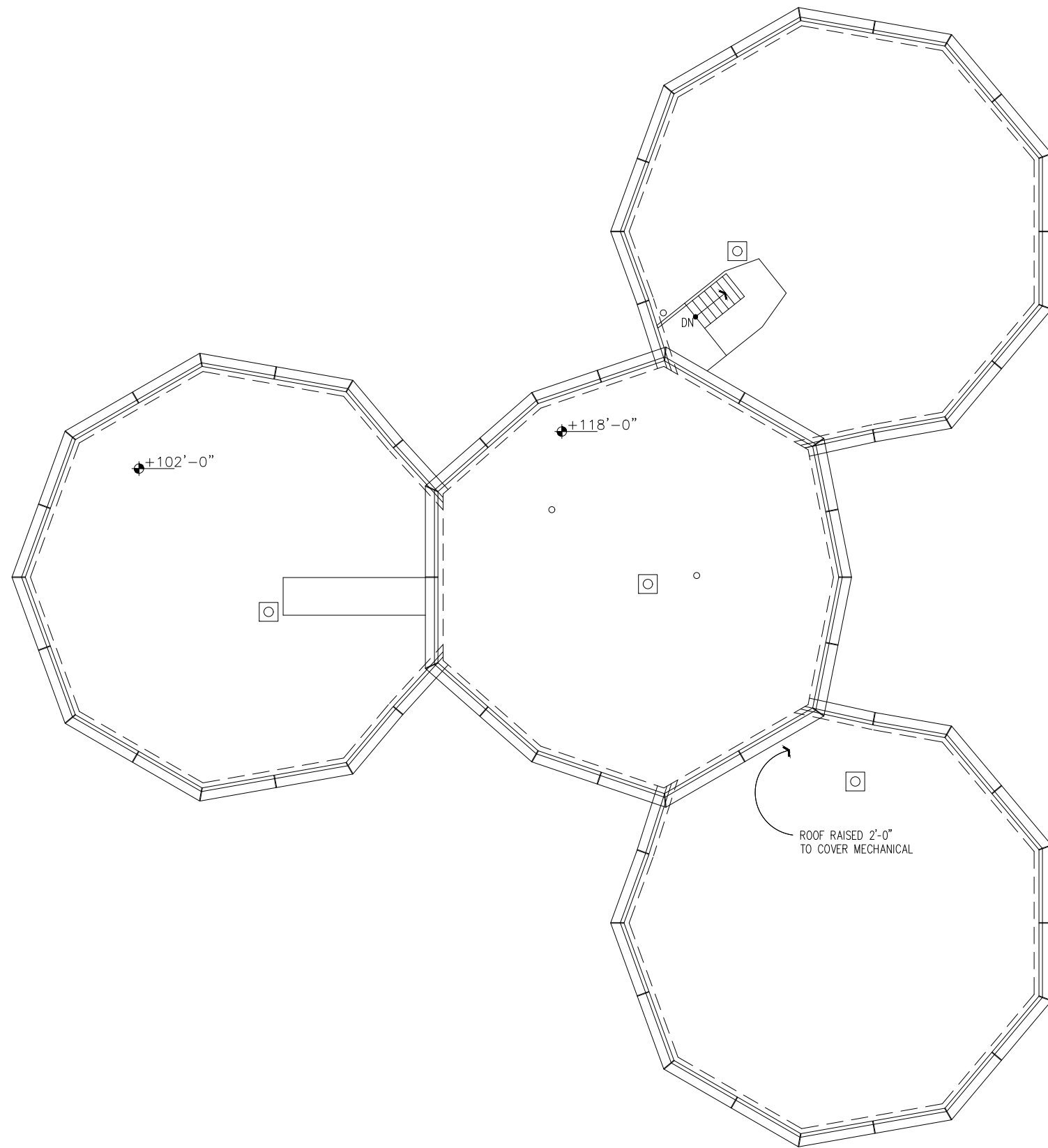

1

ROSKIE HALL - ROOF LEVEL

SCALE: 1/16" = 1'



**M** MONTANA  
STATE UNIVERSITY  
CAMPUS PLANNING,  
DESIGN & CONSTRUCTION  
BOZEMAN, MONTANA  
PHONE: 406.994.5413 FAX: 406.994.5665

INDEX #  
**47**  
BUILDING #  
**344**