

Mar 23, 2015 - 1:09pm - 330103_AB.dwg
H:\Johnstone Center (Lewis & Clark)\Mullan Hall\Building Plan - Book Copy\

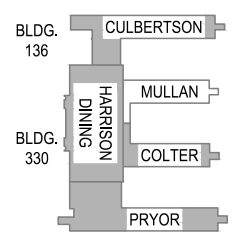
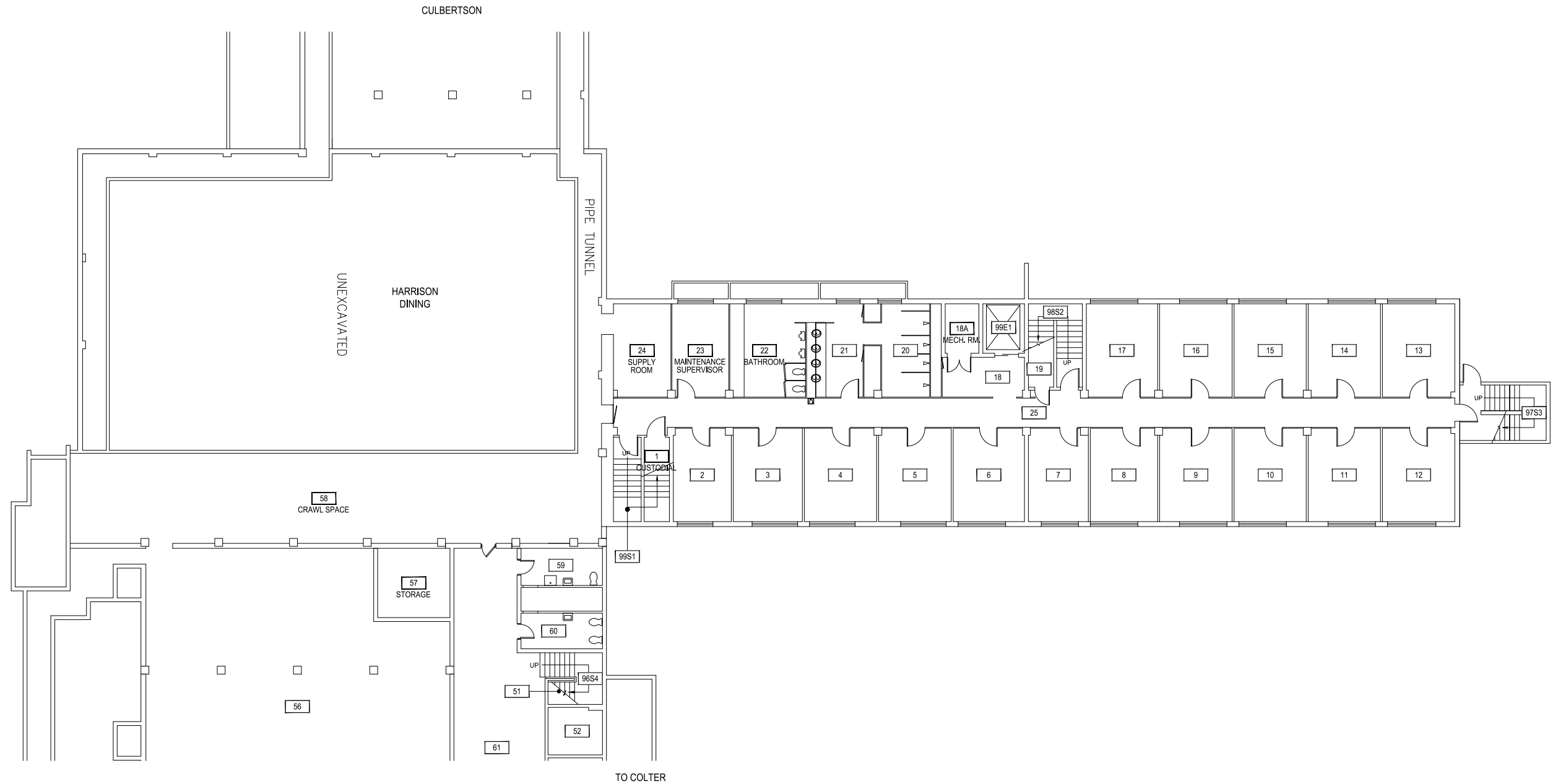

1 MULLAN HALL - BASEMENT LEVEL **2**
SCALE: 1" = 20'

M MONTANA STATE UNIVERSITY
CAMPUS PLANNING, DESIGN & CONSTRUCTION
BOZEMAN, MONTANA
PHONE: 406.994.5413 FAX: 406.994.5665

INDEX # **34**
BUILDING # **330103**

Mar 23, 2015 - 1:09pm - 330103_A1.dwg
 H:\Johnstone Center (Lewis & Clark)\Mullan Hall\Building Plan - Book Copy\

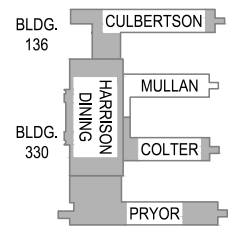
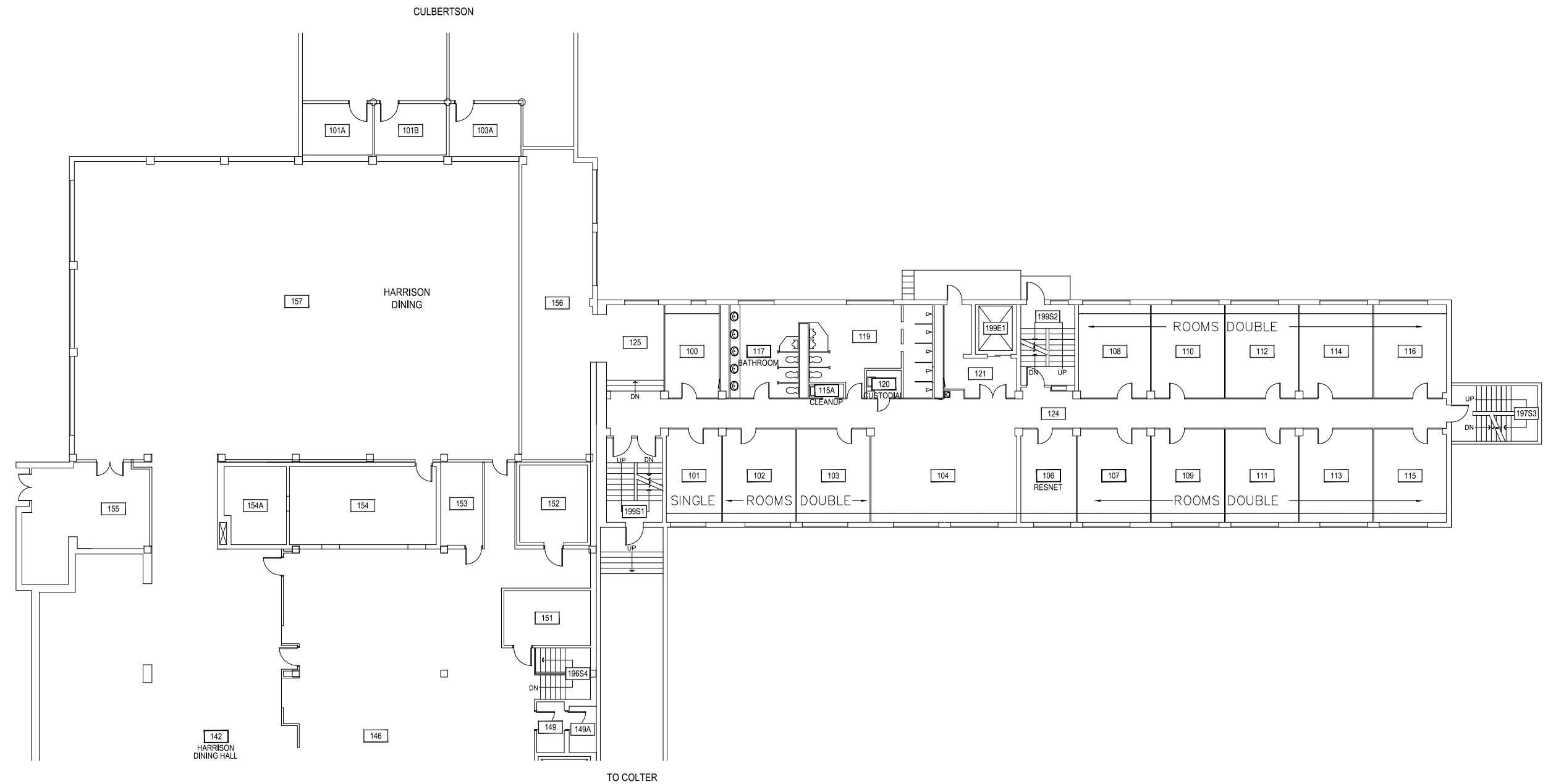

1 MULLAN HALL - FIRST LEVEL
 SCALE: 1" = 20'

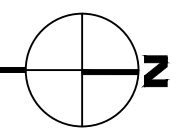

M MONTANA STATE UNIVERSITY
 CAMPUS PLANNING,
 DESIGN & CONSTRUCTION
 BOZEMAN, MONTANA
 PHONE: 406.994.5413 FAX: 406.994.5665

INDEX #
34
 BUILDING #
330103

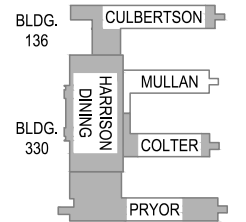
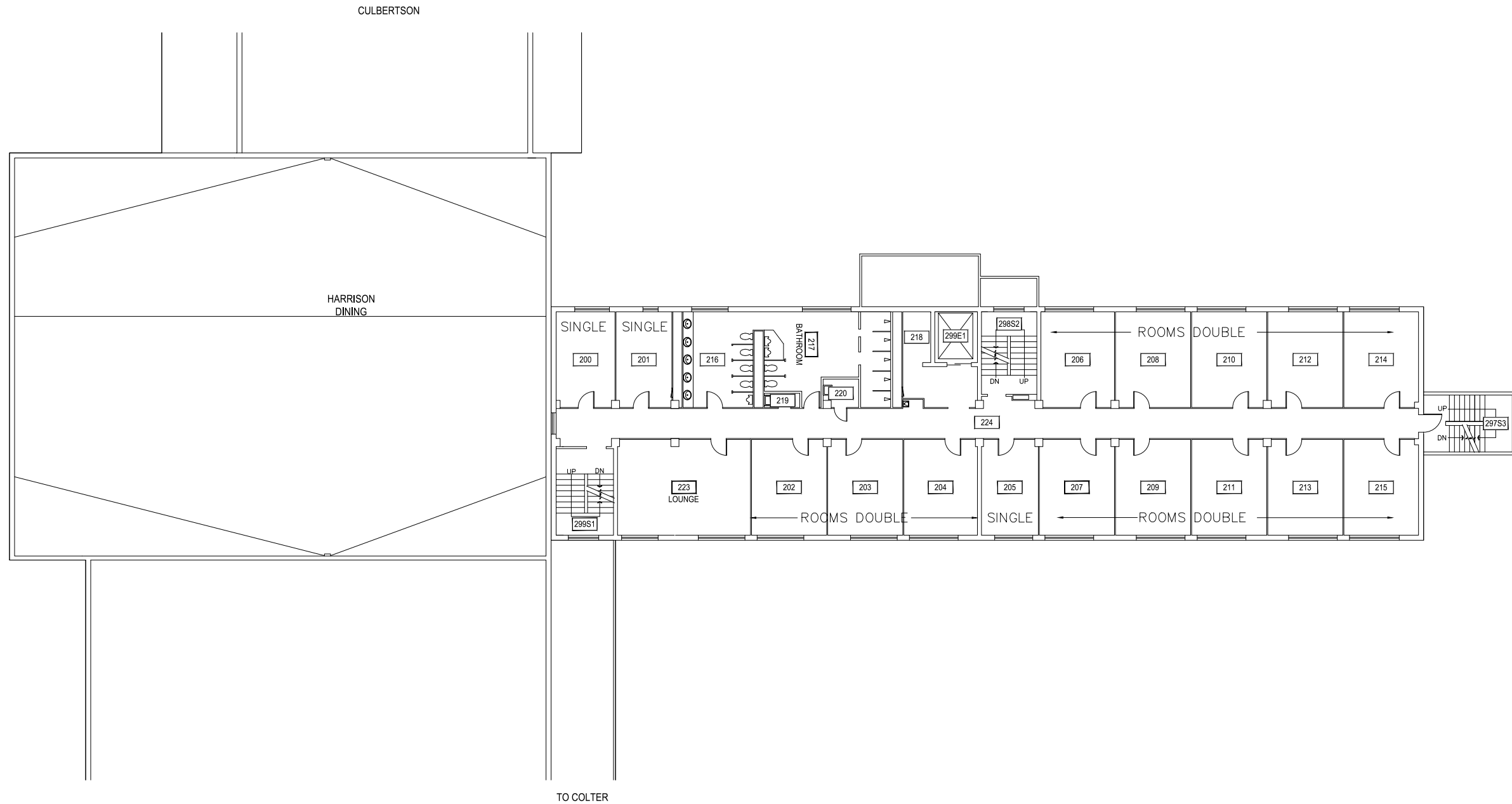

1 MULLAN HALL - SECOND LEVEL
 SCALE: 1" = 20'

M MONTANA STATE UNIVERSITY
 CAMPUS PLANNING, DESIGN & CONSTRUCTION
 BOZEMAN, MONTANA
 PHONE: 406.994.5413 FAX: 406.994.5665

INDEX # **34**
 BUILDING # **330103**

Mar 23, 2015 - 1:09pm - 330103_A2.dwg
 H:\Johnstone Center (Lewis & Clark)\Mullan Hall\Building Plan - Book Copy\

Mar 23, 2015 - 1:09pm - 330103_A3.dwg
H:\Johnstone Center (Lewis & Clark)\Mullan Hall\Building Plan - Book Copy\

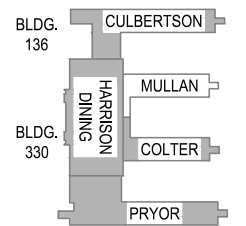

1 MULLAN HALL - THIRD LEVEL
SCALE: 1" = 20'



M MONTANA STATE UNIVERSITY
CAMPUS PLANNING,
DESIGN & CONSTRUCTION
BOZEMAN, MONTANA
PHONE: 406.994.5413 FAX: 406.994.5665

INDEX #
34
BUILDING #
330103

Mar 23, 2015 - 1:09pm - 330103_A4.dwg
H:\Johnstone Center (Lewis & Clark)\Mullan Hall\Building Plan - Book Copy\

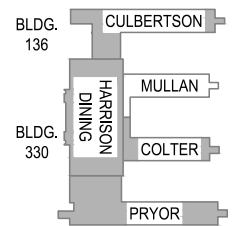
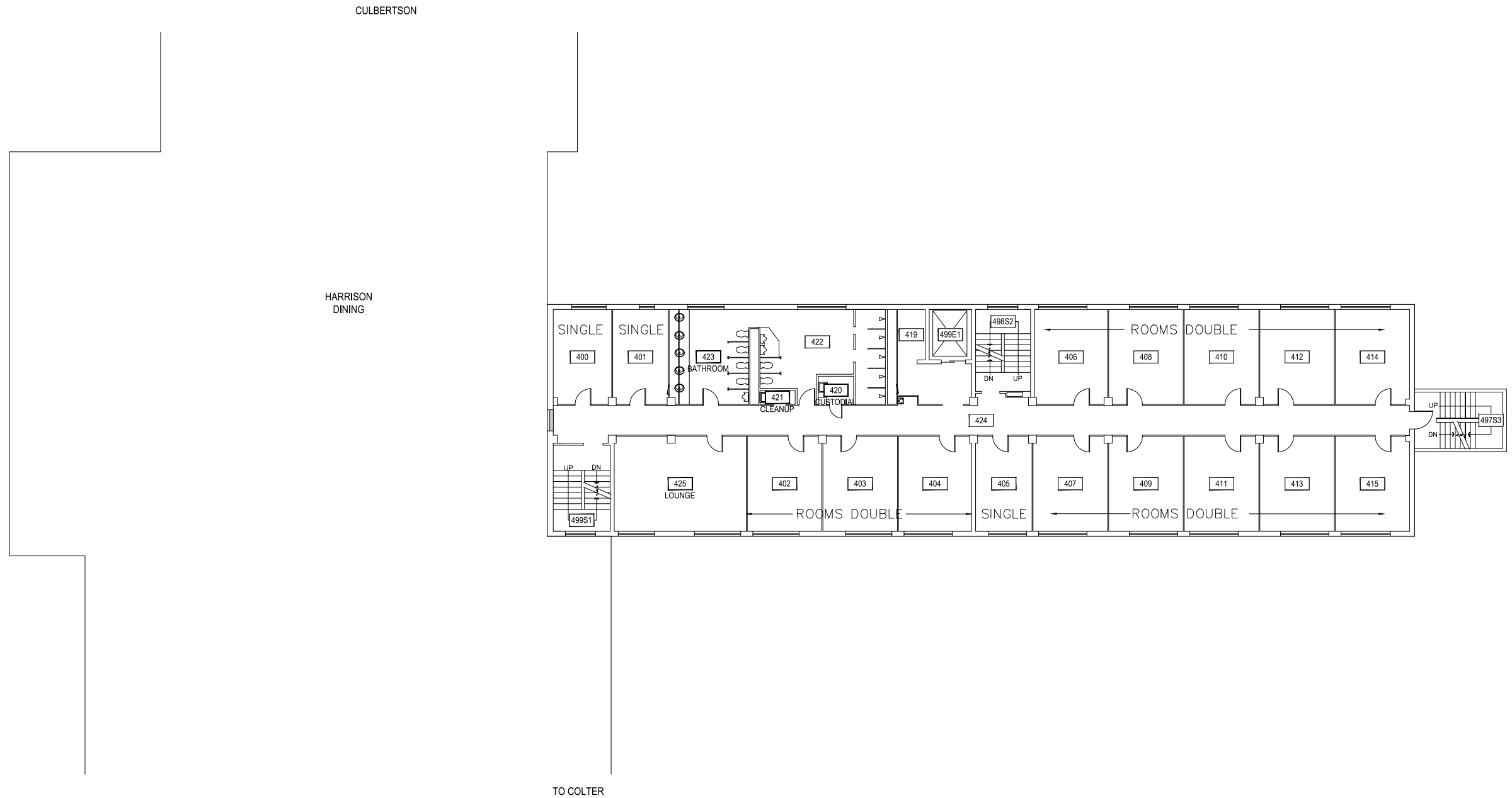

1 MULLAN HALL - FOURTH LEVEL
SCALE: 1" = 20'

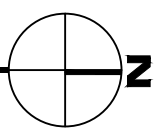

M MONTANA STATE UNIVERSITY
CAMPUS PLANNING,
DESIGN & CONSTRUCTION
BOZEMAN, MONTANA
PHONE: 406.994.5413 FAX: 406.994.5665

INDEX #
34
BUILDING #
330103

Mar 23, 2015 - 1:09pm - 330103_AR.dwg
H:\Johnstone Center (Lewis & Clark)\Mullan Hall\Building Plan - Book Copy\

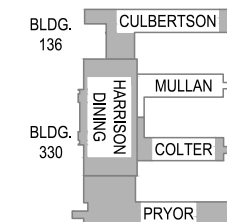
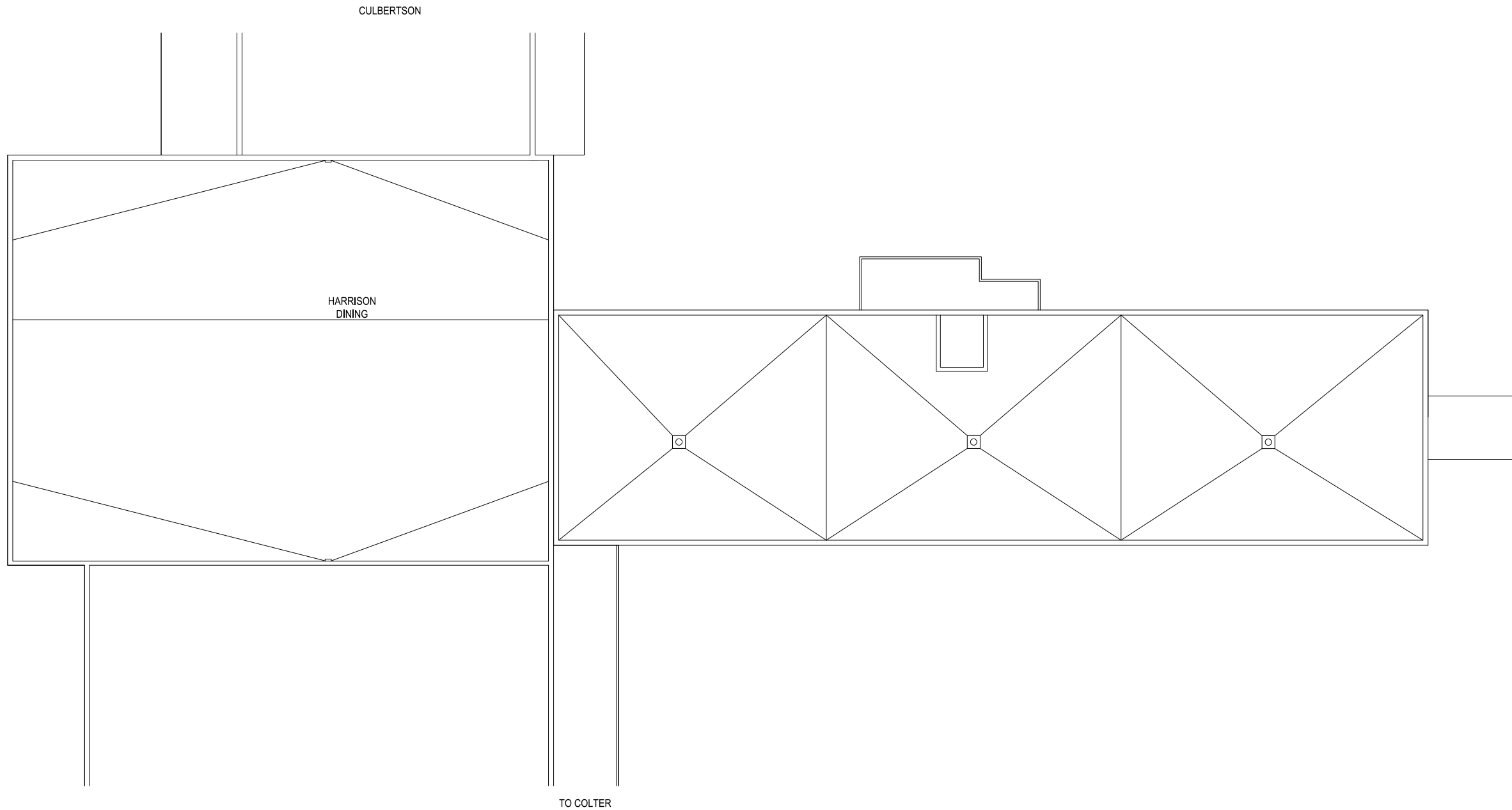

1 MULLAN HALL - ROOF LEVEL
SCALE: 1" = 20'

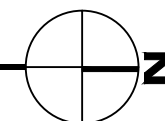

 MONTANA STATE UNIVERSITY CAMPUS PLANNING, DESIGN & CONSTRUCTION BOZEMAN, MONTANA PHONE: 406.994.5413 FAX: 406.994.5665	INDEX # 34
	BUILDING # 330103