

Mar 20, 2015 - 2:47pm - 330101_AB.dwg
H:\Johnstone Center (Lewis & Clark)\Pryor Hall\Building Plan - Book Copy\

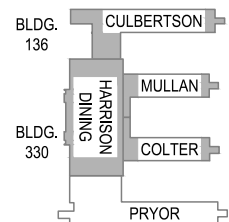
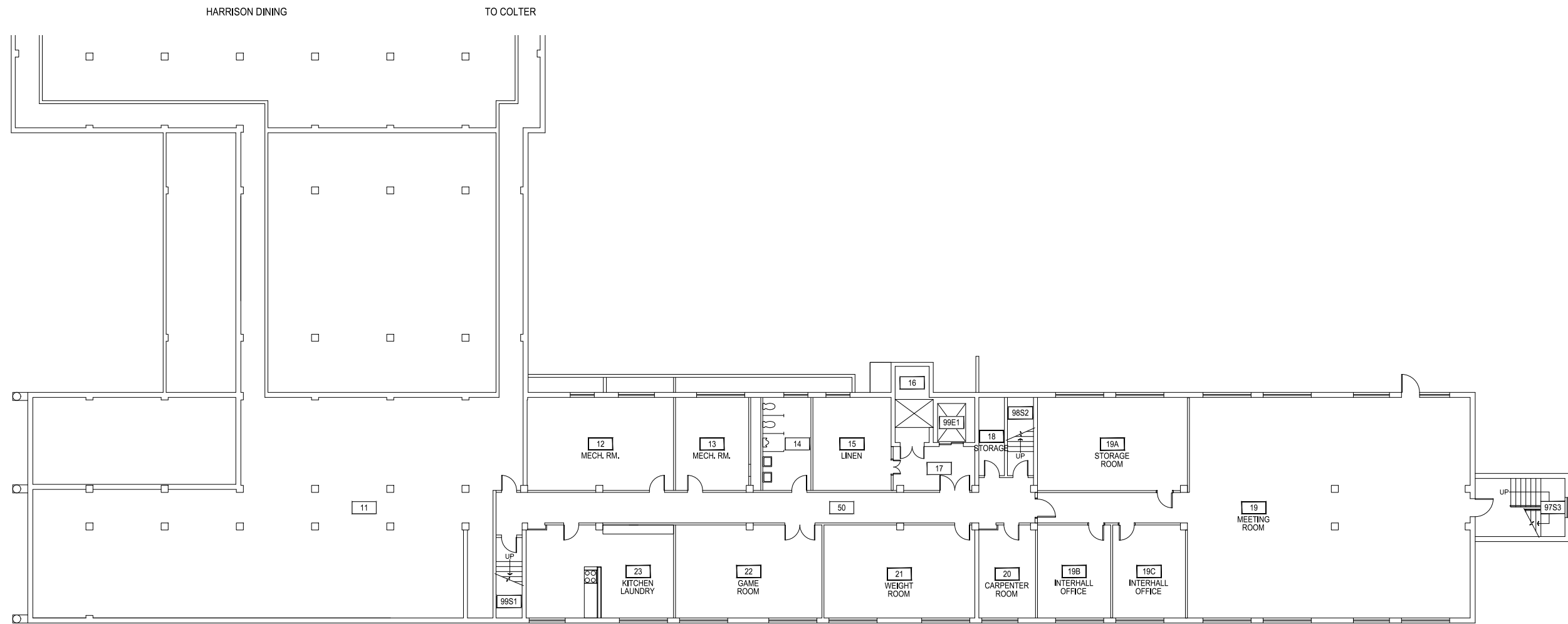

1 PRYOR HALL - BASEMENT LEVEL
SCALE: 1" = 20'

M MONTANA STATE UNIVERSITY
CAMPUS PLANNING,
DESIGN & CONSTRUCTION
BOZEMAN, MONTANA
PHONE: 406.994.5413 FAX: 406.994.5665

INDEX #
34
BUILDING #
330101

Mar 20, 2015 - 2:47 pm - 330101_A1.dwg
H:\Johnstone Center (Lewis & Clark)\Pryor Hall\Building Plan - Book Copy\

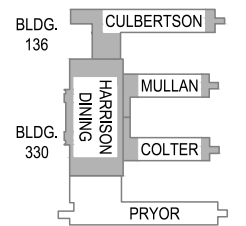
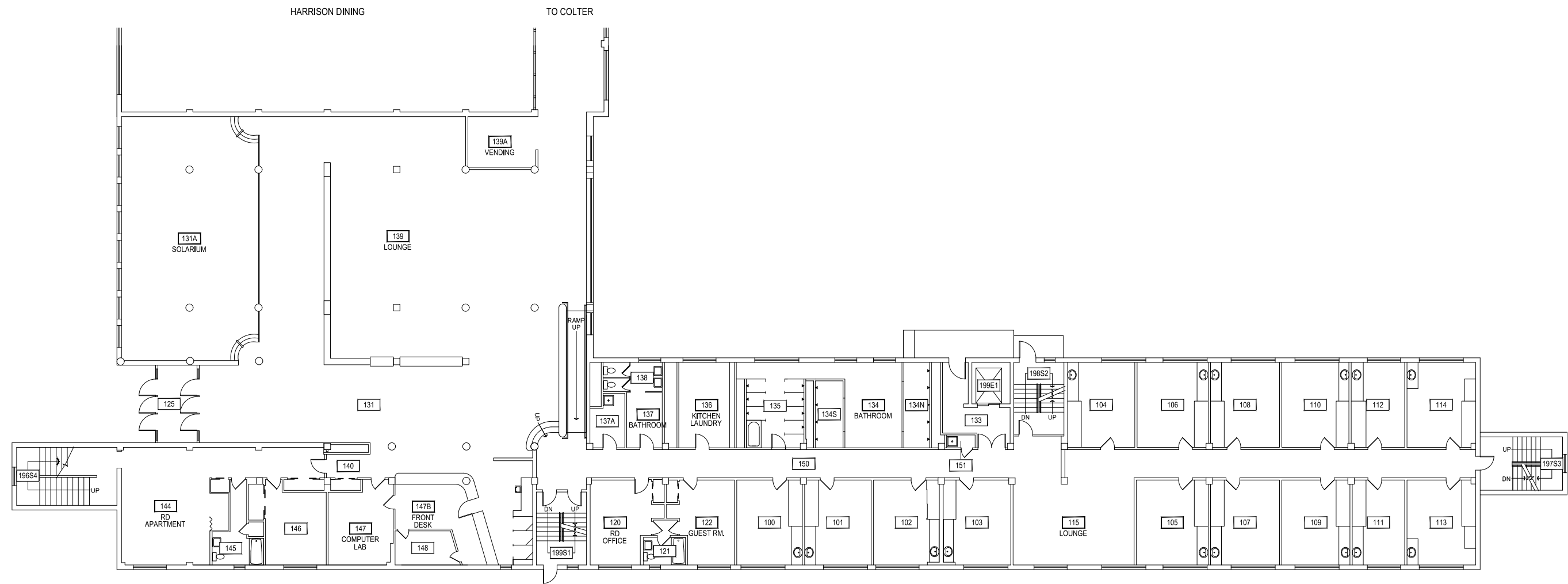

1 PRYOR HALL - FIRST LEVEL
SCALE: 1" = 20'



M MONTANA STATE UNIVERSITY
CAMPUS PLANNING,
DESIGN & CONSTRUCTION
BOZEMAN, MONTANA
PHONE: 406.994.5413 FAX: 406.994.5665

INDEX #
34
BUILDING #
330101

Mar 20, 2015 - 2:47pm - 330101_A2.dwg
H:\Johnstone Center (Lewis & Clark)\Pryor Hall\Building Plan - Book Copy\

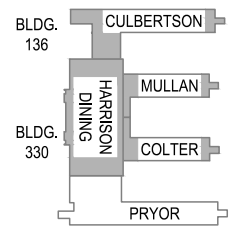
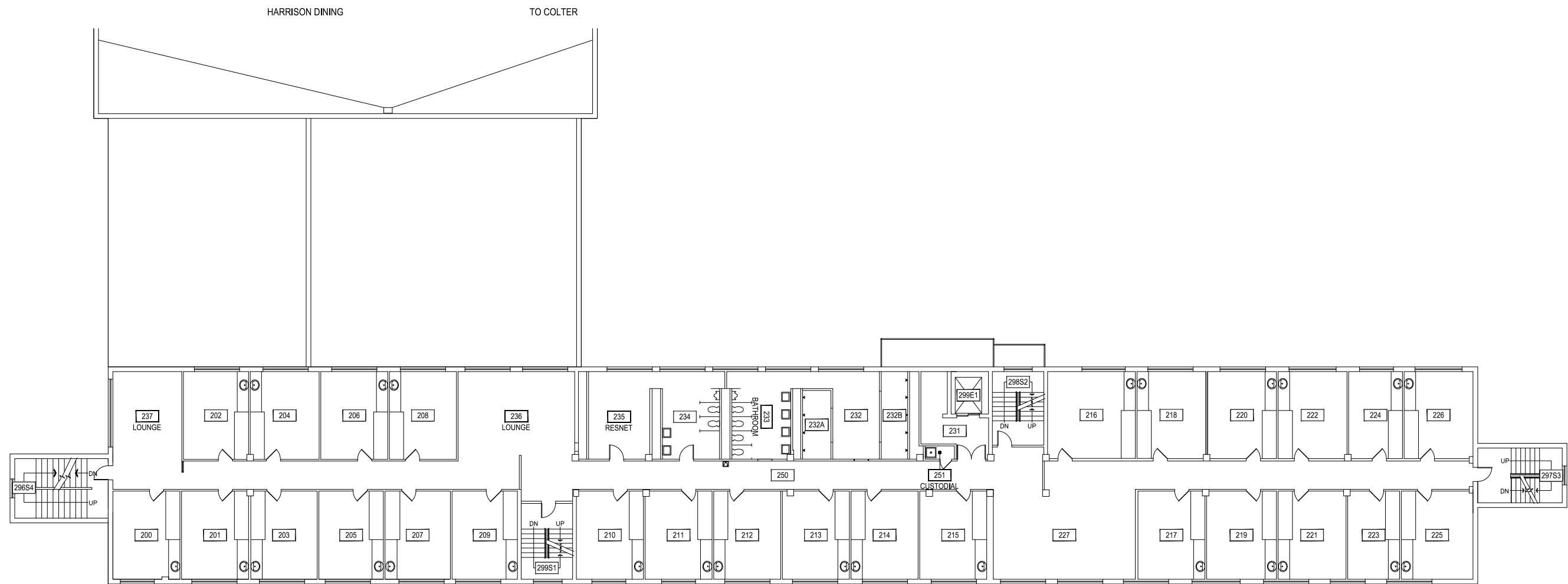

1 PRYOR HALL - SECOND LEVEL
SCALE: 1" = 20'

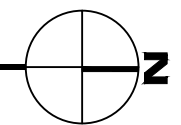

M MONTANA STATE UNIVERSITY
CAMPUS PLANNING,
DESIGN & CONSTRUCTION
BOZEMAN, MONTANA
PHONE: 406.994.5413 FAX: 406.994.5665

INDEX #
34
BUILDING #
330101

Mar 20, 2015 - 2:47 pm - 330101_A3.dwg
H:\Johnstone Center (Lewis & Clark)\Pryor Hall\Building Plan - Book Copy\

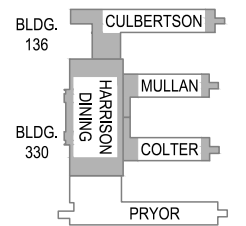
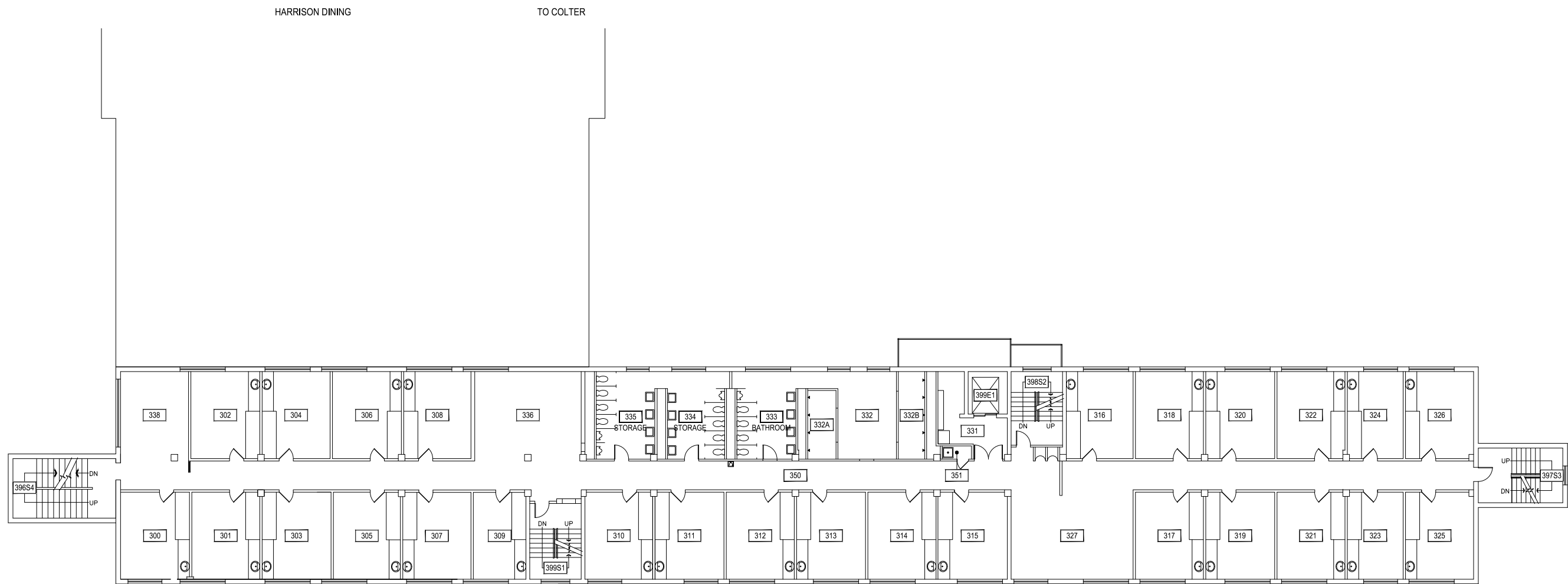

1 PRYOR HALL - THIRD LEVEL
SCALE: 1" = 20'



M MONTANA STATE UNIVERSITY
CAMPUS PLANNING,
DESIGN & CONSTRUCTION
BOZEMAN, MONTANA
PHONE: 406.994.5413 FAX: 406.994.5665

INDEX #
34
BUILDING #
330101

Mar 20, 2015 - 2:47pm - 330101_A4.dwg
H:\Johnstone Center (Lewis & Clark)\Pryor Hall\Building Plan - Book Copy\

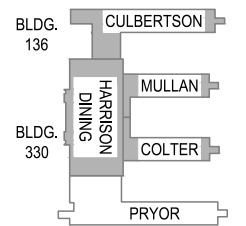
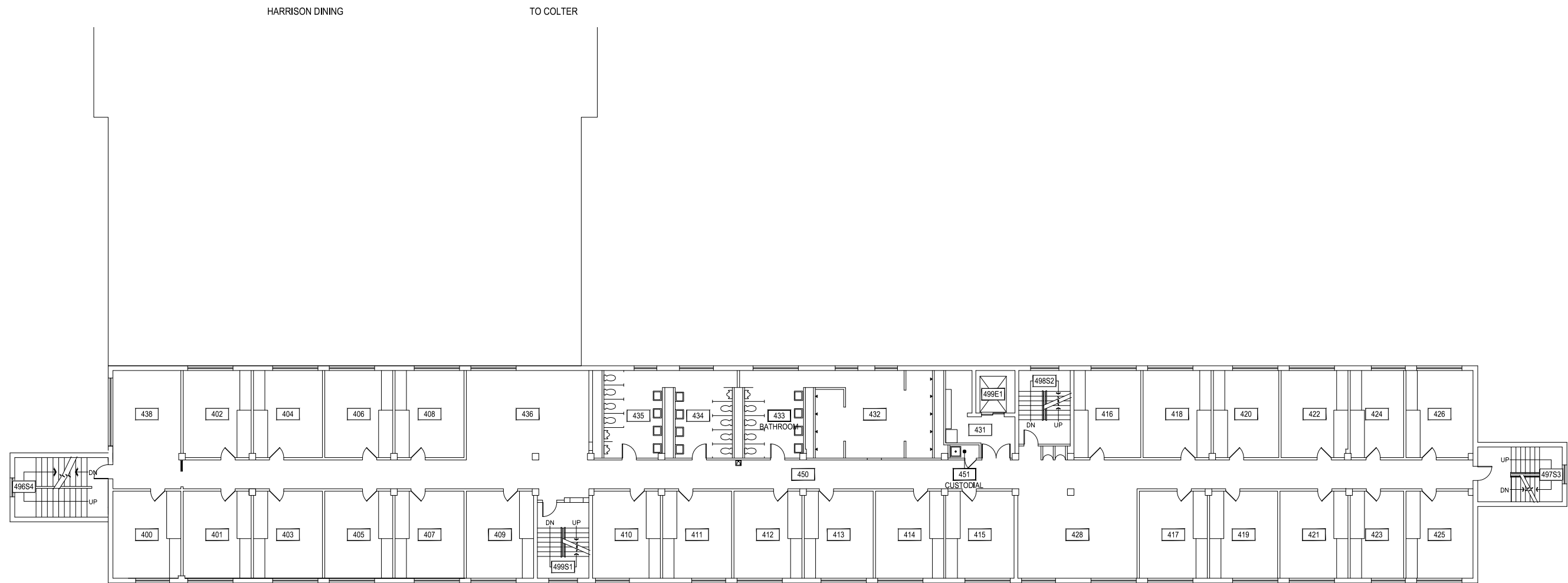

1 PRYOR HALL - FOURTH LEVEL
SCALE: 1" = 20'



M MONTANA STATE UNIVERSITY
CAMPUS PLANNING,
DESIGN & CONSTRUCTION
BOZEMAN, MONTANA
PHONE: 406.994.5413 FAX: 406.994.5665

INDEX #
34
BUILDING #
330101

Mar 20, 2015 - 2:47pm - 330101_AR.dwg
H:\Johnstone Center (Lewis & Clark)\Pryor Hall\Building Plan - Book Copy\

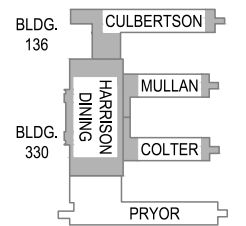
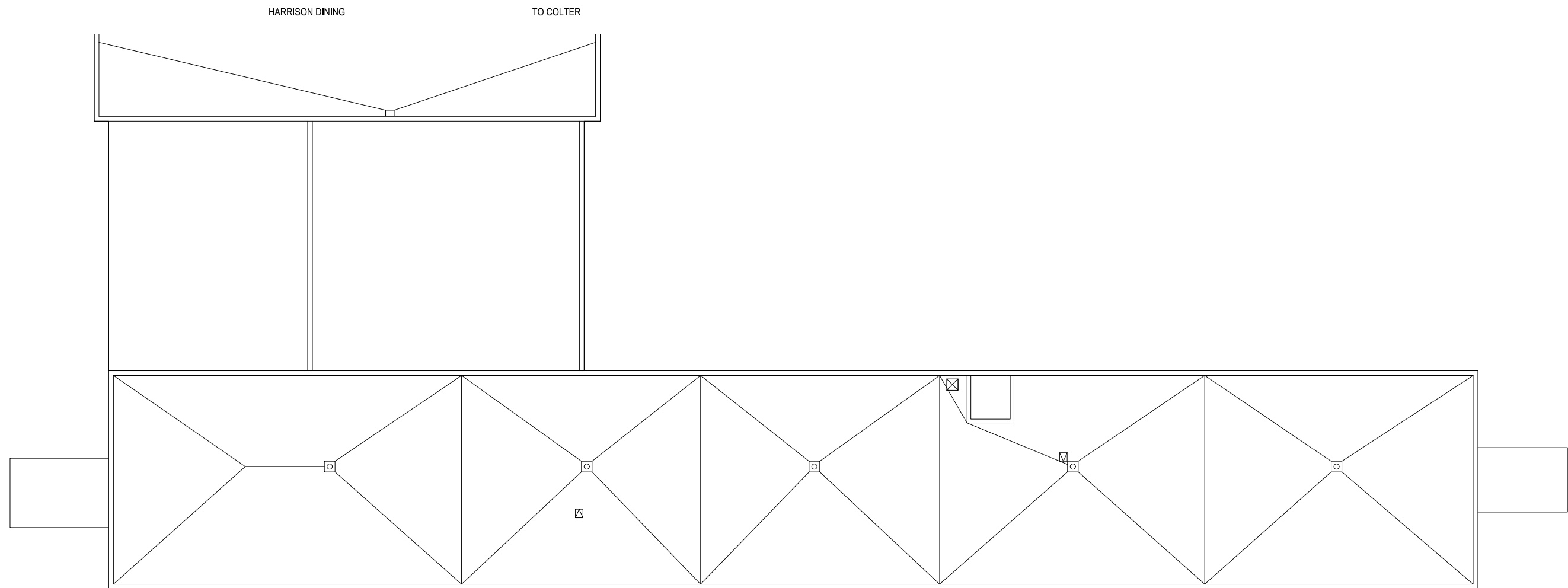

1 PRYOR HALL - ROOF LEVEL
SCALE: 1" = 20'

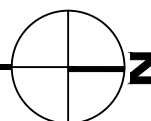

M MONTANA
STATE UNIVERSITY
CAMPUS PLANNING,
DESIGN & CONSTRUCTION
BOZEMAN, MONTANA
PHONE: 406.994.5413 FAX: 406.994.5665

INDEX #
34
BUILDING #
330101