

Dec 27, 2016 - 8:52am - 175101_A1.dwg
 H:\Bobcat Stadium\Building Plan - Book Copy\

1

BOBCAT STADIUM TRACK GRANDSTAND - FIRST LEVEL (SEATING)

SCALE: 1" = 15'

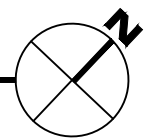

MONTANA
 STATE UNIVERSITY
 CAMPUS PLANNING,
 DESIGN & CONSTRUCTION
 BOZEMAN, MONTANA
 PHONE: 406.994.5413 FAX: 406.994.5665

INDEX #	66
BUILDING #	175101

Dec 27, 2016 - 8:52am - 175101_A2.dwg
H:\Bobcat Stadium\Building Plan - Book Copy\

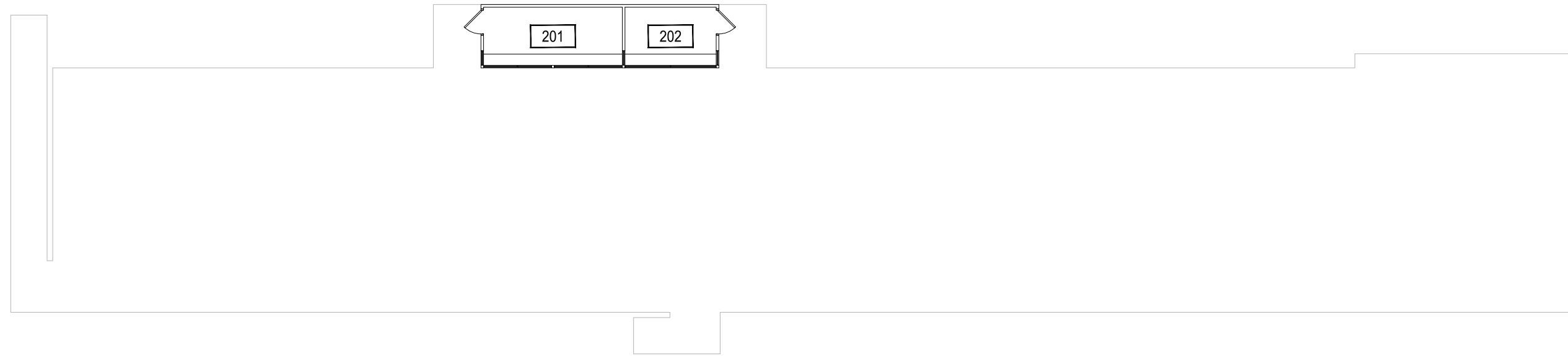

1

BOBCAT STADIUM TRACK GRANDSTAND - SECOND LEVEL (PRESS BOX)

SCALE: 1" = 15'

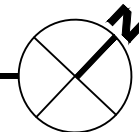

M MONTANA
STATE UNIVERSITY
CAMPUS PLANNING,
DESIGN & CONSTRUCTION
BOZEMAN, MONTANA
PHONE: 406.994.5413 FAX: 406.994.5665

INDEX #	66
BUILDING #	175101