

Jul 01, 2015 - 9:07am - 136_AB.dwg
H:\Johnstone Center (Lewis & Clark)\Culbertson Hall\Building Plan - Book Copy\

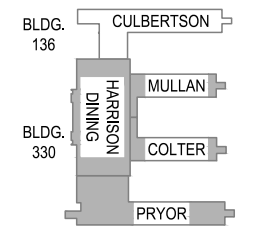

1 CULBERTSON HALL - BASEMENT LEVEL
SCALE: 1" = 20'

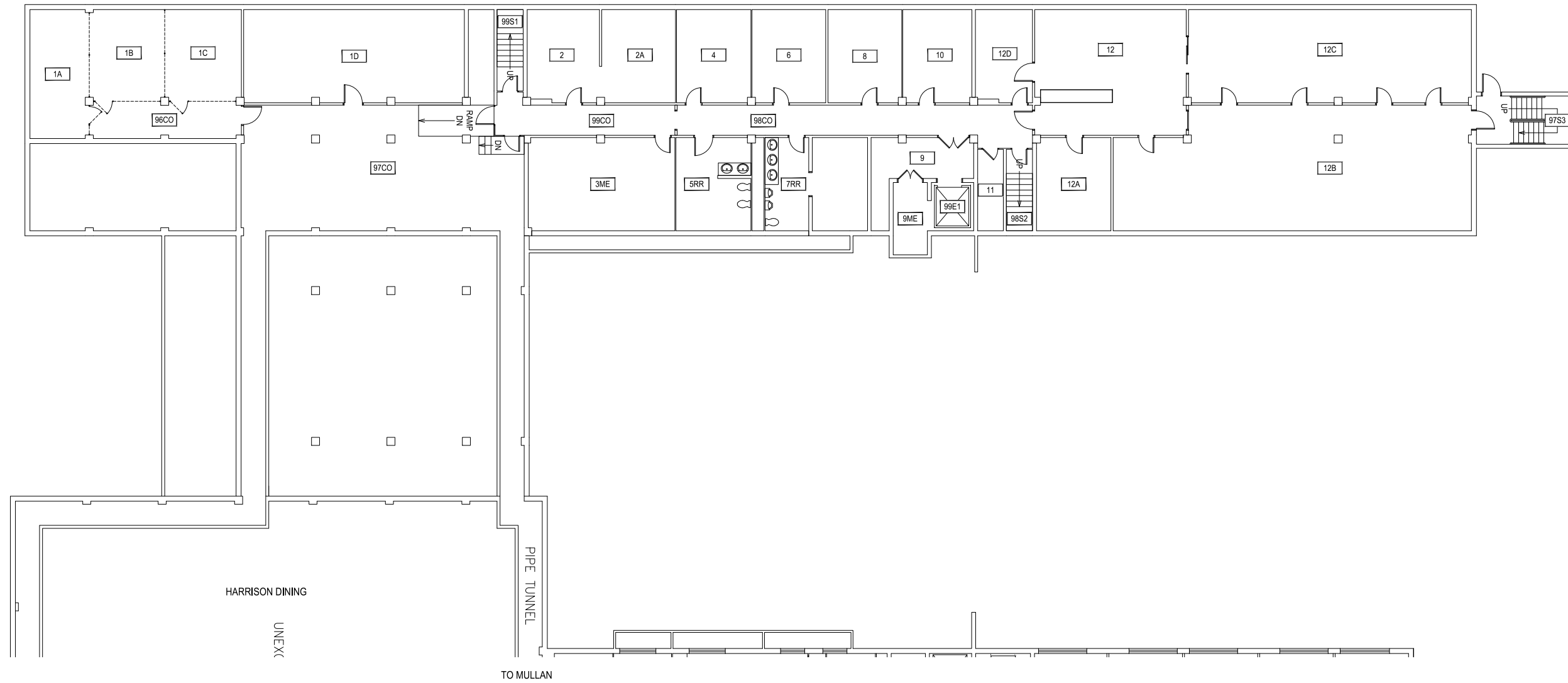
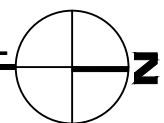

M MONTANA STATE UNIVERSITY
CAMPUS PLANNING,
DESIGN & CONSTRUCTION
BOZEMAN, MONTANA
PHONE: 406.994.5413 FAX: 406.994.5665

INDEX #
67
BUILDING #
136

Jul 01, 2015 - 9:07am - 136_A1.dwg
H:\Johnstone Center (Lewis & Clark)\Culbertson Hall\Building Plan - Book Copy\

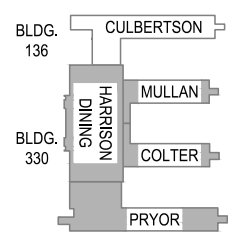
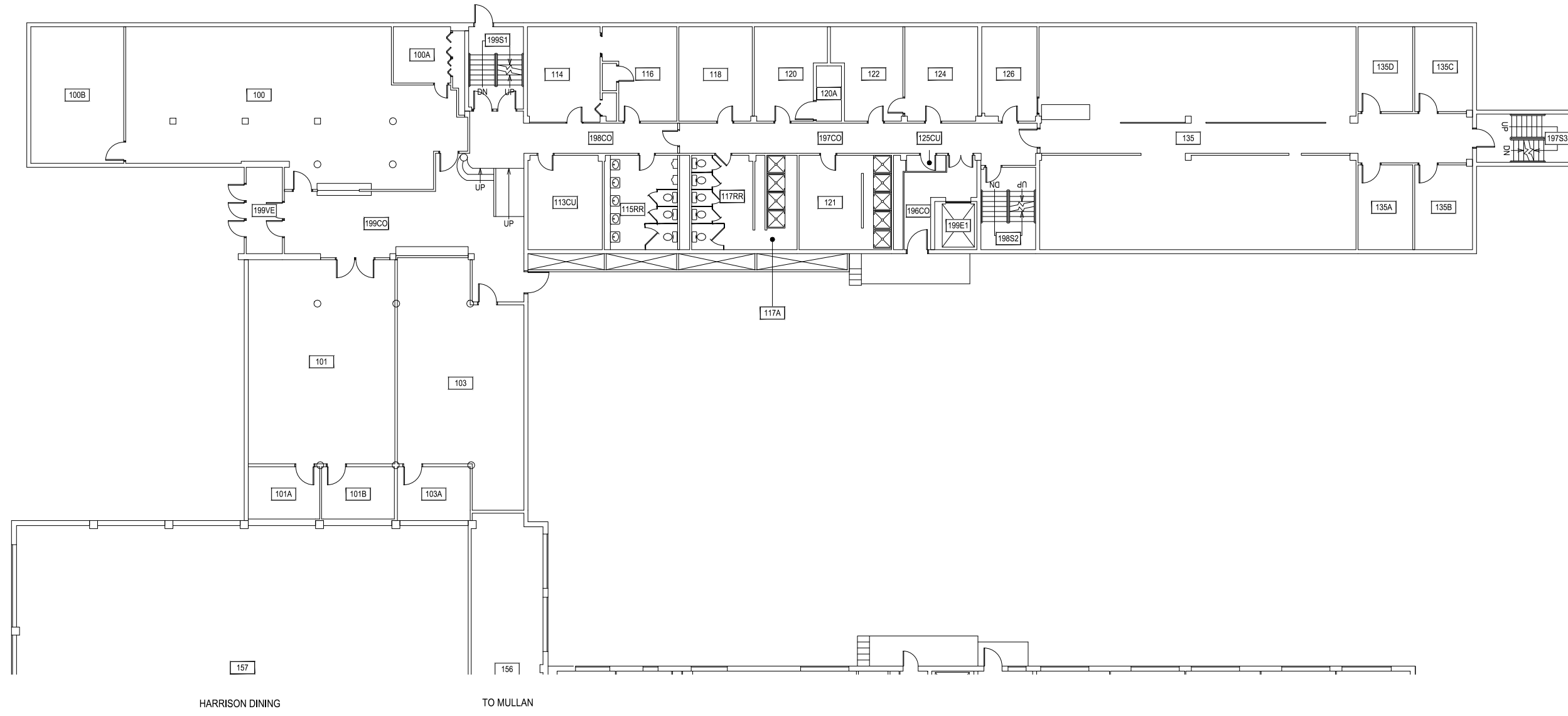

1 CULBERTSON HALL - FIRST LEVEL
SCALE: 1" = 20'



M MONTANA STATE UNIVERSITY
CAMPUS PLANNING,
DESIGN & CONSTRUCTION
BOZEMAN, MONTANA
PHONE: 406.994.5413 FAX: 406.994.5665

INDEX #
67
BUILDING #
136

Jul 01, 2015 - 9:07am - 136_A2.dwg
H:\Johnstone Center (Lewis & Clark)\Culbertson Hall\Building Plan - Book Copy\

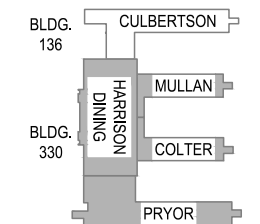
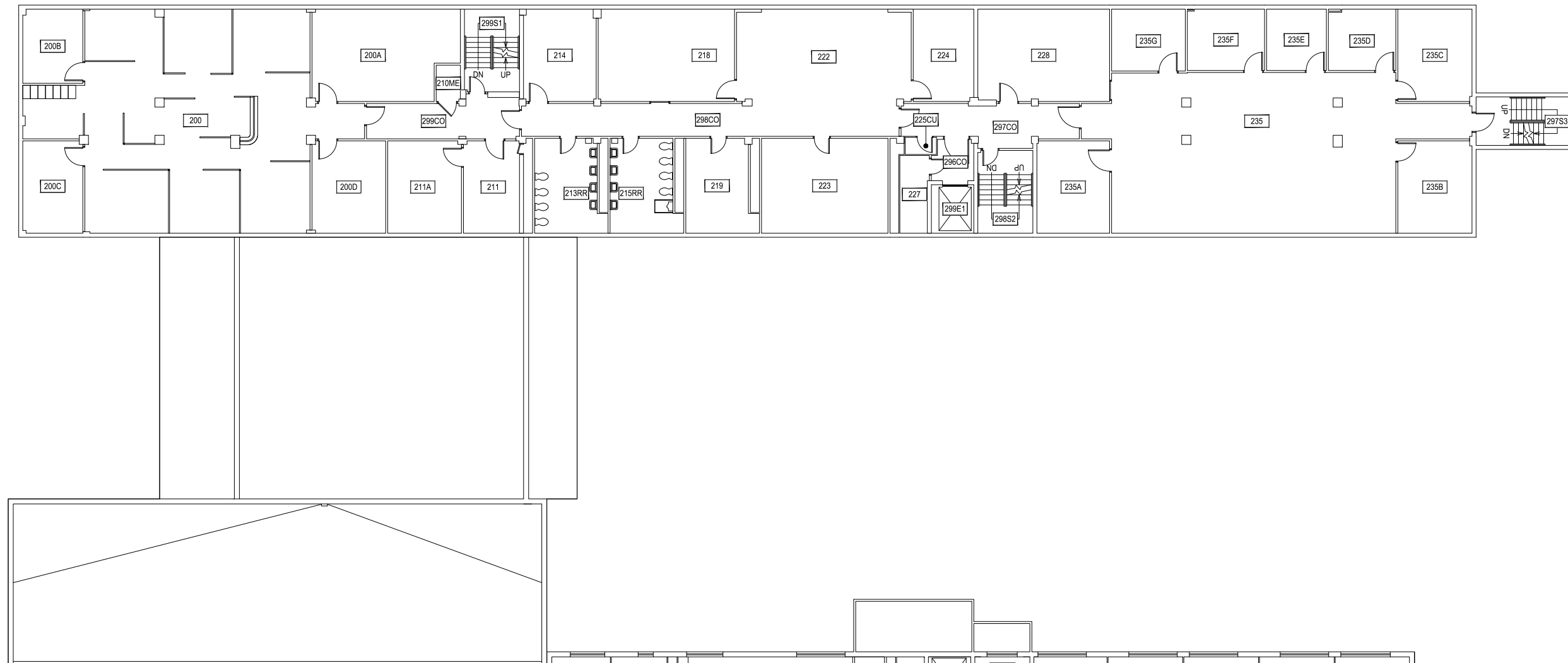

1 CULBERTSON HALL - SECOND LEVEL
SCALE: 1" = 20'

M MONTANA
STATE UNIVERSITY
CAMPUS PLANNING,
DESIGN & CONSTRUCTION
BOZEMAN, MONTANA
PHONE: 406.994.5413 FAX: 406.994.5665

INDEX #
67
BUILDING #
136

Jul 01, 2015 - 9:07am - 136_A3.dwg
H:\Johnstone Center (Lewis & Clark)\Culbertson Hall\Building Plan - Book Copy\

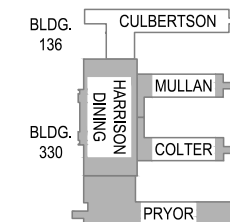
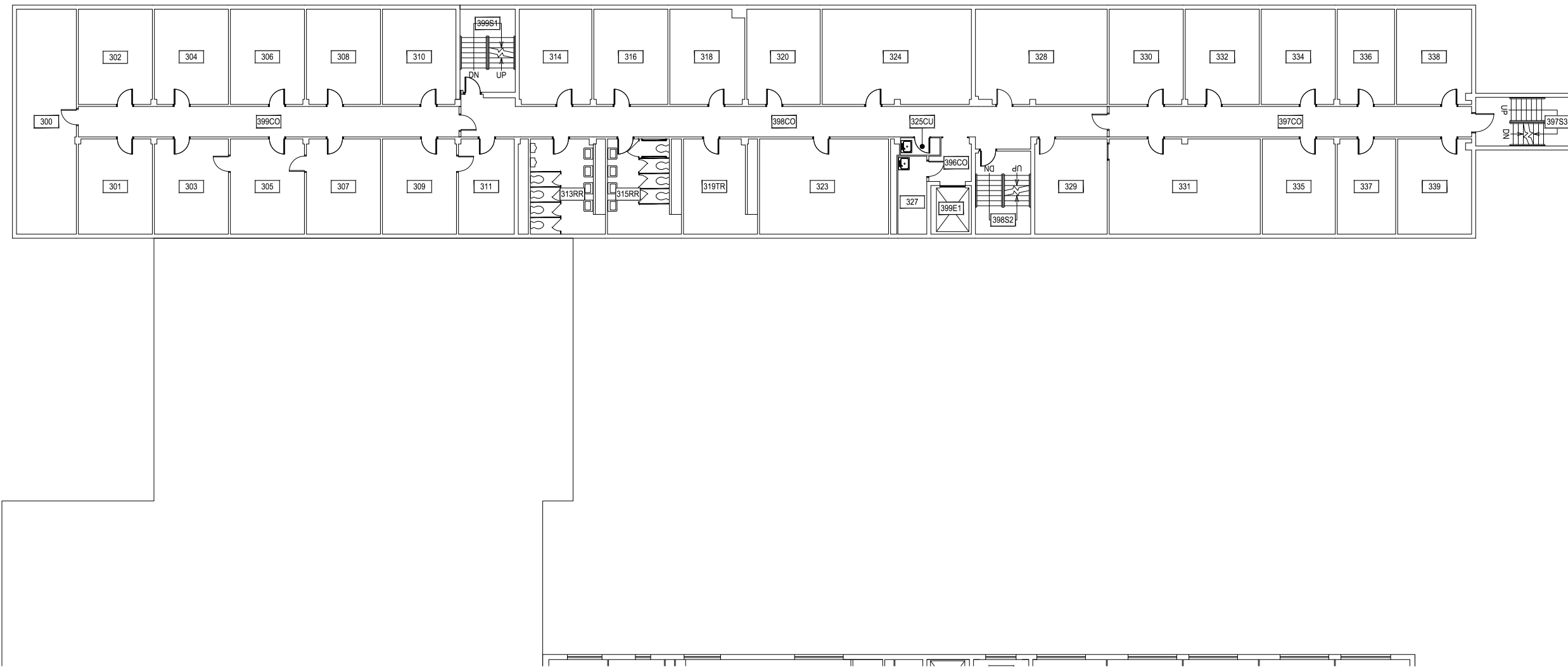

1 CULBERTSON HALL - THIRD LEVEL
SCALE: 1" = 20'

M MONTANA STATE UNIVERSITY
CAMPUS PLANNING,
DESIGN & CONSTRUCTION
BOZEMAN, MONTANA
PHONE: 406.994.5413 FAX: 406.994.5665

INDEX #
67
BUILDING #
136

Jul 01, 2015 - 9:07am - 136_A4.dwg
H:\Johnstone Center (Lewis & Clark)\Culbertson Hall\Building Plan - Book Copy\

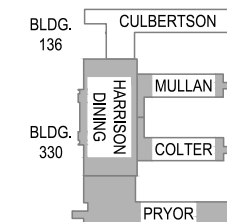

1 CULBERTSON HALL - FOURTH LEVEL
SCALE: 1" = 20'

M MONTANA STATE UNIVERSITY
CAMPUS PLANNING,
DESIGN & CONSTRUCTION
BOZEMAN, MONTANA
PHONE: 406.994.5413 FAX: 406.994.5665

INDEX #
67
BUILDING #
136

Jul 01, 2015 - 9:07am - 136_AR.dwg
H:\Johnstone Center (Lewis & Clark)\Culbertson Hall\Building Plan - Book Copy\

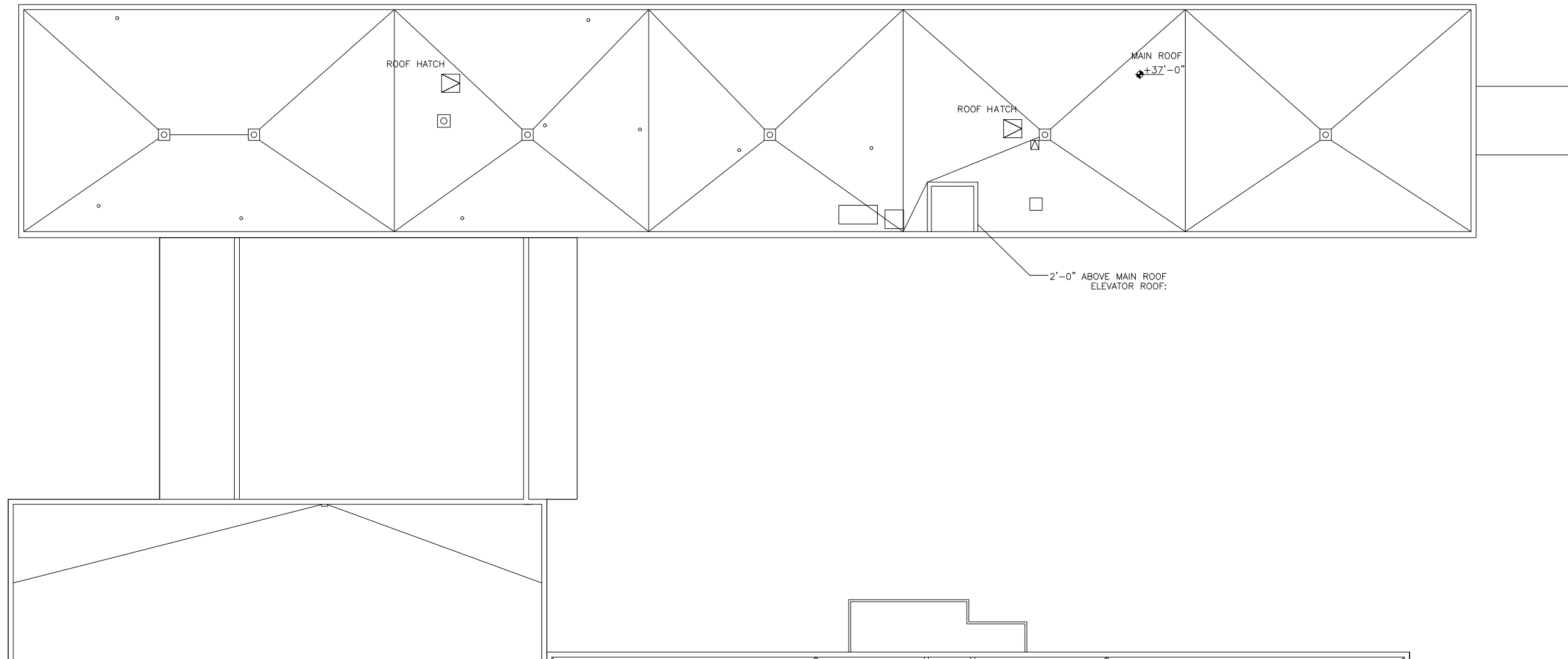

1

CULBERTSON HALL - ROOF LEVEL

SCALE: 1" = 20'

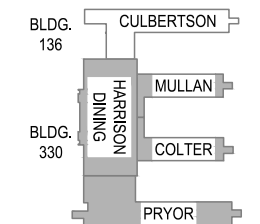
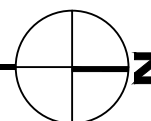

M MONTANA
STATE UNIVERSITY
CAMPUS PLANNING,
DESIGN & CONSTRUCTION
BOZEMAN, MONTANA
PHONE: 406.994.5413 FAX: 406.994.5665

INDEX #
67
BUILDING #
136