

Apr 08, 2015 - 11:05am - 11c_A1.dwg
C:\Users\gary.gramer\appdata\local\temp\AcPublish_7520

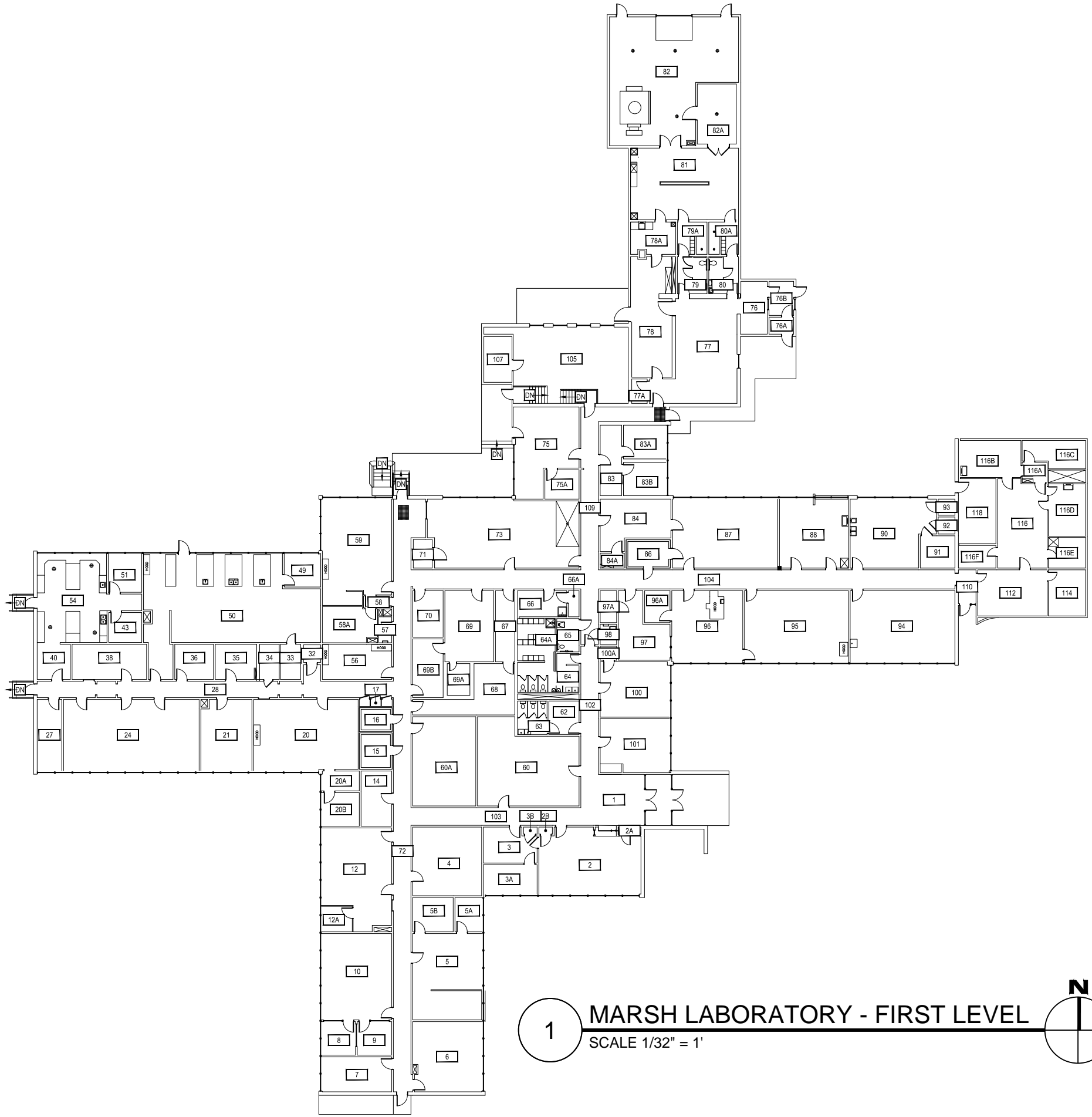

1

MARSH LABORATORY - FIRST LEVEL

SCALE 1/32" = 1'



M MONTANA
STATE UNIVERSITY
CAMPUS PLANNING,
DESIGN & CONSTRUCTION
BOZEMAN, MONTANA
PHONE: 406.994.5413 FAX: 406.994.5665

INDEX #
2
BUILDING #
116

Apr 08, 2015 - 11:05am - 11c_AR.dwg
H:\Marsh Laboratory\Marsh Laboratory\Building Plan - Book Copy\

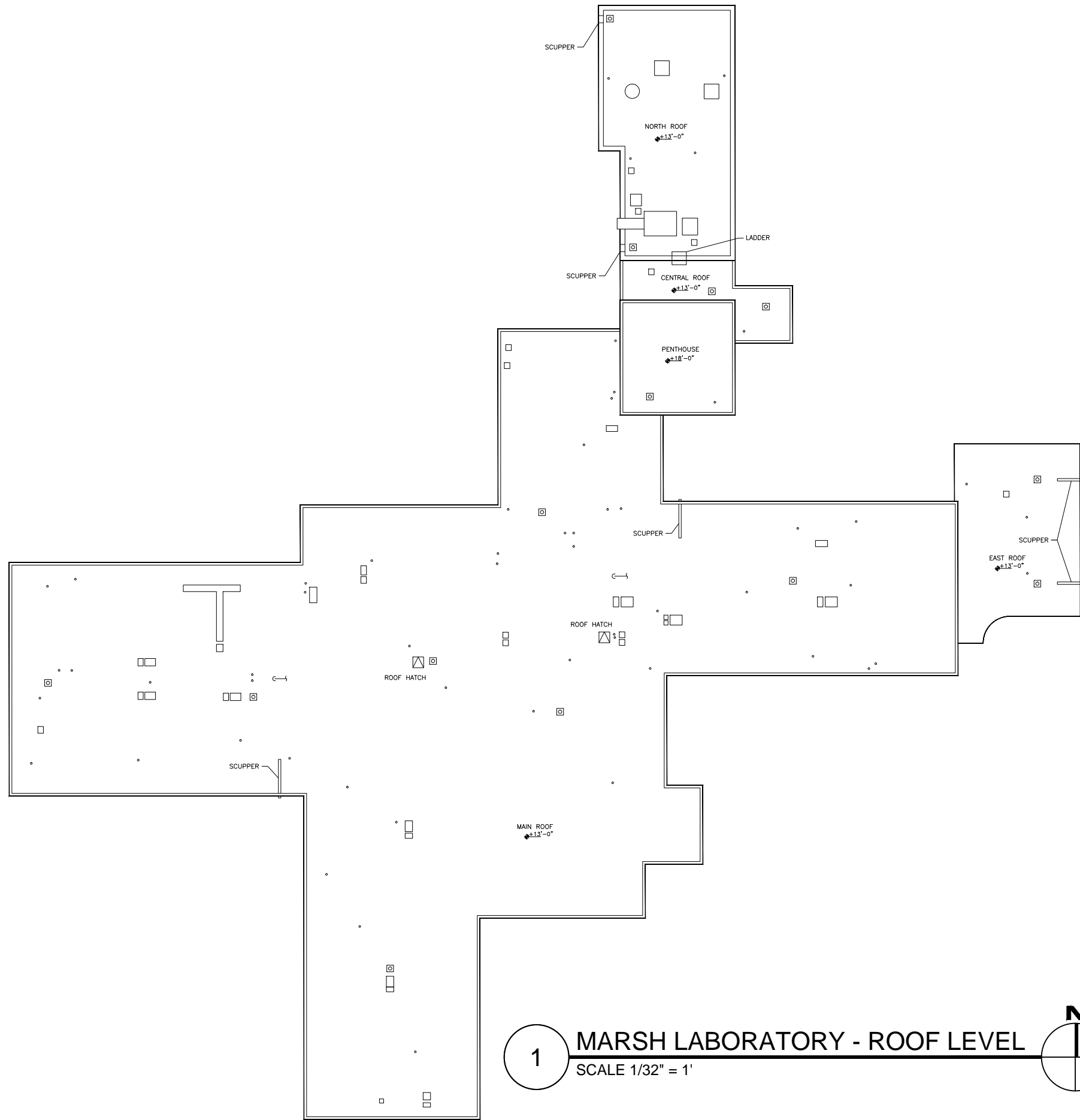

1

MARSH LABORATORY - ROOF LEVEL

SCALE 1/32" = 1'



M MONTANA
STATE UNIVERSITY
CAMPUS PLANNING,
DESIGN & CONSTRUCTION
BOZEMAN, MONTANA
PHONE: 406.994.5413 FAX: 406.994.5665

INDEX #	2
BUILDING #	116