

## MEMORANDUM

TO: University Facilities Planning Board: Kregg Aytes - Chair, Walt Banziger - Vice Chair, Kurt Blunck, Allyson Brekke, Jeff Butler, ASMSU President, Michael Everts, Chris Fastnow, Greg Gilpin, Brett Gunnink, Neil Jorgensen, Kyle Glose – ASMSU, Terry Leist, Chris Kearns, Martha Potvin, Fatih Rifki, Tom Stump, Julie Tatarka, Jim Thull, Brenda York

FROM: Victoria Drummond, Assoc. University Planner; Campus Planning, Design & Construction

RE: **May 31, 2016**, meeting of the University Facilities Planning Board to be held in the **Facilities Meeting Quonset** at **3:30 pm**

### **ITEM No. 1 – APPROVAL OF NOTES**

Approval of the draft notes from April 19, 2016. Draft notes from March 8, 2016 and April 5, 2016 to be distributed before next meeting.

### **ITEM No. 2 – EXECUTIVE COMMITTEE REPORT**

Report on any current Executive Committee actions.

### **ITEM No. 3 – CONSENT AGENDA** – No Items

### **ITEM No. 4 – RECOMMENDATION** - **PAC Recommendation of School of Architecture Sculpture** **Presenter – Victoria Drummond**

### **ITEM No. 5 – INFORMATIONAL** - **Update on Chemistry Modular Buildings** – information to be presented at meeting **Presenter – Walt Banziger**

### **HORIZON ITEMS**

- **Interior Public Spaces Signage**
- **Turf Fields Facility Concept**
- **Renne Library Spaces & Technology Renovation**
- **External Building Signage Policy**
- **Seminar Materials**
- **Master Planning Issues**
- **Revisit and Update Policies**

CM/l sb

PC:

President Cruzado  
Amber Vestal, President's Office  
Maggie Hammett, President's Office  
Julie Heard, Provost Office  
ASMSU President  
Pam Schulz, VP Admin & Finance

Heidi Gagnon, VP Admin & Finance  
Jennifer Joyce, VP Student Success  
Linda LaCrone, VP Research Office  
Tony Campeau, Registrar  
Robert Putzke, MSU Police  
Becky McMillan, Auxiliaries Services

Julie Kipfer, Communications  
Jody Barney, College of Agriculture  
Susan Fraser, College of Agriculture  
Robin Happel, College of Agriculture  
Halina Rickman, College of Business  
Victoria Drummond, Campus Planning

**MEETING NOTES OF THE  
UNIVERSITY FACILITIES PLANNING BOARD  
April 19, 2016**

**Members Present:** Kregg Aytes – Chair, Walt Banziger – Co-Chair, Jeff Butler, Neil Jorgensen, Chris Fastnow, Fatih Rifki, James Thull, Brenda York

**Proxy:**

**Members Absent:** Charles Boyer, Chris Kearns, Allyson Brekke, Kathy Marcinko, David Singel, Tom Stump, Julie Tatarka, Kyle Glose, Michael Everts, Kurt Blunck, Bob Lashaway

**Staff & Guests:** Randy Stephens, Candace Mastel, Logun Norris, Kristin Blackler

The University Facilities Planning Board met at the Facilities Meeting Quonset beginning at 3:30 pm to discuss the following:

**ITEM No. 1 – Approval of Meeting Notes**

Draft notes from March 8, 2016, and April 5, 2016 to be distributed before next meeting.

**ITEM No. 2 – Executive Committee Report**

Report on any current Executive Committee actions.

**ITEM No. 3 – CONSENT AGENDA**

**a. Outdoor Recycling Program**

Logun Norris, Recycling Coordinator, presented the proposal to convert some of the current Victor Stanley trash receptacles on Campus to recycling bins. The proposal is adding a cost effective band and lid to the receptacles, labeling it for plastic bottle or aluminum can recycling. This is less expensive than purchasing new receptacles and it is not expected to see an increase in disposed materials. The committee had no objections to the proposal.

Rifki commented that some buildings have larger amount of recycling at certain times of the year. In the case of Cheever Hall, there is a large amount of cardboard disposed of at the end of the semesters. Norris responded that the recycling program tries to address this by increasing frequency of pickups, and by providing roll out containers.

**ITEM No. 4 – RECOMMENDATION - Jabs Hall Bracken Business Communications Clinic Signage**

Randy Stephens presented the proposal for additional signage on the glass wall of the Bracken Business Communications Clinic, facing the atrium of Jabs Hall. The proposal is to add opacity to the glass to provide more visual privacy to students using the clinic and encourage students to use the service. The design is consistent with other spaces in Jabs Hall, such as the instructional spaces, and includes text to help brand the space for the Clinic and provide inspiration for the students.

Rifki suggested that the original architect for Jabs Hall be consulted in this design; Aytes responded that the original intent was for the space to be transparent, but the feedback students have given since opening the building is that they want more privacy. Fastnow commented that the word “outline” did not seem as inspirational as the other words shown and suggested using more of the key words from the MSU Strategic Plan.

York moved to approve the proposal as presented. Banziger seconded the motion. The motion passed unanimously.

The vote:

Yes: 8

No: 0

**ITEM No. 5 – INFORMATIONAL - Wall Wraps**

Candace Mastel began a discussion with UFPB regarding recent requests for wall wraps in academic buildings. In 2010, a policy was developed to address the use of banners or similar wall hangings; this policy can be found on the

MSU Policies and Procedures website in the Free Speech Policy ([www.montana.edu/policy/free\\_speech](http://www.montana.edu/policy/free_speech)). Auxiliaries' buildings, such as Residence Halls, Dining Halls, and Athletics Facilities have some existing wall wraps, and these interior Auxiliaries' spaces are not under the purview of UFPB. CPDC is interested in getting input from UFPB on how requests in academic buildings should be addressed. Recent requests include the Reid TRIO space, the seventh floor of Leon Johnson, and the hallway connecting Barnard Hall and Cobleigh Hall.

Butler noted that the wall wraps are kind to the facilities and do not typically cause damage. Stephens confirmed that the wall wraps produced by local company SCS Wraps have a Class A Flame Spread rating. The Board discussed beginning to create guidelines for design and installation of wall wraps. These could be used in the MSU Design Guidelines and requests for wall wraps would be reviewed by UFPB on case by case basis. CPDC will begin developing these guidelines and bring them back to UFPB at a later date.

This meeting was adjourned at 4:15p.m.

CM:lsb

PC:

President Cruzado	Heidi Gagnon, VP Admin & Finance	Julie Kipfer, Communications
Amber Vestal, President's Office	Jennifer Joyce, VP Student Success	Jody Barney, College of Agriculture
Maggie Hammett, President's Office	Linda LaCrone, VP Research Office	Susan Fraser, College of Agriculture
Julie Heard, Provost's Office	Tony Campeau, Registrar	Robin Happel, College of Agriculture
ASMSU President	Robert Putzke, MSU Police	JoDee Palin, College of Arts & Arch
Pam Schulz, VP Admin & Finance	Becky McMillan, Auxiliaries Services	Victoria Drummond, Campus PDC

<b>ITEM # 4</b>	<b>Zahner/School of Art Sculpture Proposal</b>
-----------------	--

**PRESENTERS:**

Victoria Drummond, Associate University Planner / Public Art Committee Co-Chair

<b>PROJECT PHASE:</b>	<b>PLANNING</b>	<b>SCHEMATIC</b>	<b>X</b>	<b>DESIGN DOCUMENTS</b>	<b>CONSTRUCTION DOCUMENTS</b>
-----------------------	-----------------	------------------	----------	-------------------------	-------------------------------

**VICINITY MAP:**

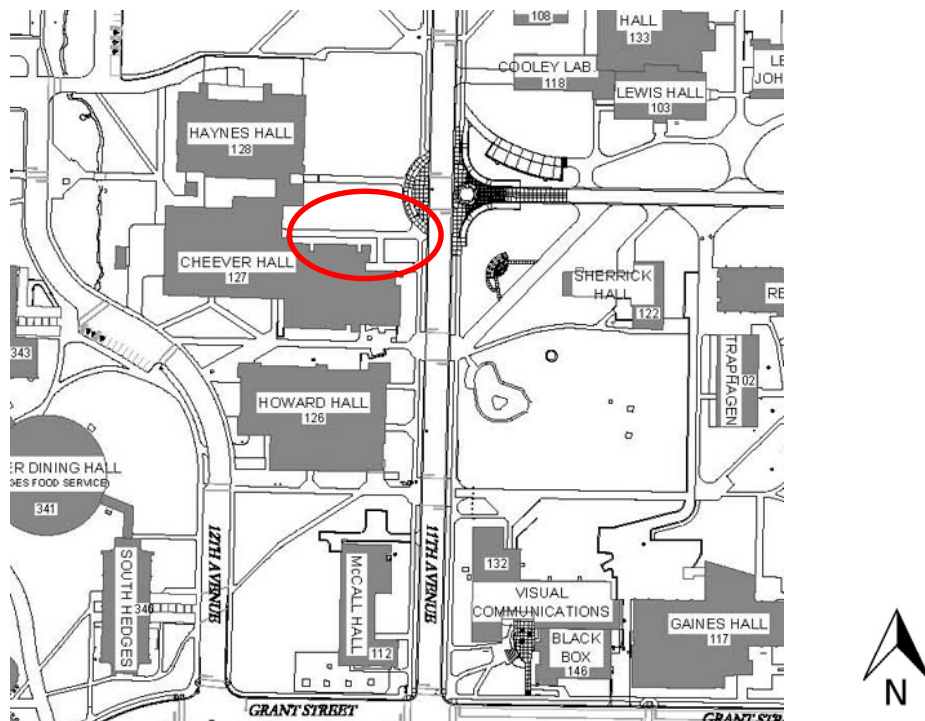

**STAFF COMMENTS:**

The UFPB Public Art Committee received a proposal for the School of Art, College of Arts and Architecture. See attachment.

The sculpture gift will be the culmination of an academic collaboration between the School of Art and A. Zahner Company including a graduate level credit art course (Fall 2016) and a book by faculty Professor John Brittingham, in which he will document the process with the world famous artist and metal fabricator from concept to installation of the final art piece on the MSU Bozeman campus, Creative Arts Complex neighborhood.

Sculpture Specifications:

**Title:** Solar Blades

**Material:** Stainless steel – parts will include surface texture, polishing, and engraving

**Blades:**

-24 individual blades

-each weighs approximately 250 pounds

-each approximately 15 feet in height, 18 inches in depth, and width of the split blades varies

**Length of Sculpture:** 50 feet - blades arranged in a row within a stainless steel base filled with gravel

**Lighting:** To create a 24-hour experience and to mimic/continue the reflective properties and create shadows at night similar to sunlight, the proposal includes a request for LED lights. The team needs to investigate the lighting, but at this time the idea is to embed a small LED light in or below each blade and focused upward to cast light on the blade to create shadows and optical designs.

The individual blades will be arranged in a row that parallels to the sidewalk of the entrance to Cheever Hall. The sculpture provides a sense of arrival to the College of Arts and Architecture's main building entrance and the place known as the Creative Arts Complex.

Reviews:

May 20, 2016 the PAC reviewed the unique opportunity for MSU and the resulting significant art sculpture gift to MSU. They voted unanimously in support of recommending the project for approval with conditions.

May 24, 2016, Facilities Services, CPDC and UFPB Chair reviewed the project at the Pre UFPB review of Agenda items. The consensus was support for the project with the conditions.

At both reviews, the following issues were identified that will need further investigation and possibly additional UFPB review:

1. **Siting the sculpture:** According to the Public Art Policy, an art gift does not include a specified site for its installation. This proposal does include a site. The PAC and Pre UFPB reviews support the general vicinity as proposed. However, it will be very close to the Arc Flight (aka Snow Plow) by Jeff Boshart that has been on the campus since 1978 and relocated to its current location in 2014 to create a site for The Lift Tower Project sculpture. If the Arc Flight is relocated – then PAC/UFPB would need to review potential relocation sites, the cost and funding for the relocation.



2. **Lighting:** The project team/students will evaluate the lighting component since most of the university's public art does not include lighting. LED is preferred for energy efficiency and bulb longevity. With upward oriented lighting, the potential impacts to the night-sky need to be reviewed by MSU Faculty, Joe Shaw for design mitigation and prevention of unintended consequence of lighting the sculpture. And Facilities Services needs to evaluate the proposed removal of two existing light poles.



3. **Snow removal:** Currently snow removed from the vicinity is moved via the sidewalk perpendicular to the sculpture's proposed location. FS Environmental Services Manager needs to evaluate impacts and possibly change some snow removal routes. If the proposed location of the ~50ft long sculpture is moved further west of the intersecting sidewalk, then it would be into the trees and shadows of Cheever Hall.



4. **Protection:** The project team/students need to evaluate including a concrete curb around the stainless steel base of the sculpture to prevent damage from snow removal and lawn moving equipment. In addition to the curb - consider paving the ~2ft perimeter of the sculpture base to create a separation from turf, irrigation sprinklers, and walkways.
5. **Safety:** The project team/students must provide installation drawings and specifications approved by a structural engineer to be used for the installation.
6. **Rock Infill:** The project team/students need to resolve how the gravel infilled base of the sculpture will be contained in the base – and not picked out.
7. **Facilities Services/CPDC Coordination:** As part of the installation and planning for future maintenance of the sculpture, the project team/students need to coordinate with FS/CPDC regarding site preparation including relocation of utilities; sculpture installation including schedule and contractor coordination; and specifications for ongoing maintenance needs.

**PAC’s and Pre-UFPB Facilities Services’ recommendation CONDITIONS:**

Condition 1. The public art gift to MSU includes funds to cover all installation expenses (could be +/- \$30,000 and FS/CPDC must supervise all campus construction done by FS or contractors).

Condition 2. Approval by Facilities Services/CPDC and coordination of installation, including participation with project team/students to inform evolving design changes affecting the dimensions of the sculpture, utilities, site improvements, and location.

Condition 3. Installation drawings approved by a structural engineer (expense included in Condition 1) and timely in the process in order to meet the team’s installation schedule.

Photos by Gary Gramer, CPDC

<b>COMPLIANCE:</b>	<b>YES</b>	<b>NO</b>
<b>MSU POLICIES</b>	<b>X</b>	
<b>COMMITTEE OR APPROPRIATE REVIEW</b>	<b>X</b>	
<b>MASTER PLAN/DESIGN GUIDELINES</b>	<b>X</b>	
<b>BOARD ACTION REQUIRED:</b>		
<b>Motion to recommend approval of the Zahner sculpture gift to MSU as proposed including conditions.</b>		



# SCHOOL OF ARCHITECTURE + A. ZAHNER COMPANY COLLABORATIVE DESIGN PROJECT

## Description

This art piece is sponsored by A. Zahner Company and will be fabricated in stainless steel. Due to a grade change, the design aspiration to hide the structural connection between the piece and its pier foundations, and maintain a co-planar relationship of all components, the piece will emerge from a stainless steel planter that is filled with crushed, recycled, milky glass or rock.

Steel, as a material, can often appear as heavy and thick. This design showcases the thin, delicate, and fluid language inherent in the capacity of the material itself. The act of splitting and twisting two steel plates elegantly creates fluid volumes that can be experienced from multiple vantage points.

The design titled "Solar Blades" consists of twenty-four, solar steel blades representing the twenty-four hours in a day. Each blade twists to reflect the sun's azimuth angle at a specific hour of the day. As the sun moves across the sky, specific blades will glow with light comparing actual solar time to artificial scheduled time. Several of the blades will have LED lighting integrated in them and will provide lighting during the night not only to reinforce the concept of the art piece but to also provide safety on campus.

The twenty-four individual blades are all 15 feet in height, 18 inches in depth, and vary in width depending on the curvature of the individual blade (see diagrams). The siting of the art piece is located running east west along the north sidewalk of Cheever Hall's front entrance. It spans a length of approximately fifty feet. This specific siting establishes, and defines, a transitional space that is sorely needed by Cheever (home of the Dean's Office of the College of Arts and Architecture) with its close proximity to the heavily traveled 11th Avenue and the MSU Mall. The establishment of a transitional courtyard in front of Cheever will be augmented with additional landscaping.



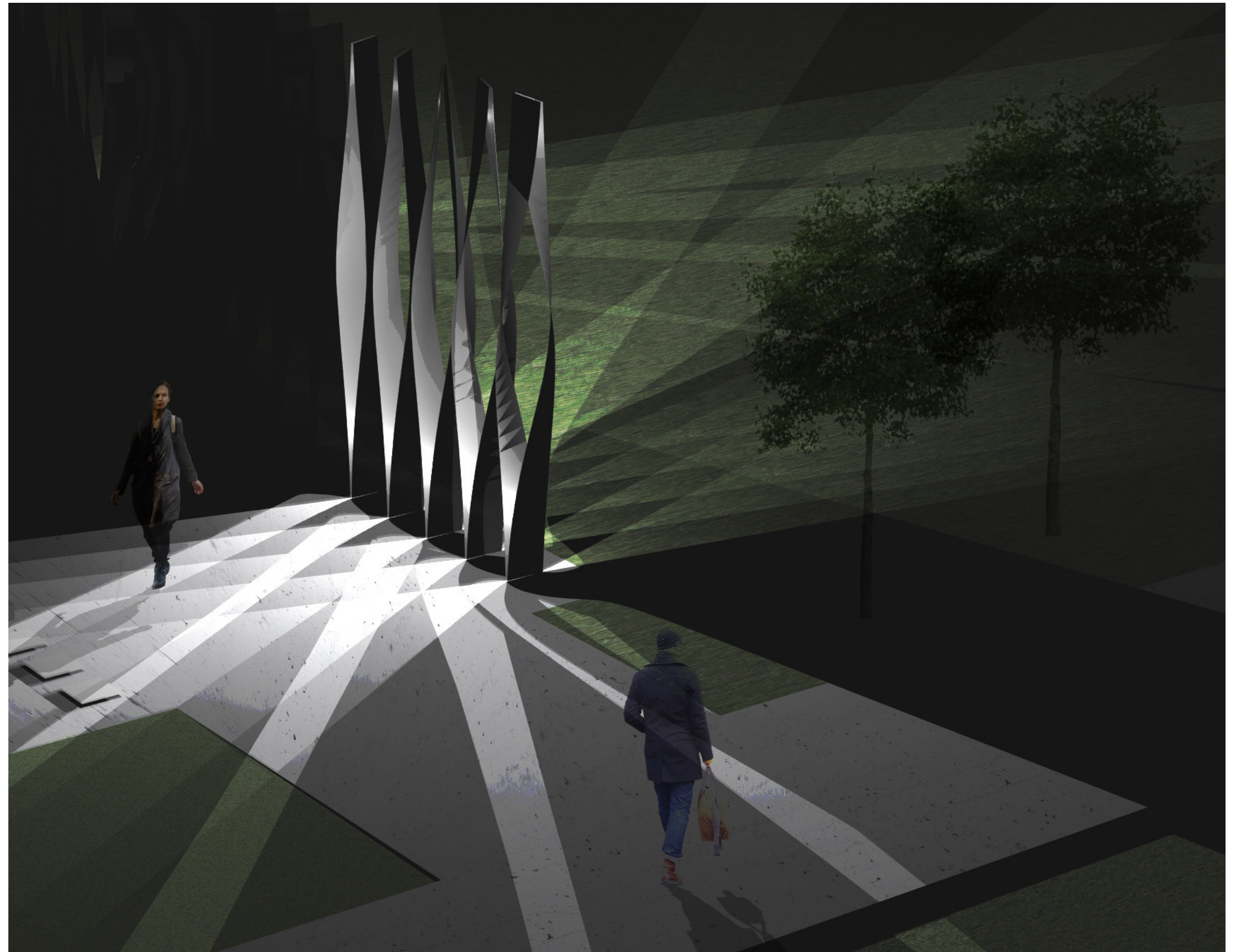

**Shadow Study**

Summer Solstice - June 21

Winter Solstice - December 21

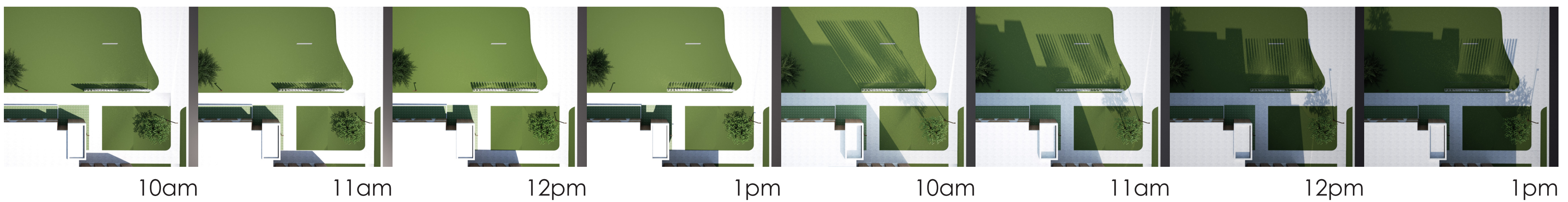

**Diagram of Individual Blades**

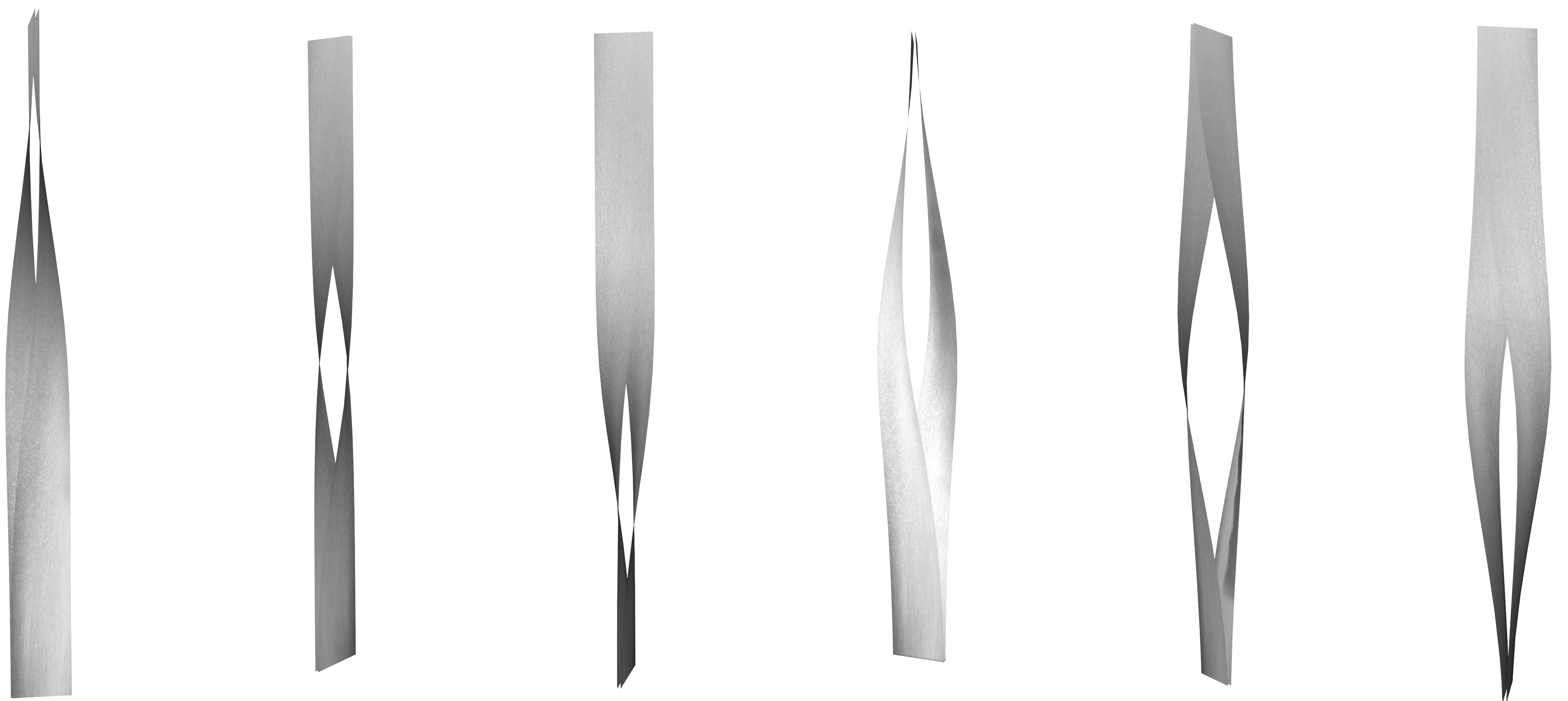

Narrow Twist.....Wide Twist